



*Jordan fishwick*

23 Croft Park Newton Hall Lane, WA16 7LN  
Guide Price £180,000



## Newton Hall Lane Mobberley

Guide Price £180,000



Take a look into this beautifully presented (Over 50's) Park Home situated in a semi-rural and highly sought after location. Internally the home comprises of two excellent sized bedrooms, generous living room space and a three-piece suite shower room. The kitchen diner is an attractive and spacious area, with matching wall and base mounted units nicely complimented by an oak inspired worktop. Integrated appliances include, fridge freezer, washing machine, oven, gas hob and worktop integrated stainless steel sink with drainer. Externally the home benefits from idyllic views over a pleasant pond and a private fenced patio space which provides a great social spot. Off road parking also provided. Viewings essential.



- Two Bedrooms
- Modern Kitchen Diner
- Park Home
- Over 50's
- Off-Road Parking
- Semi Rural Location
- Attractive external space



# GROUND FLOOR

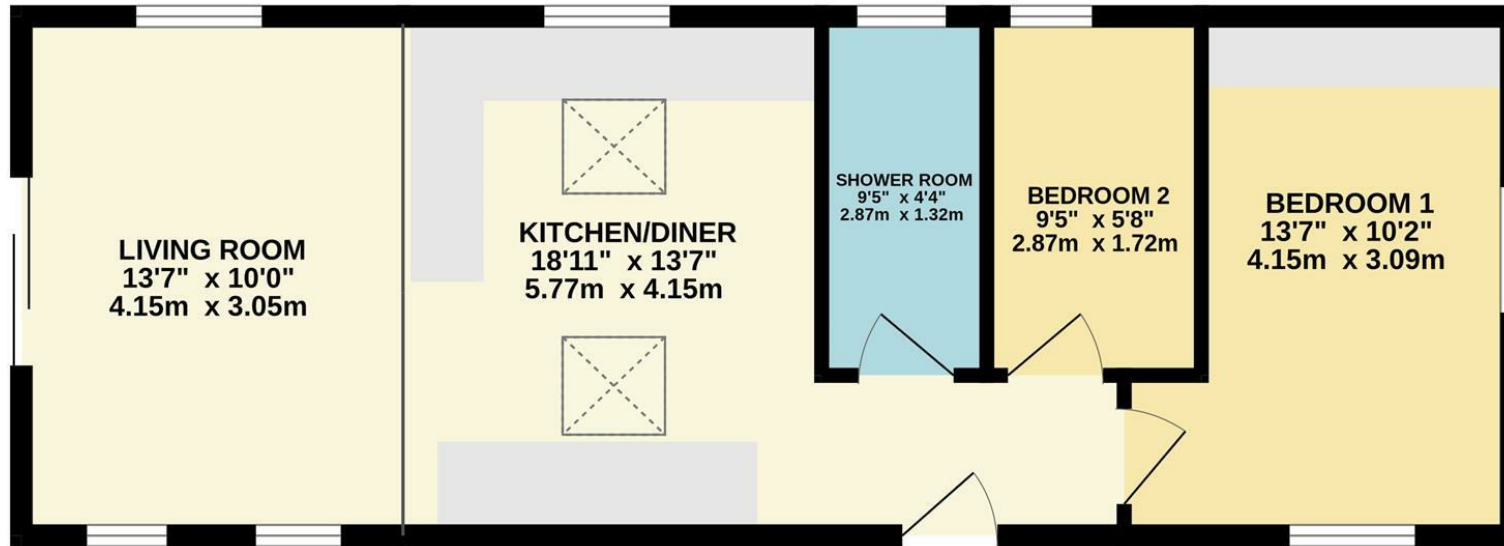

Measurements are approximate. Not to scale. Illustrative purposes only  
Made with Metropix ©2024



These particulars are believed to be accurate but they are not guaranteed and do not form a contract. Neither Jordan Fishwick nor the vendor or lessor accept any responsibility in respect of these particulars, which are not intended to be statements or representations of fact and any intending purchaser or lessee must satisfy himself by inspection or otherwise as to the correctness of each of the statements contained in these particulars. Any floorplans on this brochure are for illustrative purposes only and are not necessarily to scale.

Offices at: Chorlton, Didsbury, Disley, Hale, Glossop, Macclesfield, Manchester Deansgate, Manchester Whitworth Street, New Mills, Sale, Wilmslow and Withington

36-38 Alderley Road, Wilmslow, Cheshire, SK9 1JX

**01625 532000**

[wilmslow@jordanfishwick.co.uk](mailto:wilmslow@jordanfishwick.co.uk)

[www.jordanfishwick.co.uk](http://www.jordanfishwick.co.uk)