



Jordan fishwick

23 CROFT PARK NEWTON HALL LANE MOBBERLEY WA16 7LN
Guide Price £180,000

23 CROFT PARK NEWTON HALL LANE MOBBERLEY WA16 7LN

Take a look into this beautifully presented (Over 50's) Park Home situated in a semi-rural and highly sought after location. Internally the home comprises of two excellent sized bedrooms, generous living room space and a three-piece suite shower room. The kitchen diner is an attractive and spacious area, with matching wall and base mounted units nicely complimented by an oak inspired worktop. Integrated appliances include, fridge freezer, washing machine, oven, gas hob and worktop integrated stainless steel sink with drainer. Externally the home benefits from idyllic views over a pleasant pond and a private fenced patio space which provides a great social spot. Off road parking also provided. Viewings essential.



GROUND FLOOR

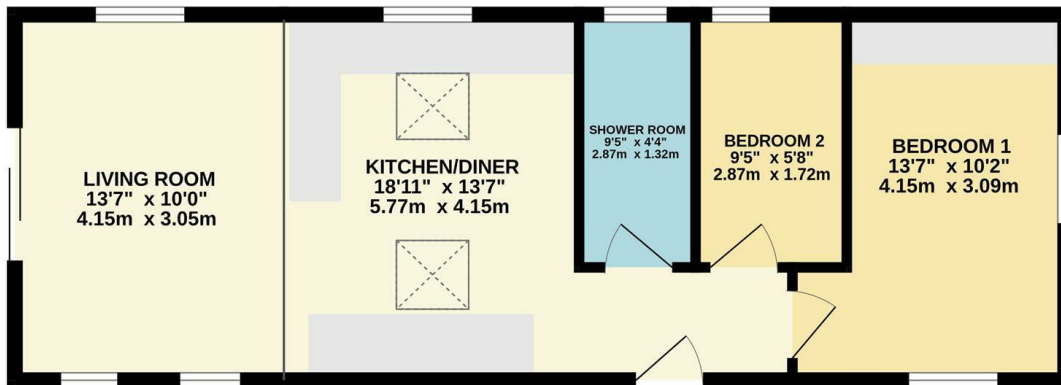

Measurements are approximate. Not to scale. Illustrative purposes only. Made with Metropix ©2024

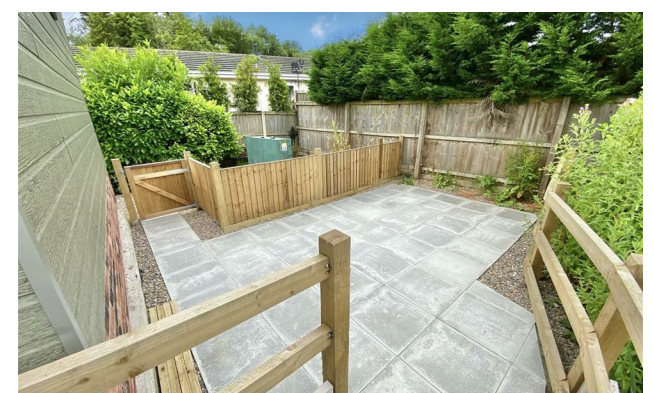

- Two Bedrooms
- Modern Kitchen Diner
- Park Home
- Over 50's
- Off-Road Parking
- Semi Rural Location
- Attractive external space