



jordan fishwick

28 Croft Park Newton Hall Lane, WA16 7LN
Guide Price £190,000



Newton Hall Lane Mobberley

Guide Price £190,000



An attractive Park Home (Over 50's), situated in a lovely semi rural and highly sought after location which provides spacious accommodation to the highest of standards throughout. The property has light and airy accommodation and is heated by central heating (modern boiler) and double glazed throughout. It is situated in a idyllic position within Croft Park having excellent views over the fields and open countryside and has off road parking. The accommodation comprises of an open plan and modern kitchen diner with the kitchen. There are two double bedrooms and a stylish bathroom with a three piece white suite. Externally there is a raised decked patio access from the living room and off road parking. Viewings essential.



- Park Home
- Over 50's
- Amazing Views
- Parking
- Stunning kitchen and bathroom
- Raised decked patio
- No Chain
- Fitted wardrobes



GROUND FLOOR

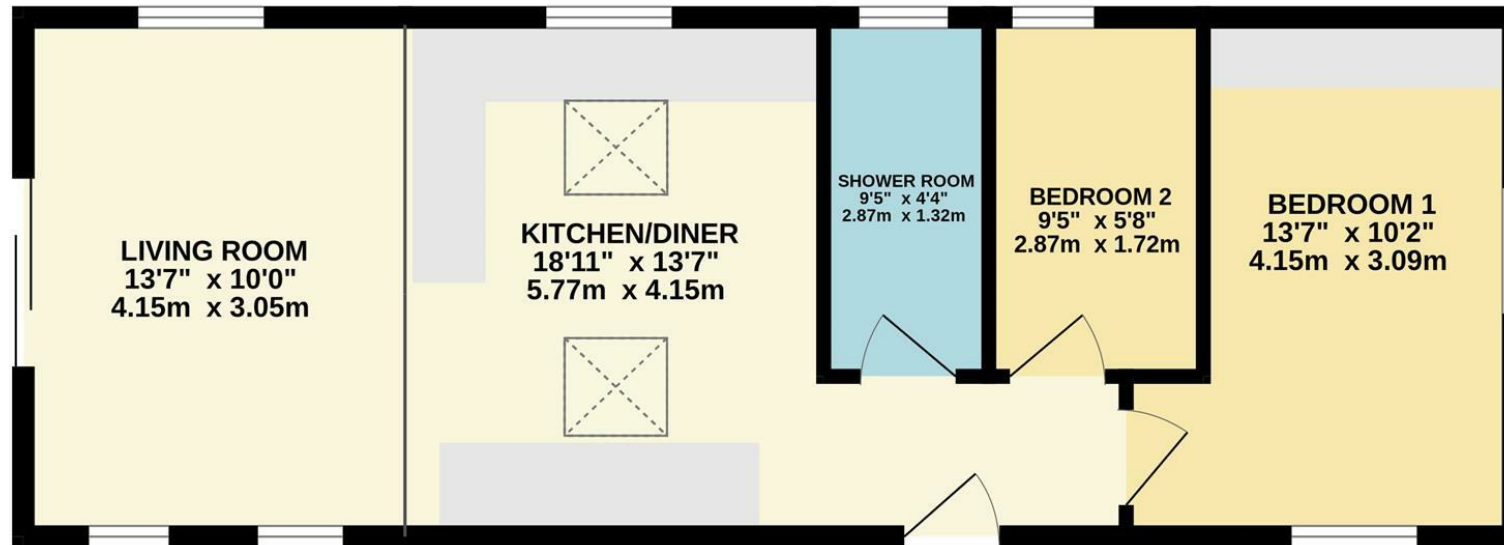

Measurements are approximate. Not to scale. Illustrative purposes only
Made with Metropix ©2024



These particulars are believed to be accurate but they are not guaranteed and do not form a contract. Neither Jordan Fishwick nor the vendor or lessor accept any responsibility in respect of these particulars, which are not intended to be statements or representations of fact and any intending purchaser or lessee must satisfy himself by inspection or otherwise as to the correctness of each of the statements contained in these particulars. Any floorplans on this brochure are for illustrative purposes only and are not necessarily to scale.

Offices at: Chorlton, Didsbury, Disley, Hale, Glossop, Macclesfield, Manchester Deansgate, Manchester Whitworth Street, New Mills, Sale, Wilmslow and Withington

36-38 Alderley Road, Wilmslow, Cheshire, SK9 1JX

01625 532000

wilmslow@jordanfishwick.co.uk

www.jordanfishwick.co.uk