



*jordan fishwick*

13 Alderdale Grove, SK9 6LY  
Guide Price £495,950

# Alderdale Grove Wilmslow SK9 6LY

Guide Price £495,950



This attractive and traditional three bedroom detached family home is situated within a desirable South Wilmslow cul de sac location which is within convenient reach of local schools and open countryside alike. The property in brief comprises: entrance hallway, living/dining room, kitchen, conservatory, three well proportioned bedrooms and a family bathroom. Externally the rear garden offers an excellent sociable space and to the front aspect a driveway provides two off-road parking spaces and access to the garage. Viewings essential to appreciate.



- Detached Property
- Three Bedrooms
- South Wilmslow Location
- Off-road Parking
- Private Garden to Rear
- Conservatory
- Garage



Energy Efficiency Rating		
	Current	Potential
Very energy efficient - lower running costs		
(92 plus) <b>A</b>		
(81-91) <b>B</b>		<b>82</b>
(69-80) <b>C</b>		
(55-68) <b>D</b>	<b>61</b>	
(39-54) <b>E</b>		
(21-38) <b>F</b>		
(1-20) <b>G</b>		
Not energy efficient - higher running costs		
<b>England &amp; Wales</b>	EU Directive 2002/91/EC	



GROUND FLOOR

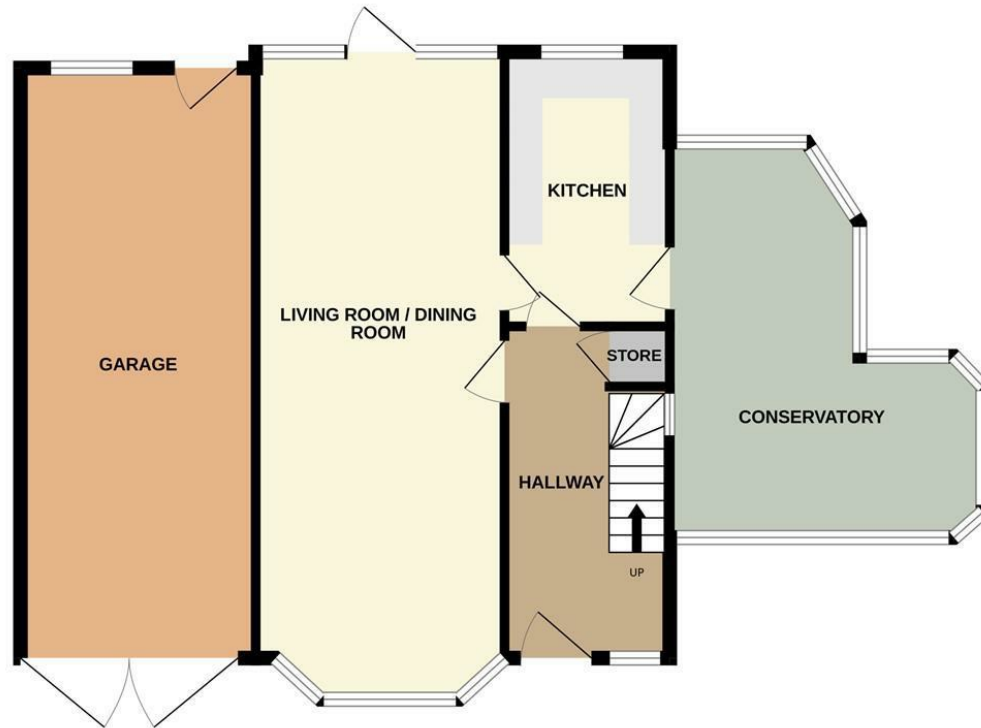

1ST FLOOR

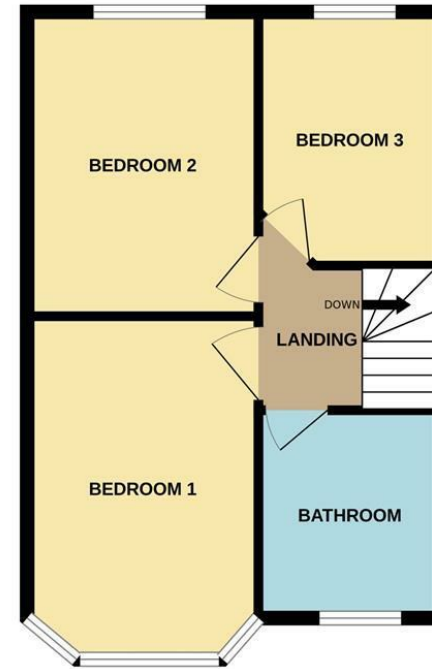

Measurements are approximate. Not to scale. Illustrative purposes only  
Made with Metropix ©2024



These particulars are believed to be accurate but they are not guaranteed and do not form a contract. Neither Jordan Fishwick nor the vendor or lessor accept any responsibility in respect of these particulars, which are not intended to be statements or representations of fact and any intending purchaser or lessee must satisfy himself by inspection or otherwise as to the correctness of each of the statements contained in these particulars. Any floorplans on this brochure are for illustrative purposes only and are not necessarily to scale.

Offices at: Chorlton, Didsbury, Disley, Hale, Glossop, Macclesfield, Manchester Deansgate, Manchester Whitworth Street, New Mills, Sale, Wilmslow and Withington

36-38 Alderley Road, Wilmslow, Cheshire, SK9 1JX

01625 532000

wilmslow@jordanfishwick.co.uk

www.jordanfishwick.co.uk