



*jordan fishwick*

63 Eastleigh Road, SK8 3EJ  
Guide Price £285,000

# Eastleigh Road Heald Green SK8 3EJ

Guide Price £285,000



NO CHAIN. This three bedroom mid mews property is situated in a central location in Heald Green. In brief the accommodation comprises: entrance hallway, downstairs wc, large open plan living and dining room and breakfast kitchen to the ground floor. To the first floor there are three bedrooms, the main bedroom with a built in storage cupboard and there is a modern stylish shower room. To the front of the property the driveway offers off road parking leading to the integral garage and to the rear there is an enclosed garden mainly laid to lawn with a patio area.



- No Chain
- Downstairs W.C
- Kitchen diner
- Integral Garage
- Off road parking
- Three bedrooms
- Village Location
- Rear Garaden



Energy Efficiency Rating		
	Current	Potential
Very energy efficient - lower running costs		
(92 plus) <b>A</b>		
(81-91) <b>B</b>		<b>83</b>
(69-80) <b>C</b>		
(55-68) <b>D</b>	<b>62</b>	
(39-54) <b>E</b>		
(21-38) <b>F</b>		
(1-20) <b>G</b>		
Not energy efficient - higher running costs		
<b>England &amp; Wales</b>	EU Directive 2002/91/EC 	



GROUND FLOOR

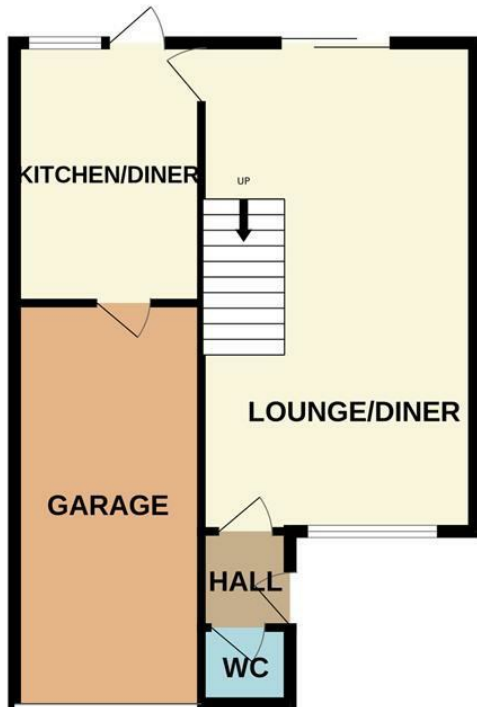

1ST FLOOR

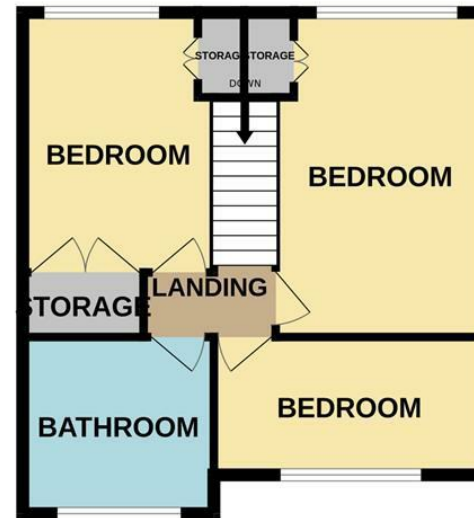

Measurements are approximate. Not to scale. Illustrative purposes only  
Made with Metropix ©2024



These particulars are believed to be accurate but they are not guaranteed and do not form a contract. Neither Jordan Fishwick nor the vendor or lessor accept any responsibility in respect of these particulars, which are not intended to be statements or representations of fact and any intending purchaser or lessee must satisfy himself by inspection or otherwise as to the correctness of each of the statements contained in these particulars. Any floorplans on this brochure are for illustrative purposes only and are not necessarily to scale.

Offices at: Chorlton, Didsbury, Disley, Hale, Glossop, Macclesfield, Manchester Deansgate, Manchester Whitworth Street, New Mills, Sale, Wilmslow and Withington

36-38 Alderley Road, Wilmslow, Cheshire, SK9 1JX

01625 532000

wilmslow@jordanfishwick.co.uk

www.jordanfishwick.co.uk