



**jordan fishwick**

63 EASTLEIGH ROAD HEALD GREEN SK8 3EJ  
Guide Price £285,000



## 63 EASTLEIGH ROAD HEALD GREEN SK8 3EJ

NO CHAIN. This three bedroom mid mews property is situated in a central location in Heald Green. In brief the accommodation comprises: entrance hallway, downstairs wc, large open plan living and dining room and breakfast kitchen to the ground floor. To the first floor there are three bedrooms, the main bedroom with a built in storage cupboard and there is a modern stylish shower room. To the front of the property the driveway offers off road parking leading to the integral garage and to the rear there is an enclosed garden mainly laid to lawn with a patio area.



GROUND FLOOR

1ST FLOOR

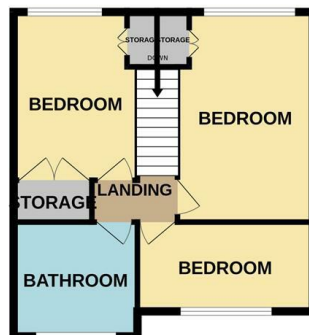
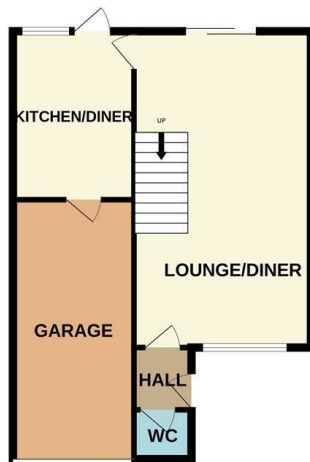

Measurements are approximate. Not to scale. Illustrative purposes only. Made with Metropix iC204.



- No Chain
- Downstairs W.C
- Kitchen diner
- Integral Garage
- Off road parking
- Three bedrooms
- Village Location
- Rear Garden

Energy Efficiency Rating		Environmental Impact (CO <sub>2</sub> ) Rating			
Very energy efficient - lower running costs	Current	Potential	Very environmentally friendly - lower CO <sub>2</sub> emissions	Current	Potential
(92 plus) A			(92 plus) A		
(81-91) B			(81-91) B		
(69-80) C			(69-80) C		
(55-68) D			(55-68) D		
(39-54) E			(39-54) E		
(21-38) F			(21-38) F		
(1-20) G			(1-20) G		
Not energy efficient - higher running costs			Not environmentally friendly - higher CO <sub>2</sub> emissions		
England & Wales	EU Directive 2002/91/EC	83	England & Wales	EU Directive 2002/91/EC	62