



JORDAN FISHWICK  
EXCLUSIVE

Broad Lane | Altrincham





£25,000 PCM

## Features

- Six bedrooms
- Five Bathrooms
- Cinema
- Jacuzzi, Steam room & Gym
- Council Tax Band H
- EPC Rating - C
- Beautiful family home
- Excellent security
- Stunning setting



Broad Lane, HALE - Fabulous detached mansion in a stunning setting, commanding a generous plot on one of Hale's premier roads. Over 8000sqft of luxury accommodation. Available for viewing by private appointment. Please call 0161 929 3000 to arrange a viewing.



## General information

- Tax Band: H
- Sqft: sq ft
- Plot: acre(s)
- Bedrooms: 6
- Bathrooms: 5
- Postcode: WA15 0DG

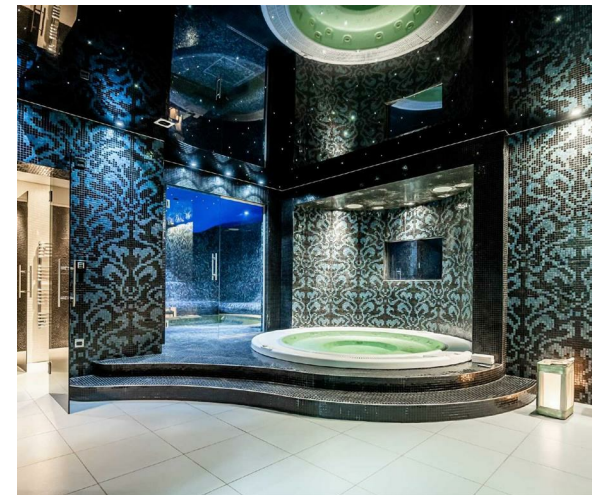





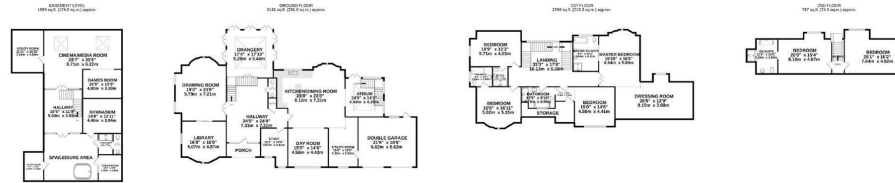

TOTAL FLOOR AREA: 8128 sq.ft. (755.1 sq.m.) approx.  
 Whilst every attempt has been made to ensure the accuracy of the Floorplan contained here, measurements of doors, windows, rooms and any other items are approximate and no responsibility is taken for any error, omission or mis-statement. This plan is for illustrative purposes only and should be used as such by any prospective purchaser. The services, systems and appliances shown have not been tested and no guarantee as to their operability or efficiency can be given.  
 Made with Metrage 10/2021

IMPORTANT: we would like to inform prospective purchasers that these sales particulars have been prepared as a general guide only. A detailed survey has not been carried out, nor the services, appliances and fittings tested. Room sizes should not be relied upon for furnishing purposes and are approximate. If floor plans are included, they are for guidance only and illustration purposes only and may not be to scale. If there are any important matters likely to affect your decision to buy, please contact us before viewing the property.

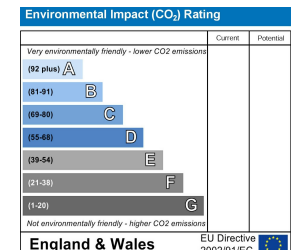
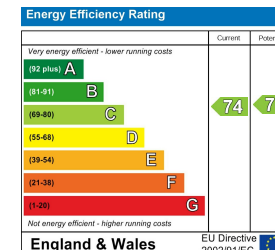

JORDAN FISHWICK  
**EXCLUSIVE**

Jordan Fishwick  
 172 Ashley Road, Altrincham, Cheshire, WA15 9SF  
 0161 929 9797  
 hale@jordanfishwick.co.uk  
 www.jfexclusive.co.uk