



THE  
OLD  
FARM

JORDAN FISHWICK  
EXCLUSIVE

*Jordan* fishwick

HALE  
Hilltop Drive





# Hilltop Drive, Hale, WA15 0JN

£3,300,000



## The Property

Dating back to the early 17th Century this wonderful example of late Elizabethan/Jacobean farm is an opportunity not to be missed. Reputedly the oldest property in the area and once the primary landowner, Old Farm is now a resplendent example of how to incorporate modern stylish décor within a fine example of old-world charm and character. The date stone in the front gable displays the initials of the very first family and the date of 1689 hints to the reason for its current Grade II listing. Under a stone tiled roof, the original part of the farm has a variety of rooms including a large drawing room with a wonderful Mullioned Stone bay window and original beams. Other traditional features include, wood panelling, stone fireplaces, and latch key doors, all of which have been enhanced or expertly replicated. Six beds, five baths, 4 receptions plus annex and swimming pool.

Council Tax Band - H  
EPC - TBC

## Directions

WA15 0JN

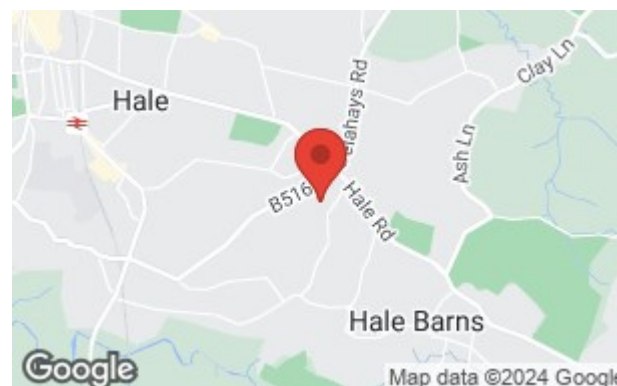



- Early 17th century
- Six bedrooms
- Five bathrooms
- Stunning reception rooms
- Original period features
- Outdoor heated Swimming pool
- Grade 2 Listed
- 4 Reception rooms
- Landscaped and manicured grounds
- Gated Entrance

Postcode - WA15 0JN

EPC Rating - G

Floor Area - 5898.00 sq ft

Local Authority - Trafford

Council Tax - H



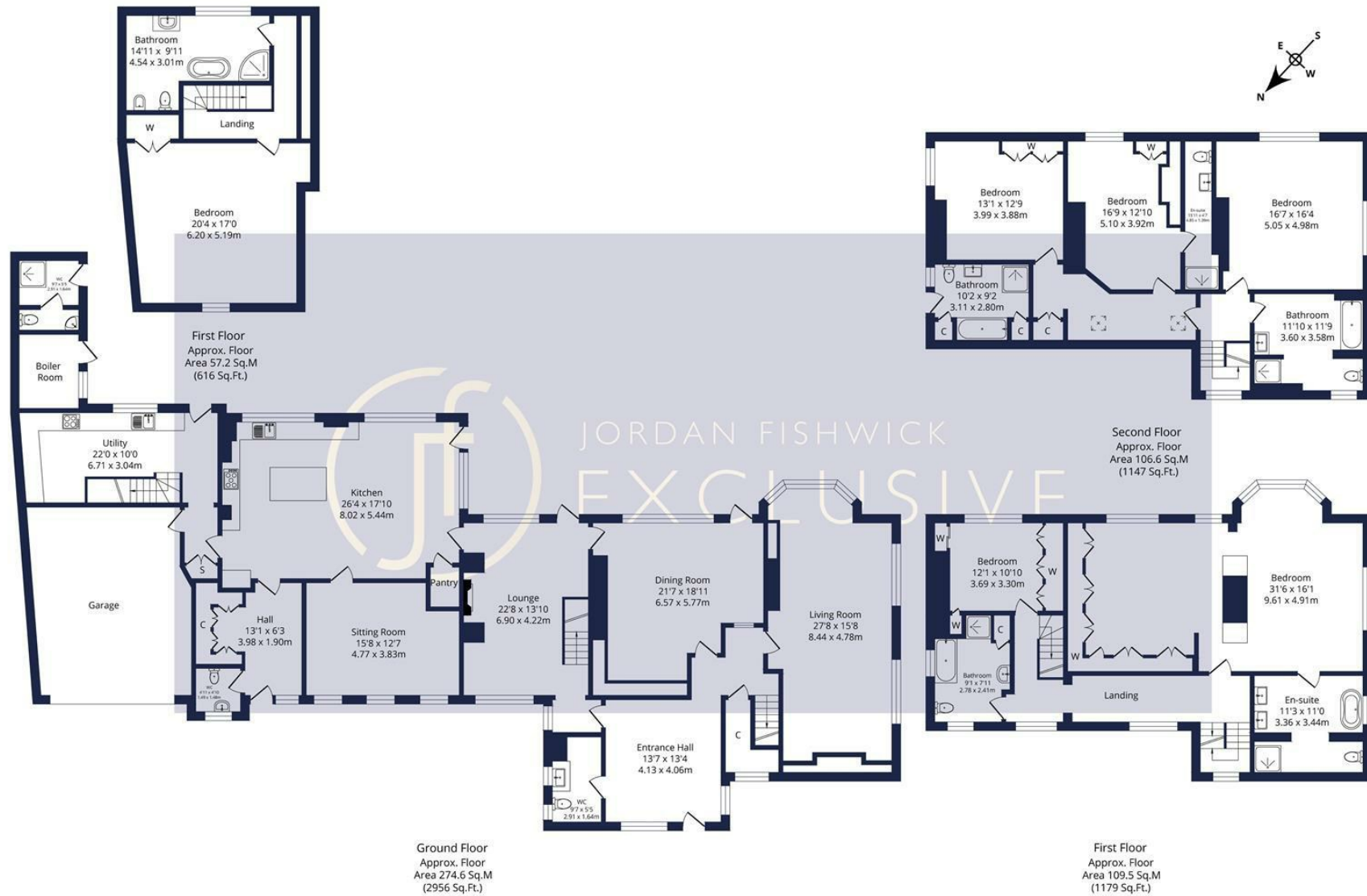

Surveyed and drawn by Lens Media for illustrative purposes only. Not to scale. Whilst every attempt was made to ensure the accuracy of the floor plan, all measurements are approximate and no responsibility is taken for any error.



These particulars are believed to be accurate but they are not guaranteed and do not form a contract. Neither Jordan Fishwick nor the vendor or lessor accept any responsibility in respect of these particulars, which are not intended to be statements or representations of fact and any intending purchaser or lessee must satisfy himself by inspection or otherwise as to the correctness of each of the statements contained in these particulars. Any floorplans on this brochure are for illustrative purposes only and are not necessarily to scale.

Offices at: Chorlton, Didsbury, Disley, Hale, Glossop, Macclesfield, Manchester Deansgate, Manchester Whitworth Street, New Mills, Sale, Wilmslow and Withington

0161 929 9797

hale@jordanfishwick.co.uk  
www.jordanfishwick.co.uk