



*Jordan fishwick*

ALTRINCHAM  
Parkfield Court





# Parkfield Court, Altrincham, WA14 2BU

£775,000



## The Property

\*\*\*NO ONWARD CHAIN\*\*\* Jordan Fishwick are proud to present this stunning and extended three bedroom townhouse for sale. Located on a private cul-de-sac the property has been immaculately maintained and offers spacious living accommodation. Located only a short walk to Altrincham Town Centre and within good proximity of outstanding schools, such as Altrincham Grammar School for both Boys & Girls and Loreto Grammar School.

In brief there is an entrance hall with access to a DWC, a spacious living room with a vaulted ceiling and double doors leading to the rear courtyard. A good sized dining room, kitchen/breakfast area with space for further seating and with access to stairs leading down via the double storey extension into the utility room and integral garage. On the first floor there are two double bedrooms, one with en-suite. There is also a four piece bathroom and separate dressing room. The landing leads to a second floor third bedroom, with views toward Manchester City Centre.

Externally you have off road parking at the front which leads to an integral garage with direct access into the property and with further potential to create an added parking space. To the rear there is an enclosed private flagged rear garden which is bordered by timber fencing.

Viewings are strongly advised to truly appreciate this spacious home.

## Directions

WA14 2BU



Map data ©2024 Google



- 3 Bedroom Townhouse
- Immaculate throughout
- Integral Garage
- Double Storey Extension to Rear
- Large Kitchen/Breakfast with Integrated Appliances
- No Onward Chain
- Utility and Seperate Dressing Room
- 4 Piece Bathroom and En-suite
- Off Road Parking
- Private Road

Postcode - WA14 2BU

EPC Rating - D

Floor Area - 2459.00 sq ft

Local Authority - Trafford

Council Tax - F



LOWER GROUND FLOOR

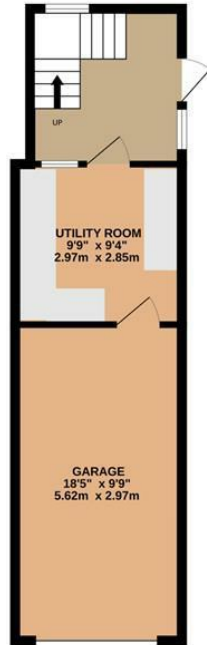

GROUND



1ST FLOOR

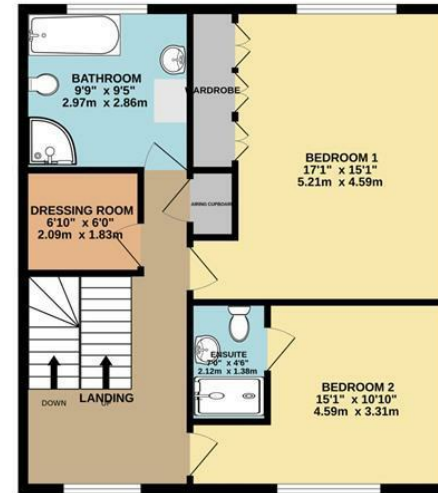

2ND FLOOR

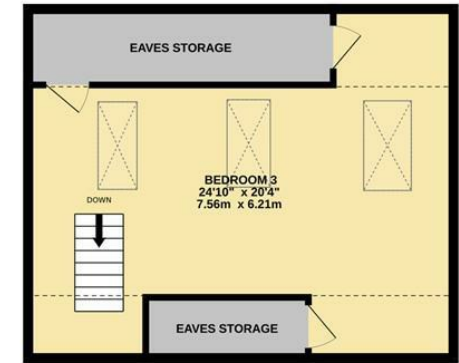

Whilst every attempt has been made to ensure the accuracy of the floorplan contained here, measurements of doors, windows, rooms and any other items are approximate and no responsibility is taken for any error, omission or mis-statement. This plan is for illustrative purposes only and should be used as such by any prospective purchaser. The services, systems and appliances shown have not been tested and no guarantee as to their operability or efficiency can be given.  
Made with Metropix ©2023



These particulars are believed to be accurate but they are not guaranteed and do not form a contract. Neither Jordan Fishwick nor the vendor or lessor accept any responsibility in respect of these particulars, which are not intended to be statements or representations of fact and any intending purchaser or lessee must satisfy himself by inspection or otherwise as to the correctness of each of the statements contained in these particulars. Any floorplans on this brochure are for illustrative purposes only and are not necessarily to scale.

Offices at: Chorlton, Didsbury, Disley, Hale, Glossop, Macclesfield, Manchester Deansgate, Manchester Whitworth Street, New Mills, Sale, Wilmslow and Withington

0161 929 9797

hale@jordanfishwick.co.uk  
www.jordanfishwick.co.uk