



jordan fishwick

ALTRINCHAM
Chesham Place



Chesham Place, Altrincham, WA14 2JL

£2,800 PCM



The Property

***** AVAILABLE NOW ***** A magnificent first floor apartment with lift access in a prestigious gated development being just a stones throw from Hale village.

The original mansion house was converted into just nine apartments by renowned Developer Belmont Homes in 2005. The apartment retains the large rooms, 10ft ceiling heights and features one would expect from a building of this age, which are complimented by a very high quality, contemporary finish. Large living/dining room with wooden flooring and bay window, stylish fitted kitchen, extensive master bedroom with a four piece En-suite, a further generous double bedroom. Additionally you have bedroom three which accommodates a large dressing room with fitted furnishings providing sought after storage space. Finally you have the family bathroom and separate utility room. The building sits behind secure electric gates and is surrounded by immaculate communal gardens with allocated parking. 6 MONTH LET PREFERRED - Offered on an unfurnished basis. Call now to view 0161 929 9797

Directions

WA14 2JL



- Prestigious Gated Development
- Two/Three Bedrooms
- Two Bathrooms
- Presented to the Highest Standard
- Lift Access
- Allocated Parking Space
- Walking distance to Hale and Altrincham

Postcode - WA14 2JL

EPC Rating - C

Floor Area - 1510.00 sq ft

Local Authority - Trafford Council

Council Tax - G



GROUND FLOOR
1510 sq.ft. (140.3 sq.m.) approx.

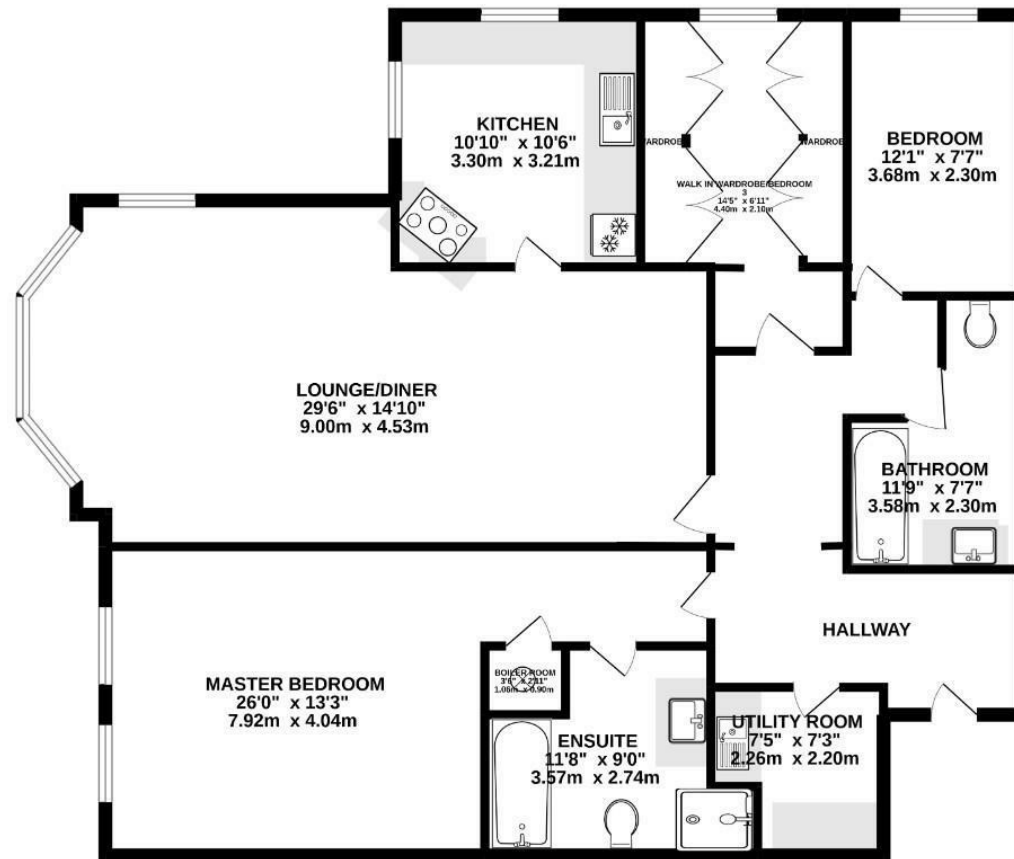

TOTAL FLOOR AREA - 1510sq.ft. (140.3 sq.m.) approx.

Whilst every attempt has been made to ensure the accuracy of the floorplan contained here, measurements of doors, windows, rooms and any other items are approximate and no responsibility is taken for any error, omission or mis-statement. This plan is for illustrative purposes only and should be used as such by any prospective purchaser. The services, systems and appliances shown have not been tested and no guarantee as to their operability or efficiency can be given.
Made with Metropix ©2022



These particulars are believed to be accurate but they are not guaranteed and do not form a contract. Neither Jordan Fishwick nor the vendor or lessor accept any responsibility in respect of these particulars, which are not intended to be statements or representations of fact and any intending purchaser or lessee must satisfy himself by inspection or otherwise as to the correctness of each of the statements contained in these particulars. Any floorplans on this brochure are for illustrative purposes only and are not necessarily to scale.

Offices at: Chorlton, Didsbury, Disley, Hale, Glossop, Macclesfield, Manchester Deansgate, Manchester Whitworth Street, New Mills, Sale, Wilmslow and Withington

0161 929 9797

hale@jordanfishwick.co.uk
www.jordanfishwick.co.uk