



**LexAllan**

local knowledge exceptional service

1 Coniston Drive, Kingswinford, West Midlands, DY6 9BZ



**\*\* CHAMRING PROPERTY, CHARMING LOCATION \*\***

This three bedroom dormer style bungalow is now offered with NO UPWARD CHAIN. Having been well maintained and modernised, this truly is perfect for those looking for turn key ready accommodation. In brief the property comprises of; kitchen, lounge, dining room, three bedrooms and family bathroom. To the rear is a peaceful garden along with parking to the front. Call us today to arrange your viewing.

**Approach**

Block paved drive to front providing off road parking

**Kitchen**

Variety of wall and base units, electric oven with hob and extractor above, plumbing for washing machine, dishwasher, tiled flooring, sink and drainer, access leading to the side of the property, sky light.

**Lounge**

Log burner with hearth, double glazed window to front, central heated radiator, opening to the dining room.

**Dining Room**

French doors opening up onto the decked area, central heated radiator, stairs rising to first floor.

**Bedroom 1**

Double glazed window to rear, central heated radiator.

**Bathroom**

Bath with shower over, wash hand basin, w.c, spot lights, double glazed window to side, central heated towel rail.

**Bedroom 2**

Two sky lights, spot lights.

**Bedroom 3**

Storage into the eaves, sky light, spot lights.

**Rear Garden**

Decked area along with a neat and today lawn, side access to the front of the property.



### Money Laundering Regulations.

Please note that under the MONEY LAUNDERING REGULATIONS 2017 we are legally required to verify the identity of all purchasers and the source of their funds to enable the purchase, all prospective purchasers are required to provide the following - 1. Satisfactory photographic identification. 2. Proof of address/residency. 3. Verification of the source of purchase funds. Lex Allan reserves the right to obtain electronic verification of any relevant document sought which there will be a charge to the purchasers at £24 inc VAT per person. If your offer is acceptable we will be required to share personal details with relevant third parties regarding your chain details on your sale/purchase.

### Referral Fees.

We can confirm that if we are sourcing a quotation or quotations on your behalf relevant to the costs that you are likely to incur for the professional handling of the conveyancing process. You should be aware that we could receive a maximum referral fee of approximately £300 inc VAT should you decide to proceed with the engagement of the solicitor in question. We are informed that solicitors are happy to pay this referral fee to ourselves as your agent as it significantly reduces the marketing costs that they have to allocate to sourcing new business. The referral fee is NOT added to the conveyancing charges that would ordinarily be quoted.

We can also confirm that if we have provided your details to Infinity Financial Advice who we are confident are well placed to provide you with the very best possible advice relevant to your borrowing requirements. You should be aware that we receive a referral fee from Infinity for recommending their services. The charges that you will incur with them and all the products that they introduce to you will in no way be affected by this referral fee. On average the referral fees that we have received recently are £218 per case.

The same also applies if we have introduced you to the services of surveyors who we are confident will provide you with a first class service relevant to your property needs, we will again receive a maximum referral fee of £200 inc vat. This referral fee does not impact the actual fee that you would pay Green Street Surveys had you approached them direct as it is paid to us as an intermediary on the basis that we save them significant marketing expenditure in so doing. If you have any queries regarding the above, please feel free to contact us.

### Tenure (Freehold).

References to the tenure of a property are based on information supplied by the seller. We are advised that the property is freehold. A buyer is advised to obtain verification from their solicitor.

### Council Tax Band C







### Ground Floor

Approx. 53.6 sq. metres (577.3 sq. feet)

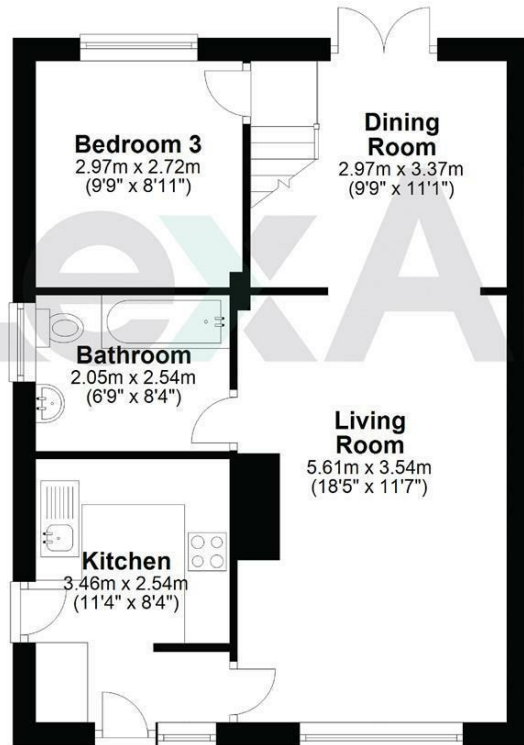

### First Floor

Approx. 32.0 sq. metres (344.6 sq. feet)

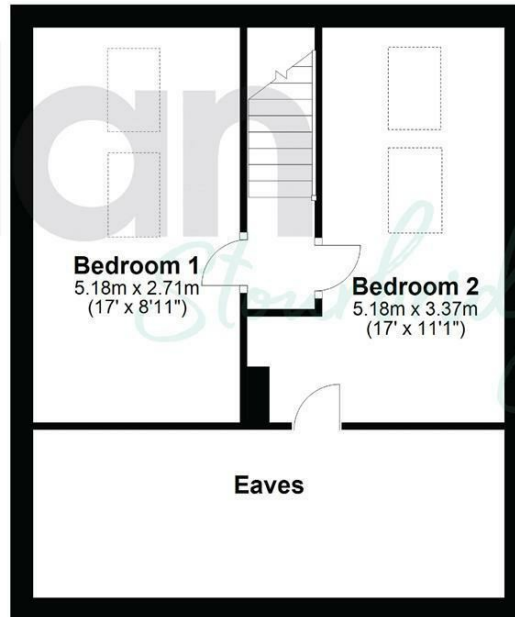

Total area: approx. 85.6 sq. metres (921.9 sq. feet)

DISCLAIMER - Floor plans shown are for general guidance only. Whilst every attempt has been made to ensure that the floorplan measurements are as accurate as possible, they are for illustrative purposes only.



**IMPORTANT NOTICE** 1. No description or information given whether or not these particulars and whether written or verbal (information) about the property or its value may be relied upon as a statement or representation of fact. Lex Allan do not have any authority to make representation and accordingly any information is entirely without responsibility on the part of Lex Allan or the seller. 2. The photographs (and artists impression) show only certain parts of the property at the time they were taken. Any areas, measurements or distances given are approximate only. 3. Any reference to alterations to, or use of any part of the property is not a statement that any necessary planning, building regulations or other consent has been obtained. 4. No statement is made about the condition of any service or equipment or whether they are year 2000 compliant.

**VIEWING** View by appointment only with Lex Allan. Opening times: Monday - Friday 9.00am to 5.30pm, Saturday 9.00am to 4.00pm.

The Auction House, 87 - 88 St. Johns Road,

Stourbridge, West Midlands, DY8 1EH

info@lexallan.co.uk

01384 379450

www.lexallan.co.uk

**LexAllan**

local knowledge exceptional service