

HUNTERS[®]

HERE TO GET *you* THERE



Buckingham Avenue

Welling, DA16 2LY

Asking Price £595,000



- Chain free - well presented
- South Welling location
- Three bedrooms
- Large garden & Driveway
- Floor Area: 909 total sq ft

- Detached bungalow
- Close to local schools, shops & transport
- Good size lounge & Extended kitchen/diner
- Call Hunters to view
- EPC Rating: E

Tel: 020 8304 1000

Buckingham Avenue

Welling, DA16 2LY

Asking Price £595,000



Nestled in the desirable location of Buckingham Avenue, South Welling, this well-presented detached bungalow offers a perfect blend of comfort and convenience. Spanning an impressive 909 square feet, the property boasts a spacious layout that is ideal for families or those seeking a peaceful retreat.

Upon entering, you are welcomed into a generous lounge situated at the rear of the home, providing a bright and airy atmosphere. The extended kitchen/diner is perfect for entertaining, allowing for seamless interaction with family and friends. The bungalow features three bedrooms, comprising two doubles and a single, which is currently utilised as a dressing room accessible from the master bedroom. This versatile space can easily be adapted to suit your needs.

The exterior of the property is equally impressive, featuring a large driveway that accommodates up to four/five vehicles, ensuring ample parking for residents and guests alike. The expansive garden offers a wonderful outdoor space for relaxation and recreation, making it an ideal setting for family gatherings or quiet evenings.

Conveniently located, this bungalow is in close proximity to local schools, shops, and transport links, making daily life effortless. With no onward chain, this property is ready for you to move in and make it your own.

Do not miss the opportunity to view this charming bungalow. Contact Hunters Estate Agents today to arrange your viewing and discover the potential of this delightful home.

Buckingham Avenue, Welling, DA16



Approximate Area = 767 sq ft / 71.2 sq m

Garage = 142 sq ft / 13.1 sq m

Total = 909 sq ft / 84.3 sq m

For identification only - Not to scale

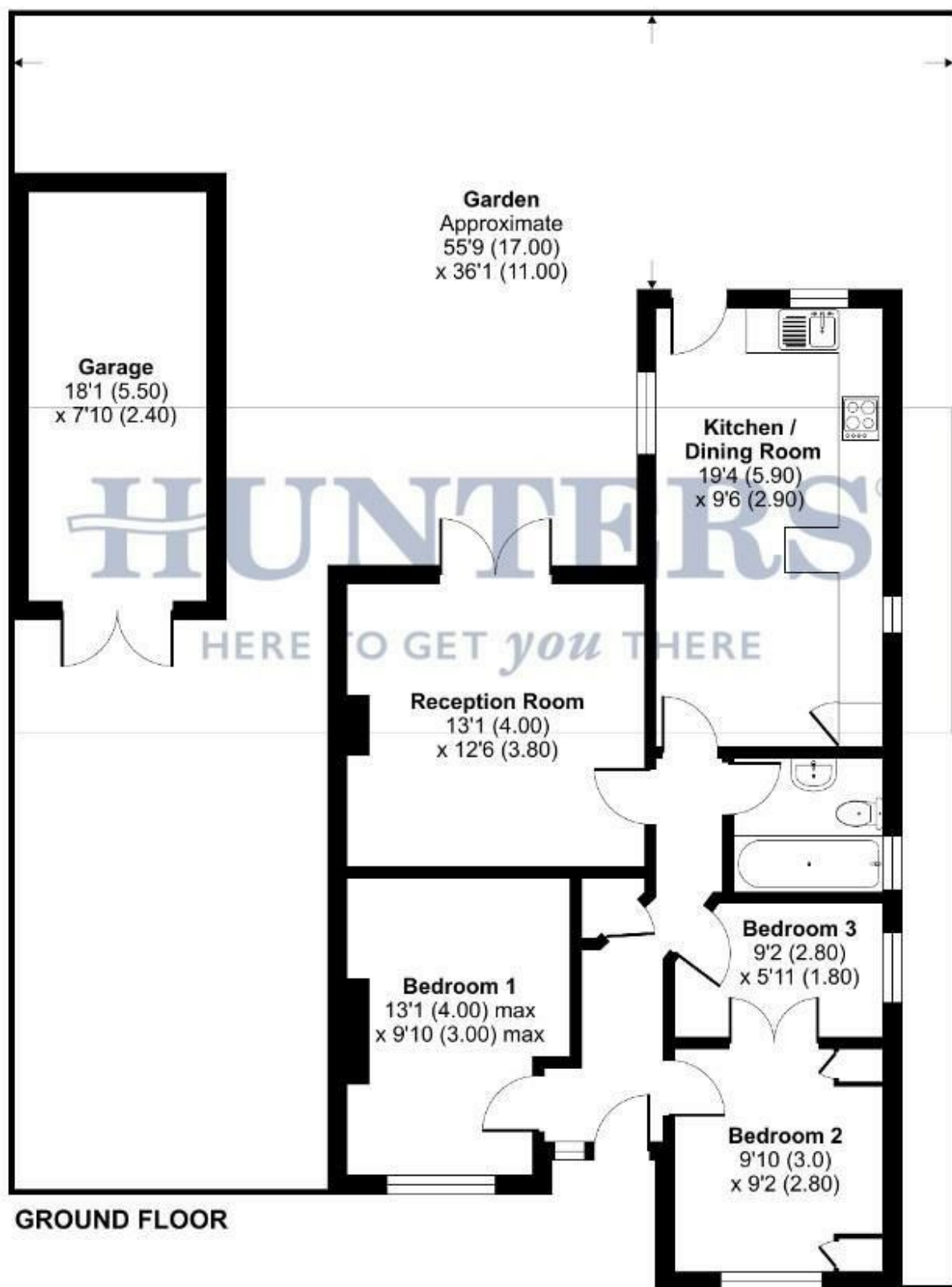

Floor plan produced in accordance with RICS Property Measurement 2nd Edition, incorporating International Property Measurement Standards (IPMS2 Residential). © nidecom 2025. Produced for Hunters Welling - Cross & Warren Enterprises Ltd. REF: 1263932







Energy Efficiency Graph

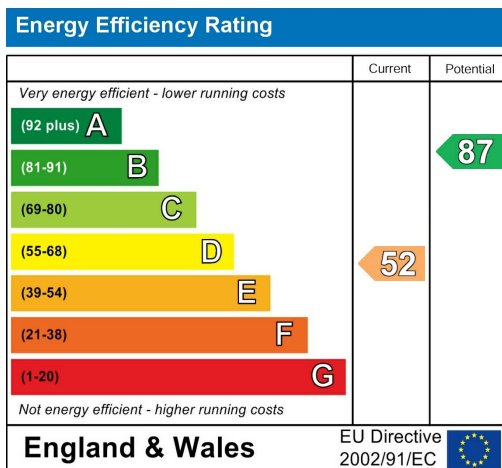

Viewing

Please contact our Hunters Welling Office on 020 8304 1000 if you wish to arrange a viewing appointment for this property or require further information.

Road Map

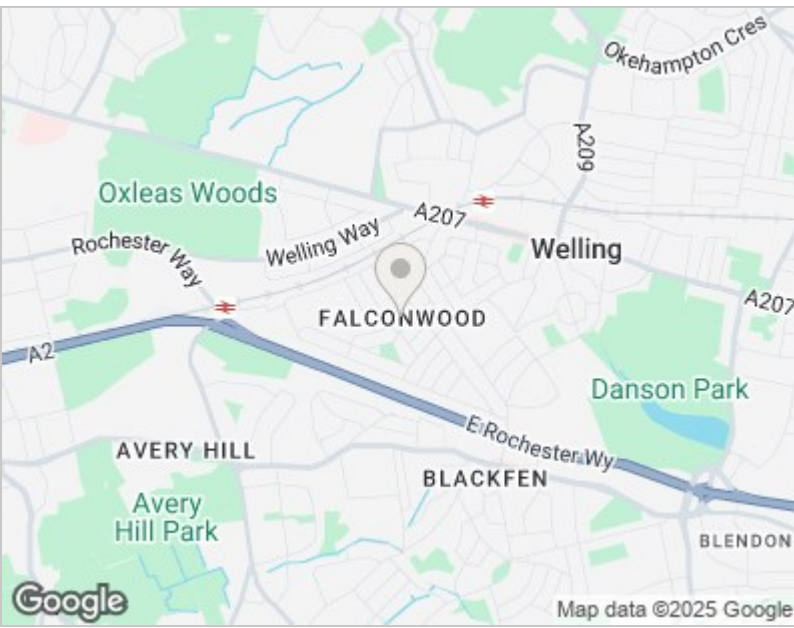

Hybrid Map

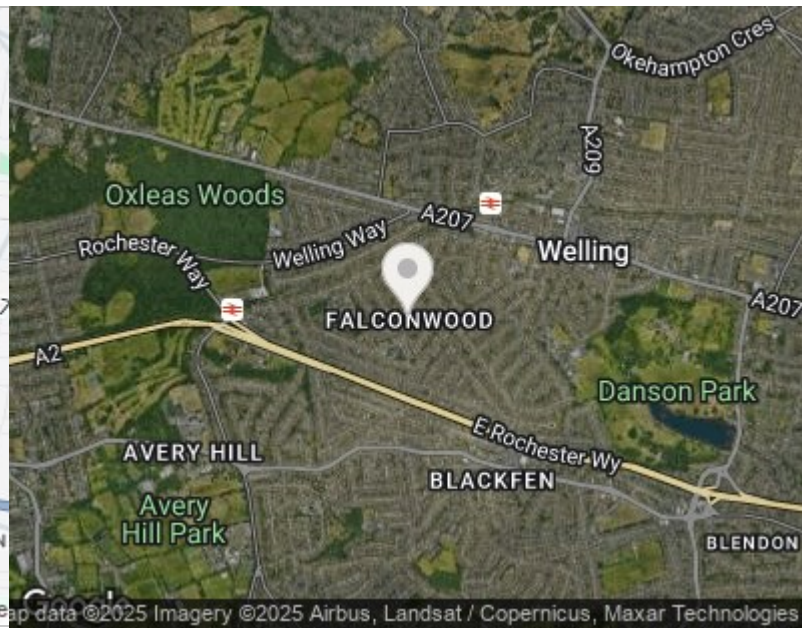



These particulars are intended to give a fair and reliable description of the property but no responsibility for any inaccuracy or error can be accepted and do not constitute an offer or contract. We have not tested any services or appliances (including central heating if fitted) referred to in these particulars and the purchasers are advised to satisfy themselves as to the working order and condition. If a property is unoccupied at any time there may be reconnection charges for any switched off/disconnected or drained services or appliances - All measurements are approximate. THINKING OF SELLING? If you are thinking of selling your home or just curious to discover the value of your property, Hunters would be pleased to provide free, no obligation sales and marketing advice. Even if your home is outside the area covered by our local offices we can arrange a Market Appraisal through our national network of Hunters estate agents.

39 High Street, Orpington, Kent, BR6 0JE
Tel: 020 8304 1000 Email: welling@hunters.com
www.hunters.com

