



Hanover Square, London W1S

Asking price £5,850,000 Leasehold





Description

A spectacular two bedroom apartment on the 7th floor of the iconic new development The Residences at Mandarin Oriental, Mayfair.

Residents enjoy privileged access to the full suite of hotel services and amenities, including an opulent spa with sauna and steam rooms, 25m pool and state of the art gym. Residents can also use the hotel's bar, fine dining restaurant, Akira Back Restaurant, and roof terrace, while hotel services extend beyond the hotel rooms, with valet parking, in-residence dining and housekeeping available to all apartments. A dedicated residential concierge is on hand 24 hours a day to handle every request down to the smallest details, with residents also benefitting from access to Mandarin Oriental's exclusive Residences Elite Program, which includes VIP benefits at any Mandarin Oriental hotel, anywhere in the world.

The Mandarin Oriental Mayfair is located in Hanover Square, a short walk from New Bond Street and Regent Street. The garden square is well-served by public transportation, with Oxford Circus Underground Station (0.2 miles) and Bond Street Underground Station (0.2 miles) within a short walking distance, providing easy access to the rest of London.

Floorplan

951 sq ft | 88 sq m

Mandarin Oriental Mayfair, W1

APPROX. GROSS INTERNAL AREA *
951 Sq Ft - 88.35 Sq M



This floorplan is for GUIDANCE ONLY and NOT FOR VALUATION purposes.

Key :
CH - Ceiling Height

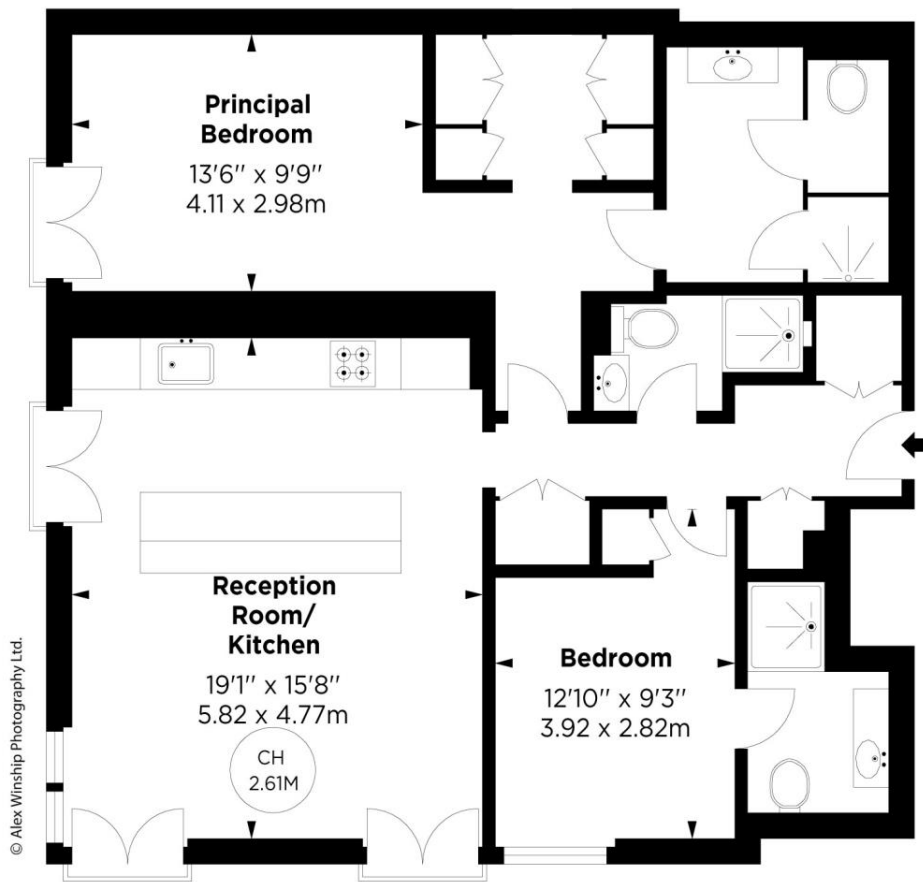

SEVENTH FLOOR

© Alex Winship Photography Ltd.



Mayfair and Marylebone
13a St George Street,
London W1S 2FQ
+44 207 399 5550
mayfair@jll.com

Urban living, your way.

jll.co.uk/residential

© 2019 Jones Lang LaSalle IP, Inc. All rights reserved. All information contained herein is from sources deemed reliable; however, no representation or warranty is made to the accuracy thereof.

