



Edgware Road, London W2

Asking price £990,000 Leasehold







Description

A well-presented three bedroom apartment on the second floor of a portered mansion block on Edgware Road.

This recently redecorated apartment comprises bright dual aspect open plan contemporary kitchen/reception room, master bedroom with en suite shower room, second double bedroom, third guest bedroom/study, modern family bathroom and guest cloakroom. Forset Court benefits from passenger lifts, 24 hour porter and stylishly refurbished communal areas. This property enjoys close proximity to the green open spaces of Hyde Park as well as the fashionable amenities of Oxford Street. Marble Arch and Edgware Road stations are conveniently within easy reach.

Floorplan

792 sq ft | 74 sq m

Forset Court,
Edgware Road, W2
Approximate Gross Internal Area
73.59 sq m / 792 sq ft

(CH = Ceiling Heights)

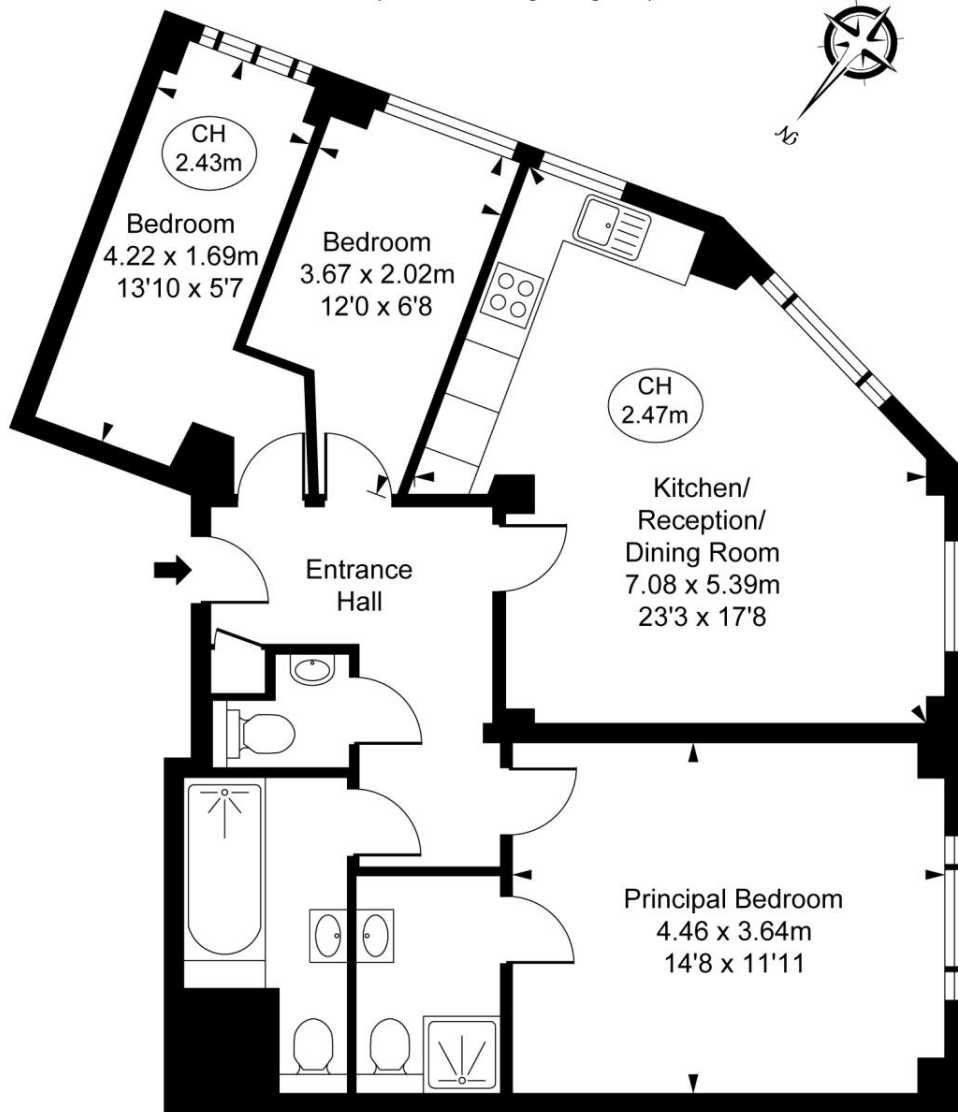

Second Floor

This plan is not to scale. It is for guidance and not for valuation purposes.
All measurements and areas are approximate only, and have been prepared in accordance with the current edition of the RICS Code of Measuring Practice.
© Fulham Performance

Mayfair and Marylebone
13a St George Street,
London W1S 2FQ
+44 207 399 5550
mayfair@jll.com

Urban living, your way.

jll.co.uk/residential

© 2019 Jones Lang LaSalle IP, Inc. All rights reserved. All information contained herein is from sources deemed reliable; however, no representation or warranty is made to the accuracy thereof.

