

58 St. Peters Street  
Canterbury  
CT1 2BE

£4,500 PCM

Finn's  
82 Castle Street  
Canterbury  
CT1 2QD  
t: 01227 452111  
e: [canterbury@finns.co.uk](mailto:canterbury@finns.co.uk)  
[www.finns.co.uk](http://www.finns.co.uk)



One of Canterbury's best kept secrets. This 16th Century Grade II listed home in the centre of Canterbury has been refurbished to an extremely high standard throughout whilst maintaining its original features. Situated on St Peter's Street within easy walking distance to Canterbury East and West railway stations, the Marlowe Theatre, Canterbury Cathedral and many of Canterbury's highly acclaimed Schools and Universities. A beautifully presented five bedroom detached period house providing spacious well appointed accommodation over three floors. The property comprises on the ground floor; grand entrance hall, two reception rooms, one of which opens through French Doors onto the garden, kitchen, dining room, boot room, shower room and rear entrance. On the first floor there are four bedrooms, a family bathroom and separate WC. The second floor comprises of a fifth bedroom plus dressing room/office. The property benefits from gas fired central heating, has several outbuildings for storage of bikes etc and off-street parking for a minimum of three vehicles. The large, landscaped garden can be maintained by the landlord's gardeners which would be payable over and above the monthly rent.



58 St. Peters Street  
Canterbury  
CT1 2BE

One of Canterbury's best kept secrets. This 16th Century Grade II listed home in the centre of Canterbury has been refurbished to an extremely high standard throughout whilst maintaining its original features. Situated on St Peter's Street within easy walking distance to Canterbury East and West railway stations, the Marlowe Theatre, Canterbury Cathedral and many of Canterbury's highly acclaimed Schools and Universities. A beautifully presented five bedroom detached period house providing spacious well appointed accommodation over three floors. The property comprises on the ground floor; grand entrance hall, two reception rooms, one of which opens through French Doors onto the garden, kitchen, dining room, boot room, shower room and rear entrance. On the first floor there are four bedrooms, a family bathroom and separate WC. The second floor comprises of a fifth bedroom plus dressing room/office. The property benefits from gas fired central heating, has several outbuildings for storage of bikes etc and off-street parking for a minimum of three vehicles.

- A beautifully renovated detached period property
- Five large bedrooms
- Two luxury bathrooms
- Secretly tucked away in the City Centre
- Beautiful landscaped gardens
- Private parking for three cars
- Two elegant reception rooms
- A ten minute walk from Canterbury West train station
- Twelve month tenancy
- Available end of May 2025

Viewing: By appointment through Finn's, Canterbury - Telephone: 01227 452111

Council Tax: G

Date: These particulars were prepared on: 10th April 2025







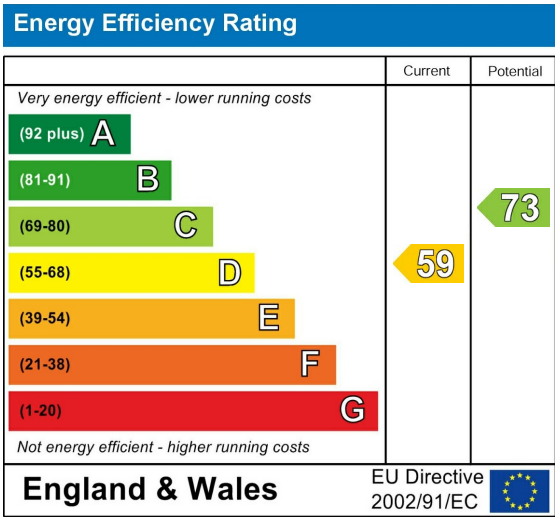
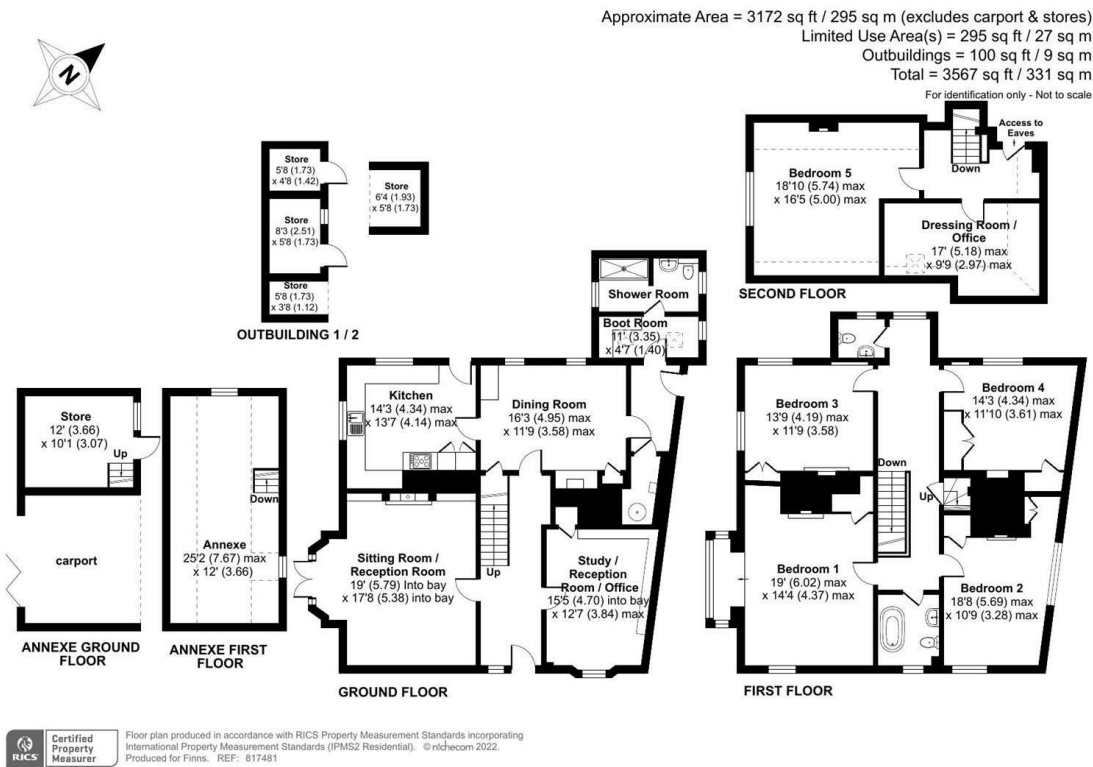

Agent's Note: Wherever appliances or services, fixtures or fittings have been mentioned in these particulars they have not been tested by us. Measurements should not be relied upon. Unless specifically referred to above all fitted carpets, curtains, fixtures and fittings and garden outbuildings and ornaments are excluded from the sale. None of the statements in these particulars are to be relied upon as statements or representatives of fact. Photographs are for guidance only and do not imply items shown are included in the sale - some aspects may have changed since they were taken. No person in the employment of Finn's has authority to give any representation or warranty in relation to this property.

FINN'S CANTERBURY  
82 Castle Street  
Canterbury  
Kent CT1 2QD  
Sales: 01277 454111  
Lettings: 01227 452111

FINN'S SANDWICH  
2 Market Street  
Sandwich  
Kent CT13 9DA  
Sales: 01304 612147  
Lettings: 01304 614471

FINN'S ST NICHOLAS AT WADE  
The Packhouse  
Wantsum Way  
St Nicholas at Wade  
Kent CT7 0NE  
01843 848320

