



MICHAEL YEO

ESTATE AGENTS



66 Furzehill Road

Borehamwood, WD6 2EF

£424,995

A well presented Victorian end of terrace cottage situated on a very popular road, conveniently located within a short walk of the town centre and mainline station. This property comprises two double bedrooms, two reception rooms, a recently fitted kitchen and a ground floor bathroom, complemented by gas central heating and double glazing throughout. With the added benefits of a private rear garden, off street parking on front driveway and offered with no upper chain, we strongly recommend an early viewing to secure.

EPC rating: D

Viewing

Please contact our Michael Yeo Estate Agents Office on if you wish to arrange a viewing appointment for this property or require further information.

- Victorian cottage
- Two double bedrooms
- Two reception rooms
- Modern fitted kitchen
- Ground floor bathroom
- Gas central heating
- Private rear garden
- Off street parking
- Close to town & station
- No chain



Floor Plan

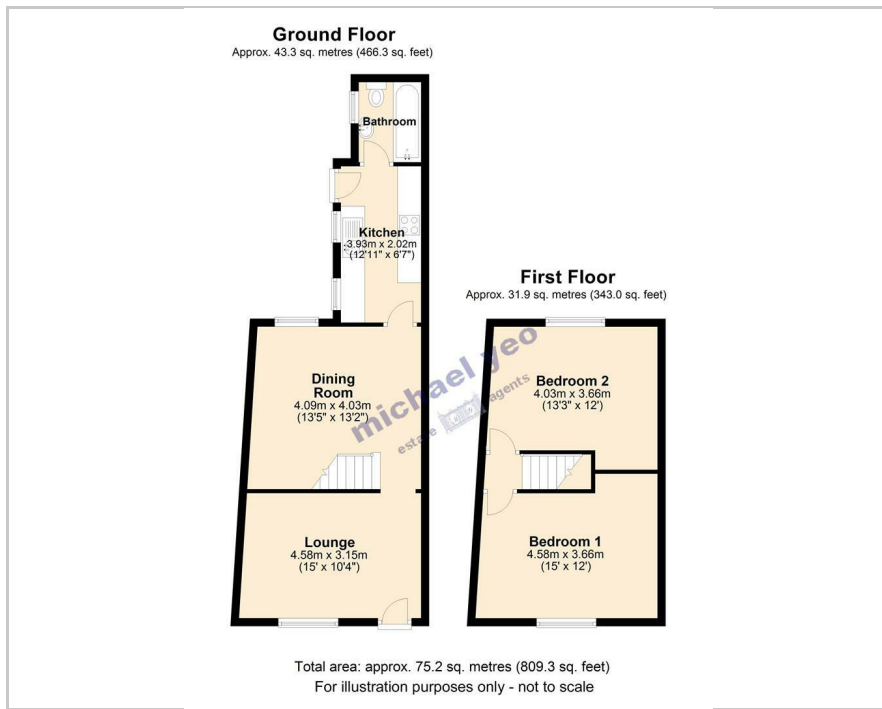

Area Map

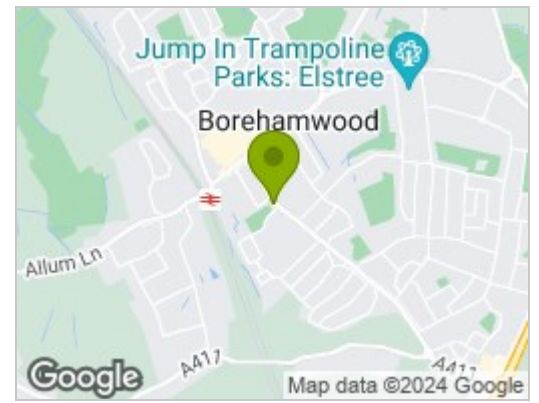

Energy Efficiency Graph

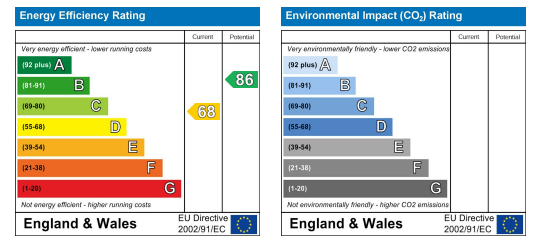

These particulars, whilst believed to be accurate are set out as a general outline only for guidance and do not constitute any part of an offer or contract. Intending purchasers should not rely on them as statements of representation of fact, but must satisfy themselves by inspection or otherwise as to their accuracy. No person in this firm's employment has the authority to make or give any representation or warranty in respect of the property.