



MICHAEL YEO

ESTATE AGENTS



27 Ashdown Drive

Borehamwood, WD6 4LZ

£315,000

An opportunity to acquire one of these popular duplex maisonettes situated in this sought after residential area just off Theobald Street, conveniently located within walking distance to the town centre and mainline station. In need of some updating, this property comprises three bedrooms, a dual aspect lounge/dining room, kitchen and bathroom, complemented by gas central heating and double glazing throughout. Also benefiting from a long lease, a garage situated in a block nearby, communal gardens and residents permit parking bays. Available with no upper chain, we strongly recommend an early viewing to secure.

EPC rating: D

Viewing

Please contact our Michael Yeo Estate Agents Office on if you wish to arrange a viewing appointment for this property or require further information.

- Duplex maisonette
- Three bedrooms
- Lounge/dining room
- Kitchen
- Bathroom
- Gas central heating
- Garage & residents parking
- Some updating required
- Close to town & station
- No chain

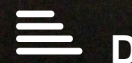

Floor Plan

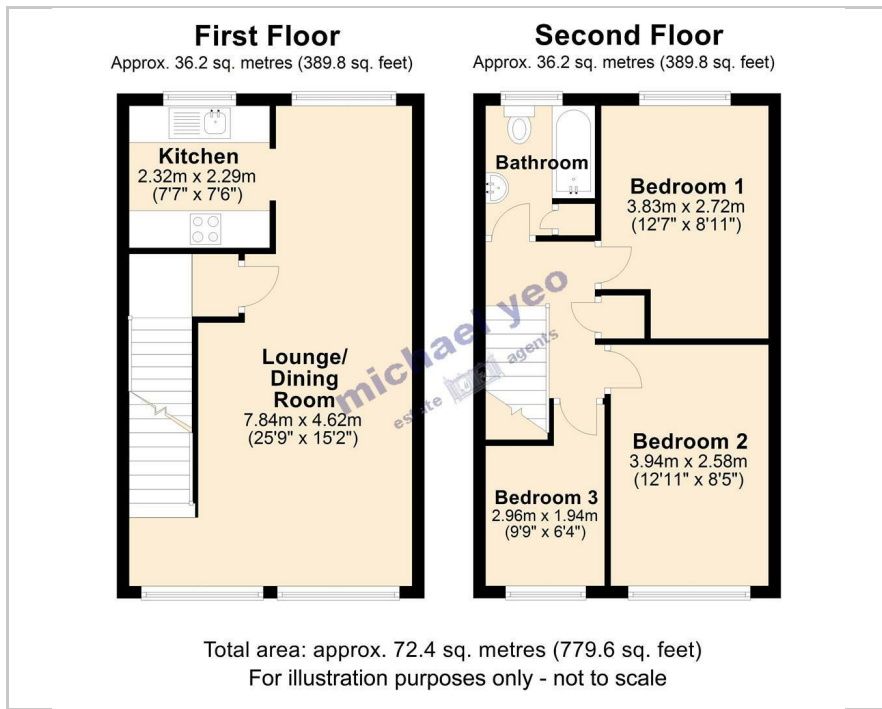

Area Map



Energy Efficiency Graph

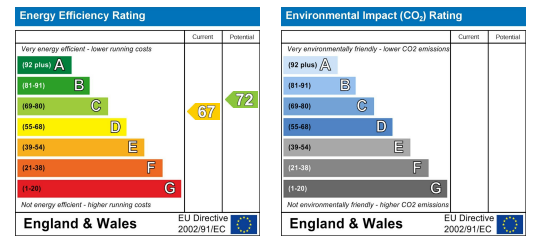

These particulars, whilst believed to be accurate are set out as a general outline only for guidance and do not constitute any part of an offer or contract. Intending purchasers should not rely on them as statements of representation of fact, but must satisfy themselves by inspection or otherwise as to their accuracy. No person in this firm's employment has the authority to make or give any representation or warranty in respect of the property.