



9 Bury Walk, Bedford, MK41 0DU



9 Bury Walk
Bedford
MK41 0DU

Price £375,000

Beautifully presented three
bedroom home with no
upward chain...

Semi-detached home

Large living/dining room

Modern kitchen with views over the
garden

Conservatory

Three bedrooms

Recently replaced family bathroom

Beautifully landscaped gardens

Single garage

Parking for at least three cars

No upward chain

Freehold

- Council Tax Band C
- Energy Efficiency Rating TBC



Perfectly positioned for riverside walks and easy access to local shops...



We are delighted to present this beautifully maintained three bedroom home, perfectly positioned for easy access to local shops, scenic walking trails, and Bedford's southern bypass.

Upon entering, you're welcomed by a bright entrance hall with a handy cloakroom. The generous open-plan living and dining area extends the full length of the home, offering a light-filled space perfect for both daily living and entertaining, and flows effortlessly into the conservatory, which provides lovely garden views and direct access outside.

To the rear, the stylishly upgraded kitchen is fitted with high-quality units and offers a generous worktop space, complemented by a large window with lovely views of the mature rear garden.

Upstairs, you'll find three well-proportioned bedrooms, two doubles and a larger than average single providing flexible space for families or guests. The modern family bathroom has been tastefully refurbished to a high standard.

Outside, the west-facing garden is a real retreat, bordered by mature shrubs, trees, and bushes. It offers a variety of areas to relax or dine al fresco. To the front, a large driveway provides off-road parking for at least three vehicles, along with a single garage for additional storage or secure parking.

Further benefits include PVCu double glazed windows, gas central heating and the property is being offered with no upward chain.

Bury Walk is located just off Goldington Road with its junction with Riverfield Drive very well placed for the local Tesco and Waitrose supermarkets and other retail opportunities plus a medical centre and dentist.

There is also convenient access to riverside walks and Bedford's town centre.



Bury Walk, Bedford, MK41

Approximate Area = 1160 sq ft / 107.7 sq m (excludes garage)

For identification only - Not to scale

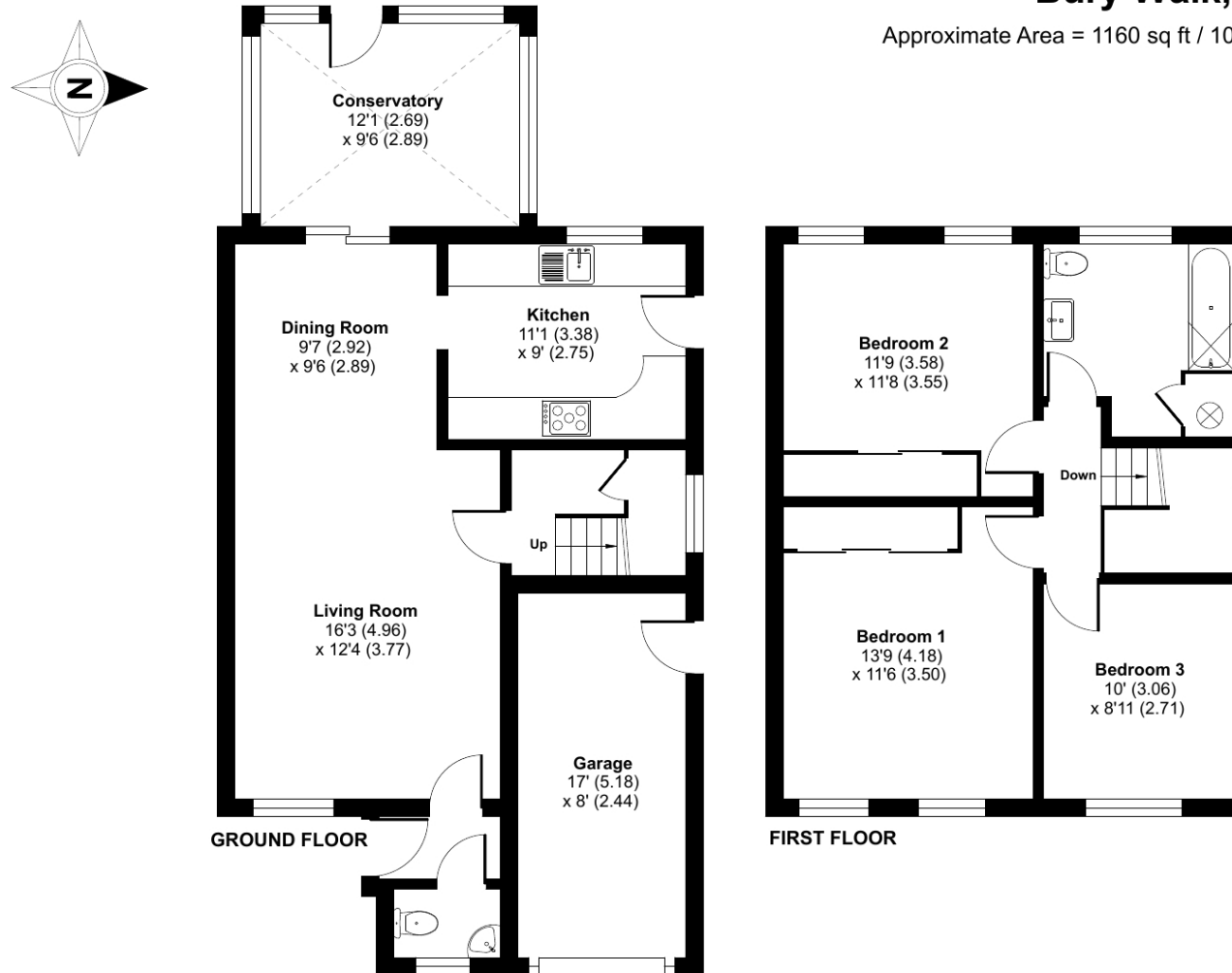

Floor plan produced in accordance with RICS Property Measurement 2nd Edition, Incorporating International Property Measurement Standards (IPMS2 Residential). © n̄checom 2025. Produced for Lane & Holmes. REF: 1326427



01234 327744 | sales@laneandholmes.co.uk | www.laneandholmes.co.uk | 66-68 St Loyes Street, Bedford, Bedfordshire, MK40 1EZ

Agents Notes: The agent has not tested any apparatus, equipment, fixtures & fittings or services and so cannot verify that they are in working order or fit for the purpose. A buyer is advised to obtain verification from their solicitor or surveyor. All photographs shown are for illustration only and may depict items that are not for sale or included in the sale of the property. Please note that we have not checked the situation with regards to planning consents, building regulation consents and any other relevant consent relating to this property and therefore, any interested applicant should carry out their own enquiries with the appropriate authorities. All measurements are approximate and for guidance only. The particulars do not form part of any contract and all properties are offered subject to contract.

