

TOTAL APPROX. FLOOR AREA 503 SQ.FT. (46.7 SQ.M.)
Measurements are approximate. Not to scale. Illustrative purposes only
Made with Metropix ©2021

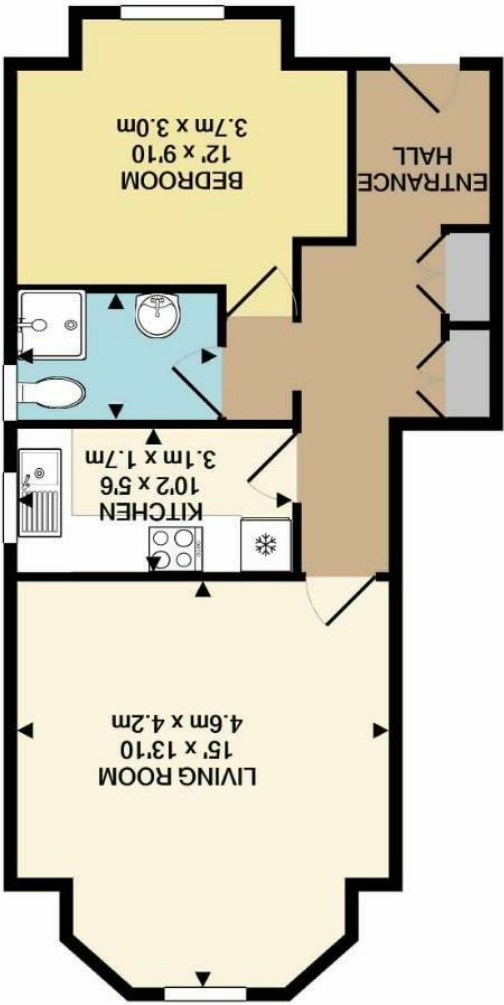

These particulars are believed to be accurate but they are not guaranteed and do not form a contract. Neither Jordan Fishwick nor the vendor or lessor accept any responsibility in respect of these particulars, which are not intended to be statements or representations of fact and any intending purchaser or lessee must satisfy himself by inspection or otherwise as to the correctness of each of the statements contained in these particulars. Any floorplans on this brochure are for illustrative purposes only and are not necessarily to scale.

Offices at: Chorlton, Didsbury, Disley, Hale, Glossop, Macclesfield, Manchester Deansgate, Manchester Whitworth Street, New Mills, Sale, Wilmslow and Withington





Barlow Moor Road, Didsbury
M20 2GJ
£160,000



The Property

A spacious lower ground floor apartment with its own private entrance, forming part of an attractive Victorian conversion which is just a short stroll from Didsbury Village. 503 sq ft. Tastefully presented throughout and boasting both gas central heating and uPVC double glazing, the living space in outline comprises:- Private entrance, entrance hall with cloaks space and excellent fitted storage cupboards, living room to the front with walk-in bay, fitted kitchen, shower room with white suite and tiled walls and a double bedroom with ample space for freestanding furniture. Externally, there are communal grounds, gardens and residents parking to the rear of the building.

Directions

M20 2GJ

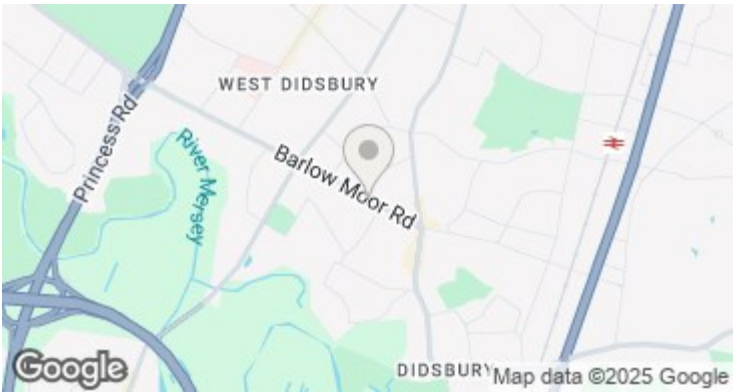

- Spacious apartment
- Living room with walk-in bay
- Fitted kitchen & shower room
- Double bedroom
- Generous entrance hall
- uPVC double glazing
- Gas central heating
- Communal gardens & parking
- Council tax band - A / EPC - C
- No onward chain

Postcode - M20 2GJ
EPC Rating - C
Floor Area - 503.00 sq ft
Local Authority - Manchester City Council
Council Tax - A

