



jordan fishwick

DIDSBURY
Barlow Moor Road



Barlow Moor Road, Didsbury, M20 2GN

Guide Price £300,000



The Property

A most impressive FIRST FLOOR APARTMENT forming part of an EXCLUSIVE DEVELOPMENT which is within a SHORT STROLL of DIDSBUY VILLAGE. Numerous noteworthy features include a balcony, secure underground parking, separate store room and lift access to all floors. The living space is extremely well presented throughout with underfloor heating and double glazed windows, in outline :- Entrance hall, lovely open plan living/kitchen with a comprehensive range of fitted units and granite work surfaces, lounge/dining area and direct access to the balcony, an excellent double bedroom with ample space for freestanding furniture and a luxury modern tiled bathroom with white suite & chrome fittings. *No onward chain*

Directions

M20 2GN



- Impressive first floor apartment
- Exclusive development
- Close to Didsbury Village
- Secure underground parking & storage
- Lift access to all floors
- Generous open plan living/kitchen
- Spacious double bedroom
- Comprehensively fitted kitchen
- Underfloor heating & double glazing
- No onward chain

Postcode - M20 2GN

EPC Rating - B

Floor Area - 507.00 sq ft

Local Authority - Manchester City Council

Council Tax - C



FIRST FLOOR
507 sq.ft. (47.1 sq.m.) approx.

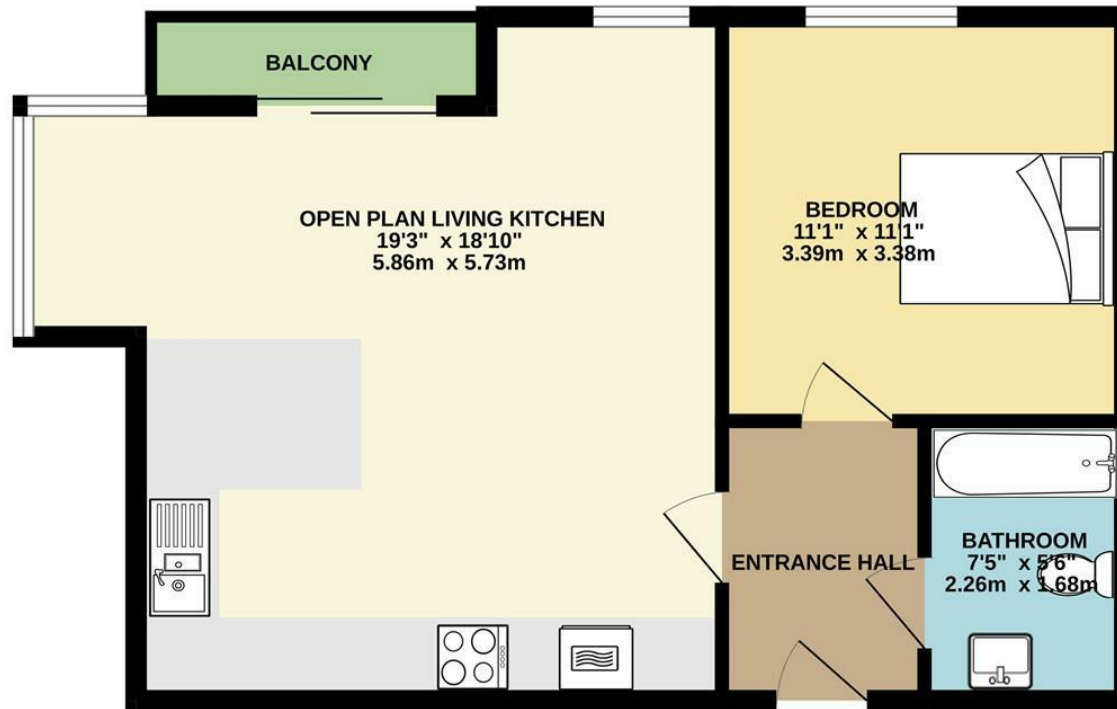

TOTAL FLOOR AREA: 507 sq.ft. (47.1 sq.m.) approx.
Measurements are approximate. Not to scale. Illustrative purposes only
Made with Metropix ©2025



These particulars are believed to be accurate but they are not guaranteed and do not form a contract. Neither Jordan Fishwick nor the vendor or lessor accept any responsibility in respect of these particulars, which are not intended to be statements or representations of fact and any intending purchaser or lessee must satisfy himself by inspection or otherwise as to the correctness of each of the statements contained in these particulars. Any floorplans on this brochure are for illustrative purposes only and are not necessarily to scale.

Offices also at: Wilmslow, Macclesfield, Hale, Sale, Chorlton, Glossop, Manchester & Salford

757-759 Wilmslow Road, Didsbury Village, Manchester

0161 445 4480

didsbury@jordanfishwick.co.uk
www.jordanfishwick.co.uk