



jordan fishwick

WEST DIDSBURY
Montrose Avenue



Montrose Avenue, West Didsbury, M20 2LA

Guide Price £625,000

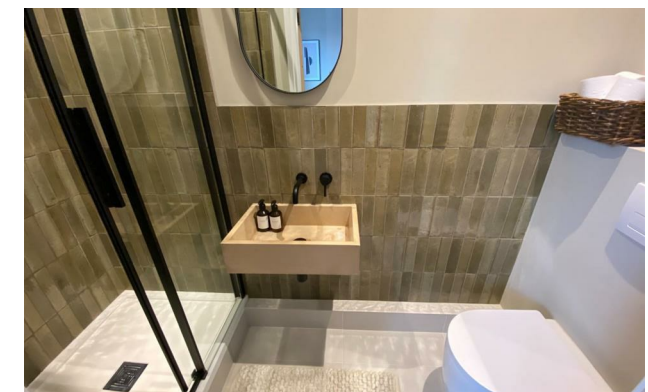

The Property

A beautifully presented, bay fronted, four double bedroom terrace property having been skilfully & tastefully modernised throughout, offering a superb level of living space over four floors which is coupled with a great location on a small cul-de-sac in the heart of Fashionable West Didsbury, just off Burton Road. The vibrant shops, bars and restaurants of West Didsbury, along with the Metrolink are on the doorstep and as such it provides a great opportunity for professionals and families alike. Gas central heating is installed and further complemented by uPVC triple glazing, with the accommodation boasting numerous noteworthy features including a contemporary kitchen with integrated appliances, luxury family bathroom & en-suite shower room, stripped floors and doors, Plantation shutters, useful basement and a south facing courtyard garden.

Directions

M20 2LA



- Beautifully presented terrace
- 'Back to Brick' renovation
- Four double bedrooms
- Luxury bathroom & en-suite
- Contemporary kitchen & appliances
- Useful basement
- uPVC triple glazing & GCH
- Original characteristics throughout
- South facing courtyard garden
- Located in the heart of West Didsbury

Postcode - M20 2LA

EPC Rating - D

Floor Area - 1518.00 sq ft

Local Authority - Manchester City Council

Council Tax - C



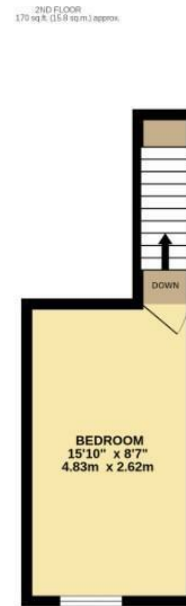
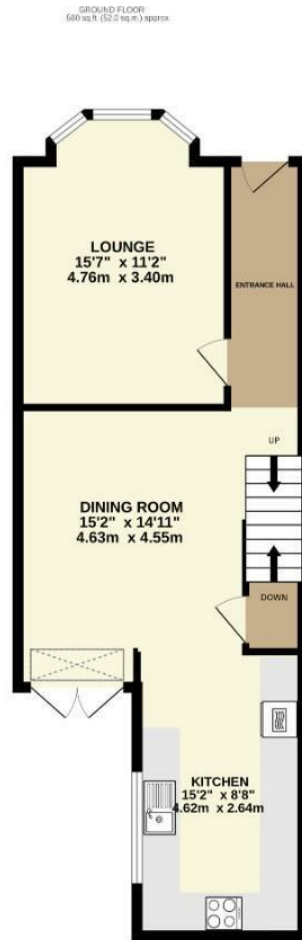
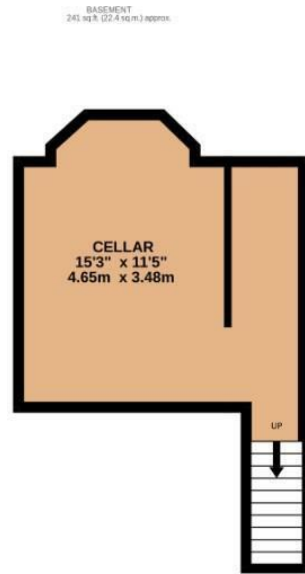

TOTAL FLOOR AREA : 1518 sq.ft. (141.1 sq.m.) approx.
Measurements are approximate. Not to scale. Illustrative purposes only
Made with Metropix ©2024



These particulars are believed to be accurate but they are not guaranteed and do not form a contract. Neither Jordan Fishwick nor the vendor or lessor accept any responsibility in respect of these particulars, which are not intended to be statements or representations of fact and any intending purchaser or lessee must satisfy himself by inspection or otherwise as to the correctness of each of the statements contained in these particulars. Any floorplans on this brochure are for illustrative purposes only and are not necessarily to scale.

Offices also at: Wilmslow, Macclesfield, Hale, Sale, Chorlton, Glossop, Manchester & Salford

757-759 Wilmslow Road, Didsbury Village, Manchester

0161 445 4480

didsbury@jordanfishwick.co.uk
www.jordanfishwick.co.uk