



THE BEECHES
MEWS
NO THROUGH ROAD

BEECH HOUSE

PRIVATE

jordan fishwick

WEST DIDSBURY
Beech House



Beech House, West Didsbury, M20 2AH

£200,000



The Property

A lovely ground floor apartment forming part of a purpose built development in West Didsbury, with easy access to the café's, bars and restaurants on Burton Road. The stylish living space benefits from both uPVC double glazing and electric wall heaters, in outline:- Entrance hallway, living room with pleasant views, modern fitted kitchen, two double bedrooms with ample space for freestanding furniture and bathroom with white suite and chrome fittings. In addition, there is further 'lock-up' storage in the basement, ample residents parking and well tended communal gardens and grounds.

Directions

M20 2AH

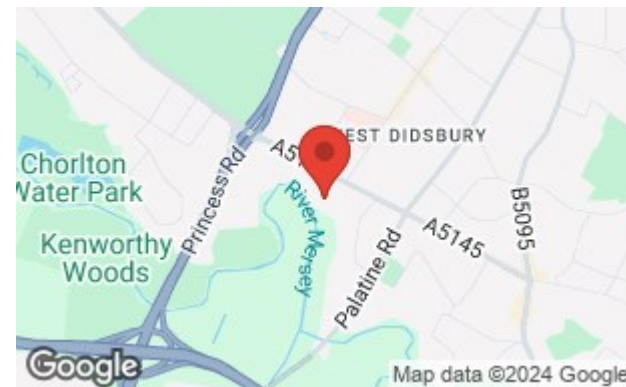

- Two double bedrooms
- Ground floor apartment with pleasant views
- West Didsbury location
- Well tended communal gardens
- Ample storage internally and externally
- Private residents parking for two cars
- No chain
- Council Tax Band - B / EPC - E

Postcode - M20 2AH

EPC Rating - E

Floor Area - 622.00 sq ft

Local Authority - Manchester City Council

Council Tax - B



GROUND FLOOR
622 sq.ft. (57.7 sq.m.) approx.

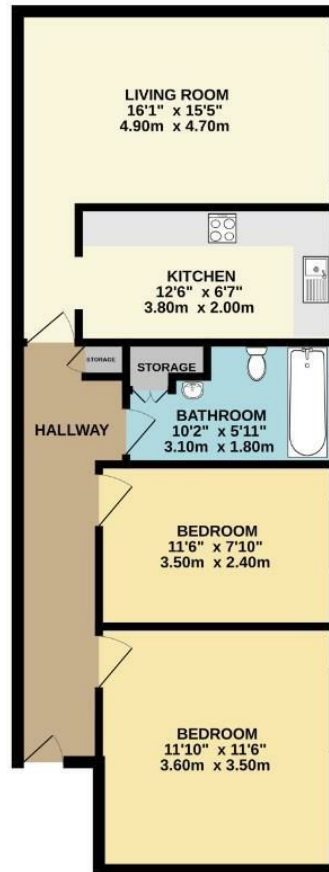

TOTAL FLOOR AREA: 622 sq.ft. (57.7 sq.m.) approx.
Measurements are approximate. Not to scale. Illustrative purposes only
Made with Metropix ©2024



These particulars are believed to be accurate but they are not guaranteed and do not form a contract. Neither Jordan Fishwick nor the vendor or lessor accept any responsibility in respect of these particulars, which are not intended to be statements or representations of fact and any intending purchaser or lessee must satisfy himself by inspection or otherwise as to the correctness of each of the statements contained in these particulars. Any floorplans on this brochure are for illustrative purposes only and are not necessarily to scale.

Offices also at: Wilmslow, Macclesfield, Hale, Sale, Chorlton, Glossop, Manchester & Salford

757-759 Wilmslow Road, Didsbury Village, Manchester

0161 445 4480

didsbury@jordanfishwick.co.uk
www.jordanfishwick.co.uk