



*jordan* fishwick

LONGSIGHT  
Rushford Street





## Rushford Street, Longsight, M12 4WY

Auction Guide £170,000



### The Property

This property is for sale by Modern Method of Auction powered by iamsold LTD - Starting Bid £170,000+ Reservation Fee.

**\*FANTASTIC INVESTMENT OPPORTUNITY\*** - A ground floor retail unit with living space behind, three bedrooms and bathroom above with a enclosed courtyard to the rear, located in a popular residential location, 872 sq ft. The shop comprises of a light & airy retail area with a number of different uses, previously used until recently as a local convenience store servicing the area for many decades, potential to convert to a residential property subject to necessary approval, being sold with no seller chain, an opportunity not to be missed.

### Directions

M12 4WY





- Fantastic Investment Opportunity
- Ground floor retail unit
- Previously used as convenience store
- Lounge & Kitchen
- Three bedrooms and bathroom above
- Popular residential location
- Courtyard to rear
- No chain

**Postcode** - M12 4WY

**EPC Rating** - F

**Floor Area** - 872.00 sq ft

**Local Authority** - Manchester City council

**Council Tax** - A



GROUND FLOOR  
434 sq. ft. (40.3 sq.m.) approx.

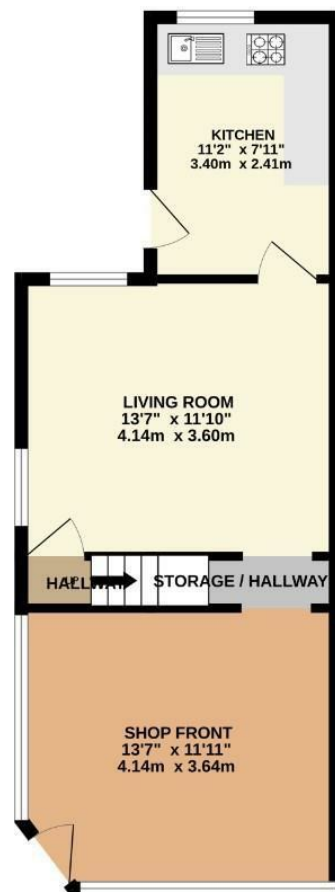

1ST FLOOR  
438 sq. ft. (40.7 sq.m.) approx.



TOTAL FLOOR AREA: 872 sq. ft. (81.0 sq.m.) approx.  
Measurements are approximate. Not to scale. Illustrative purposes only.  
Made with Metropix ©2024



These particulars are believed to be accurate but they are not guaranteed and do not form a contract. Neither Jordan Fishwick nor the vendor or lessor accept any responsibility in respect of these particulars, which are not intended to be statements or representations of fact and any intending purchaser or lessee must satisfy himself by inspection or otherwise as to the correctness of each of the statements contained in these particulars. Any floorplans on this brochure are for illustrative purposes only and are not necessarily to scale.

Offices also at: Wilmslow, Macclesfield, Hale, Sale, Chorlton, Glossop, Manchester & Salford

757-759 Wilmslow Road, Didsbury Village, Manchester

0161 445 4480

didsbury@jordanfishwick.co.uk  
www.jordanfishwick.co.uk