



jordan fishwick

NORTHENDEN
St Hildas Close



St Hildas Close, Northenden, M22 4EP

£269,950



The Property

An appealing FOUR BEDROOM town house being well presented throughout positioned in the heart of NORTHENDEN VILLAGE and located close to THE RIVER MERSEY & NORTHENDEN COMMUNITY SCHOOL. 935 sq ft. The living space is warmed by gas central heating, which is further complemented by double glazing throughout. The property comprises: entrance hall, bedroom 4/study, further double bedroom with en-suite shower room. To the first floor: Large light and spacious lounge/dining room and kitchen fitted with gloss white cupboards, To the second floor: two additional bedrooms both with built in wardrobes. Externally there is a small private garden area to the front, and communal lawned area with sitting areas. No chain.

Directions

M22 4EP



- A four bedroom town house
- Northenden village location
- Two bathrooms
- Double glazing
- Gas central heating
- Light and spacious accommodation
- Gloss white fitted kitchen
- No chain

Postcode - M22 4EP

EPC Rating - C

Floor Area - 935.00 sq ft

Local Authority - Manchester City Council

Council Tax - B



GROUND FLOOR
312 sq.ft. (29.0 sq.m.) approx.

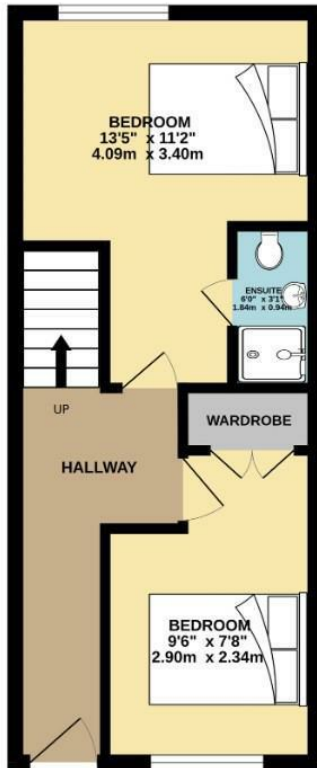

1ST FLOOR
312 sq.ft. (29.0 sq.m.) approx.

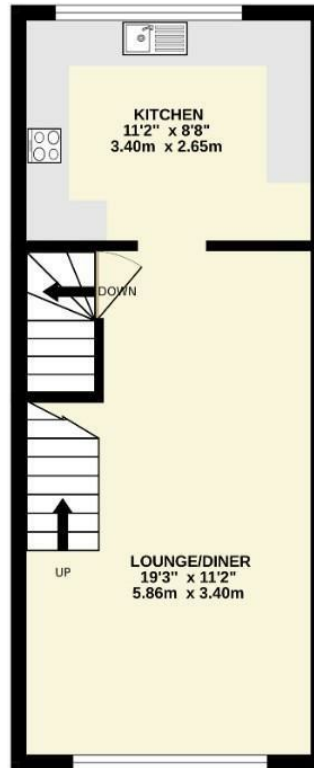

2ND FLOOR
311 sq.ft. (28.9 sq.m.) approx.



TOTAL FLOOR AREA : 935 sq.ft. (86.8 sq.m.) approx.
Measurements are approximate. Not to scale. Illustrative purposes only
Made with Metropix ©2024



These particulars are believed to be accurate but they are not guaranteed and do not form a contract. Neither Jordan Fishwick nor the vendor or lessor accept any responsibility in respect of these particulars, which are not intended to be statements or representations of fact and any intending purchaser or lessee must satisfy himself by inspection or otherwise as to the correctness of each of the statements contained in these particulars. Any floorplans on this brochure are for illustrative purposes only and are not necessarily to scale.

Offices also at: Wilmslow, Macclesfield, Hale, Sale, Chorlton, Glossop, Manchester & Salford

757-759 Wilmslow Road, Didsbury Village, Manchester

0161 445 4480

didsbury@jordanfishwick.co.uk
www.jordanfishwick.co.uk