



jordan fishwick

DIDSBURY
Albert Hill Street



Albert Hill Street, Didsbury, M20 6RF

Offers Over £500,000



The Property

LOCATED IN THE HEART OF DIDSBURY VILLAGE, WITH SECURE OFF ROAD PARKING, A NEW 3 BEDROOM 3 BATHROOM TOWNHOUSE. Offering IMPRESSIVE LIVING SPACE over three floors, coupled with SOUTH FACING courtyard garden. 1100sq ft of light and spacious accommodation. The living space is warmed by gas central heating and further complemented by Anthracite uPVC double glazed windows, in outline the accommodation comprises: A large living room with engineered wood flooring opening to a dining kitchen with central island, high quality integrated appliances, Anthracite bi-fold doors leading to the rear courtyard and cloakroom/wc. To the first floor: Two large double bedrooms one of which enjoys an en suite shower room and family bathroom. To the second floor: Master bedroom with walk in wardrobe area, en suite bathroom and useful eves storage. Secure allocated gated parking completes the impressive specification.

Directions

M20 6RF

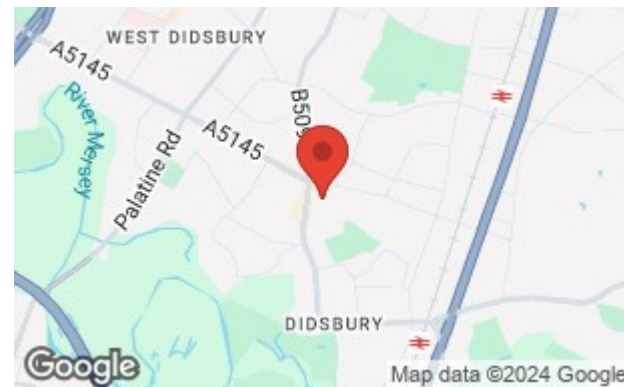

- Didsbury Village location with secure parking
- Master Bedroom with dressing area and en-suite bathroom
- Fully fitted kitchen with central island and bi fold doors
- 3 bedrooms & 3 bathrooms over 3 floors
- South facing courtyard garden
- EV Charging point
- 10 Year new build warranty
- No onward chain

Postcode - M20 6RF

EPC Rating - B

Floor Area - 1100.00 sq ft

Local Authority - Manchester City Council

Council Tax - D



GROUND FLOOR
439 sq.ft. (40.8 sq.m.) approx.

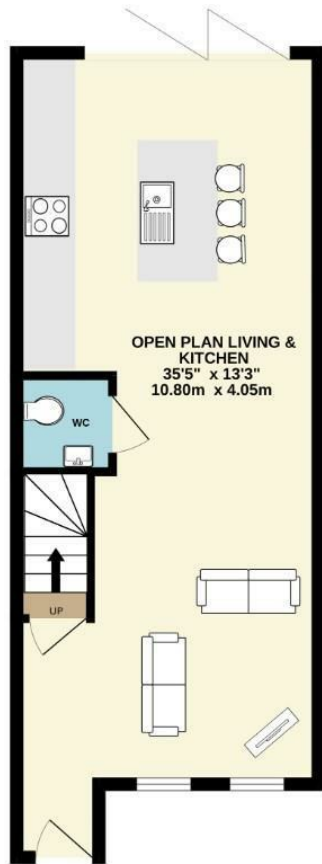

1ST FLOOR
351 sq.ft. (32.6 sq.m.) approx.

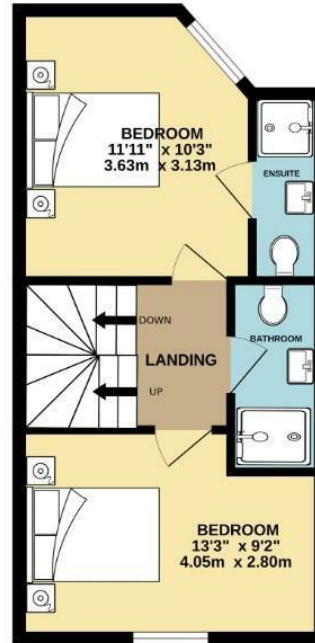

2ND FLOOR
311 sq.ft. (28.9 sq.m.) approx.

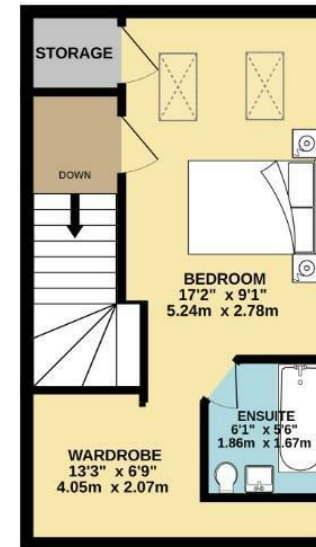

TOTAL FLOOR AREA: 1101 sq.ft. (102.3 sq.m.) approx.
Measurements are approximate. Not to scale. Illustrative purposes only
Made with Metropix ©2024



These particulars are believed to be accurate but they are not guaranteed and do not form a contract. Neither Jordan Fishwick nor the vendor or lessor accept any responsibility in respect of these particulars, which are not intended to be statements or representations of fact and any intending purchaser or lessee must satisfy himself by inspection or otherwise as to the correctness of each of the statements contained in these particulars. Any floorplans on this brochure are for illustrative purposes only and are not necessarily to scale.

Offices also at: Wilmslow, Macclesfield, Hale, Sale, Chorlton, Glossop, Manchester & Salford

757-759 Wilmslow Road, Didsbury Village, Manchester

0161 445 4480

didsbury@jordanfishwick.co.uk
www.jordanfishwick.co.uk