

# Rolfe East



## High Street, W3

Offers In Excess Of £335,000

- First Floor Apartment
- Finish to a High Standard
- Recently refurbished to a high standard
- Two Bedrooms
- Two Bathrooms
- Chain free
- Bright and Spacious
- Good Transport Links Nearby

66 High Street, W3 6LE  
020 8993 7755

acton@rolfe-east.com  
<https://www.rolfe-east.com/>

# Maple Court, W3

Approx. Gross Internal Area 659 Sq Ft - 61.22 Sq M

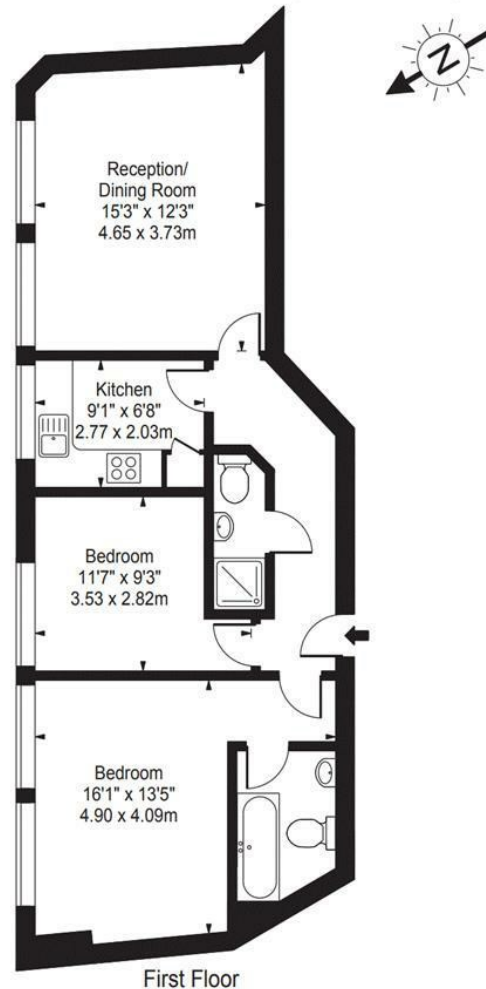

For Illustration Purposes Only - Not To Scale Floor Plan by Mira Nikolova Photography

This floor plan should be used as a general outline for guidance only and does not constitute in whole or in part an offer or contract. Any intending purchaser or lessee should satisfy themselves by inspection, searches, enquiries and full survey as to the correctness of each statement. Any areas, measurements or distances quoted are approximate and should not be used to value a property or be the basis of any sale or let.

## Viewings

Viewings by arrangement only. Call 020 8993 7755 to make an appointment.

## Council Tax Band

C

## EPC Rating:

C

Energy Efficiency Rating		
	Current	Potential
Very energy efficient - lower running costs		
(92 plus) <b>A</b>		
(81-91) <b>B</b>		
(69-80) <b>C</b>	72	76
(55-68) <b>D</b>		
(39-54) <b>E</b>		
(21-38) <b>F</b>		
(1-20) <b>G</b>		
Not energy efficient - higher running costs		
<b>England &amp; Wales</b>	EU Directive 2002/91/EC 