



**3 bedroom  
Detached  
Bungalow  
located in  
Brightlingsea.**

**Asking Price Of  
£495,000**

Find us on..



**JOHN ALEXANDER**  
ESTATE AGENTS



# Plot 5 Weavers Close Church Road Brightlingsea Colchester CO7 0QT



3



2



1



EPC



TBC

## FULL DESCRIPTION

### THE HOME

Welcome to Weavers Close, an extraordinary collection of five beautifully crafted two and three-bedroom bungalows, ideally situated in the coveted coastal town of Brightlingsea, just a stone's throw from Colchester. John Alexander is proud to present this exceptional three-bedroom bungalow, a true embodiment of comfort, style, and modern living.

Upon entering the property, you are greeted by a spacious foyer that sets the tone for the rest of the home. The open-concept layout flows seamlessly from room to room, providing a warm and inviting atmosphere perfect for both relaxation and entertaining. The generous living area features large windows that flood the space with natural light, creating a bright and airy ambiance. This welcoming area is ideal for gathering with family and friends or simply unwinding after a long day.

The heart of the home is undoubtedly the contemporary kitchen, which boasts high-end appliances, sleek countertops, and ample storage space. Designed with both form and function in mind, this kitchen is not only a practical workspace but also a stylish focal point for culinary adventures. Adjacent to the kitchen, you'll find a dining area that is perfect for hosting meals and celebrations, allowing for easy interaction while cooking and entertaining.

The three well-appointed bedrooms are designed to provide a peaceful retreat, each with its unique character and charm. The master suite is particularly impressive, offering a spacious layout with its own en-suite bathroom, ensuring privacy and comfort. The additional bedrooms are versatile, perfect for guests, home offices, or family members, and are serviced by a beautifully designed family bathroom featuring modern fixtures and finishes.

Outside, the bungalow is complemented by a carefully landscaped garden, creating serene outdoor spaces for relaxation and leisure.

### DIMENSIONS

Kitchen/Lounge/Diner

8.36m x 4.42m (27' 5" x 14' 6")

Master Bedroom

3.84m x 3.66m (12' 7" x 12' 0")

En-Suite

2.84m x 1.4m (9' 4" x 4' 7")

Bedroom Two

3.2m x 3.78m (10' 6" x 12' 5")

Bedroom Three

3.35m x 2.82m (11' 0" x 9' 3")

Bathroom

3.2m x 2.1m (10' 6" x 6' 11")



## LOCATION

Nestled on the Essex coast, Brightlingsea town is a picturesque escape, surrounded by natural beauty. Its quaint streets offer a variety of dining, pub, and shopping experiences. Enjoy fresh seafood with harbour views at waterfront restaurants or unwind in cosy English pubs, where you'll find both good food and a warm sense of community.

The town's boutique shops, and artisanal stores cater to all tastes, offering unique crafts, nautical-themed treasures, and fashionable clothing.

As you explore, the stunning coastal backdrop enhances your experience, making it the ideal place for leisurely strolls, culinary adventures, and shopping excursions. Experience the charm of Brightlingsea, where coastal beauty, delectable dining, and retail therapy combine seamlessly.



## FLOORPLAN

### GROUND FLOOR

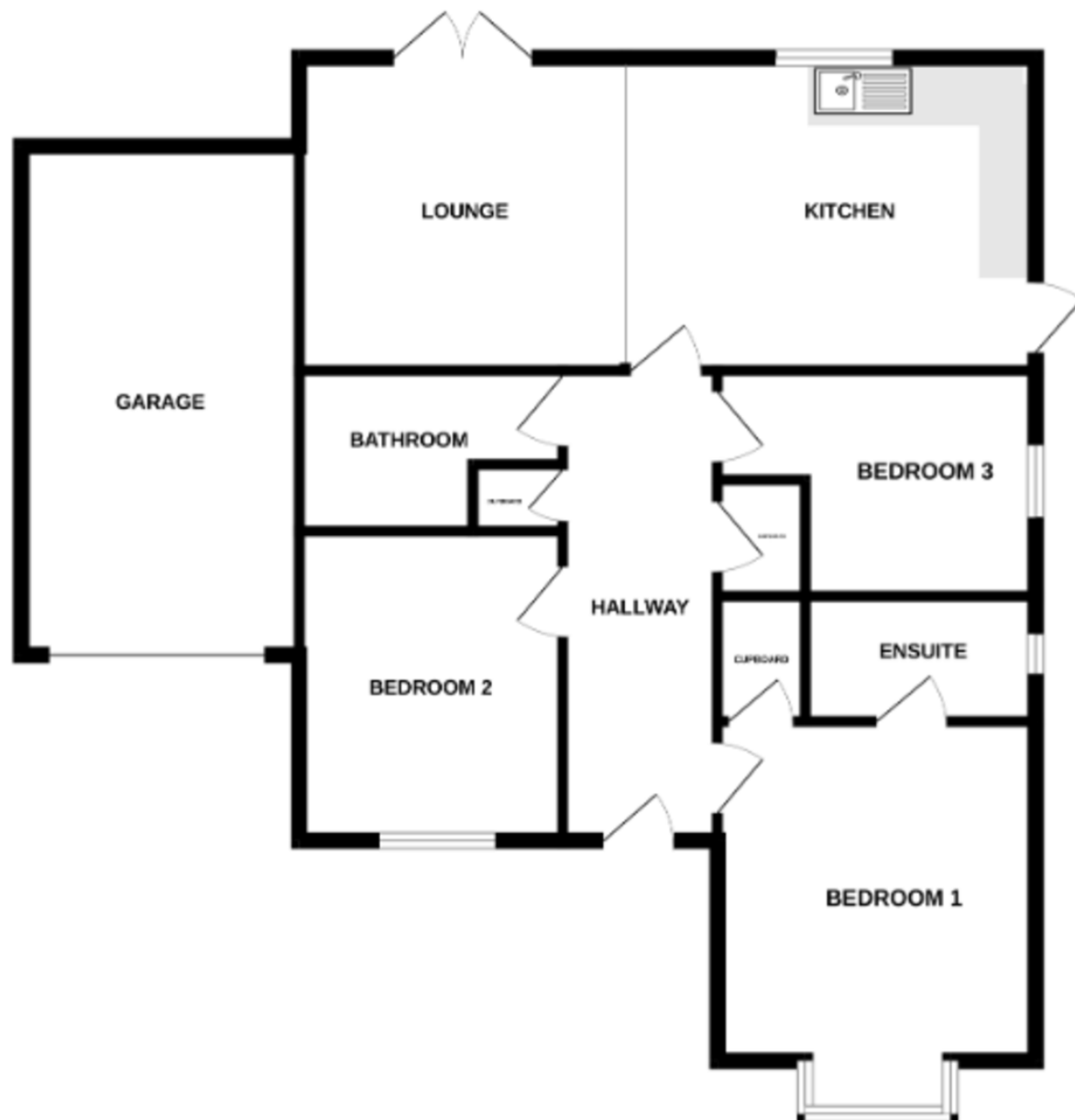

## DIRECTIONS

### CONTACT

**99 London Road**  
**Stanway**  
**Colchester**  
**Essex**  
**CO3 0NY**

E [sales@john-alexander.co.uk](mailto:sales@john-alexander.co.uk)

T 01206 656007

[www.john-alexander.co.uk](http://www.john-alexander.co.uk)

Find us on..

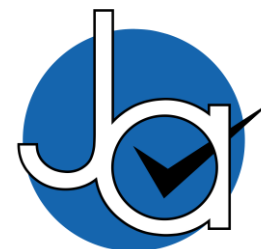

**JOHN ALEXANDER**  
ESTATE AGENTS