



Tyers Estate, SE1

£495,000















# Tyers Estate Bermondsey Street

London, London

Council Tax band: B

Tenure: Leasehold

EPC Energy Efficiency Rating: C

EPC Environmental Impact Rating: C

- Very Convenient location close to Bermondsey Street
- Resident off street parking available
- Quiet and popular location within easy reach of London Bridge station
- Light and bright interior in excellent condition
- Spacious living space with abundant fitted storage
- Fully fitted kitchen
- 2 double bedrooms
- Extensively tiled and bathroom/ w.c
- Double glazed windows
- 125 years from 14/10/2002 ( 102 years unexpired)





# Bermondsey Street, London, SE1

Approximate Area = 574 sq ft / 53.3 sq m

For identification only - Not to scale

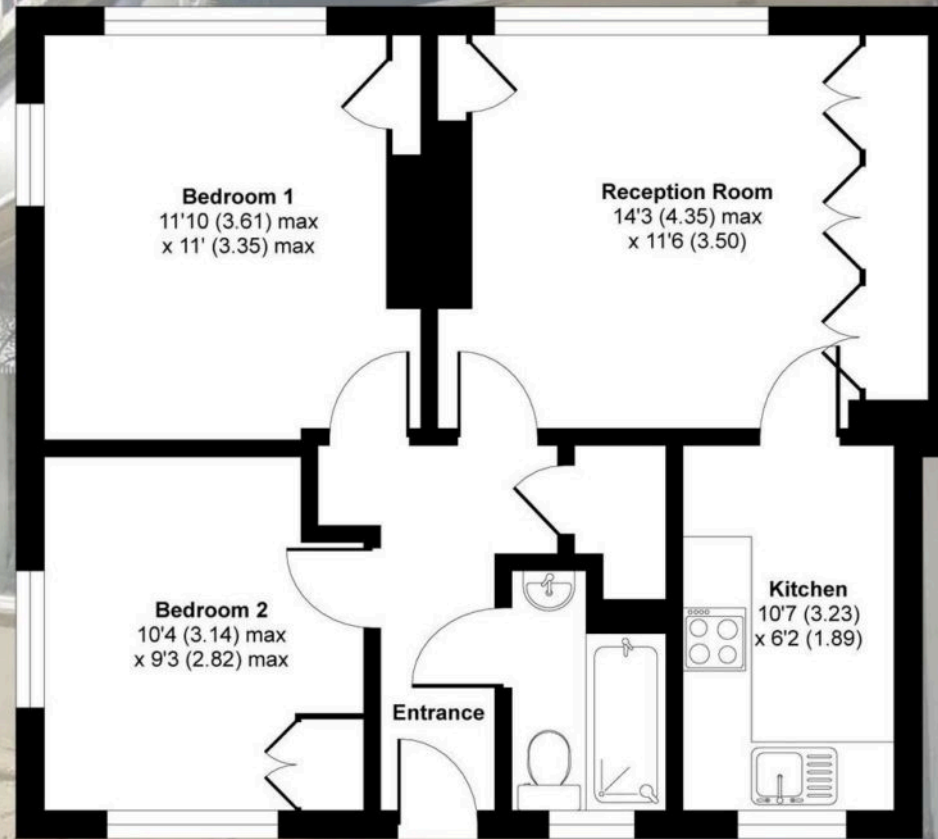

**GROUND FLOOR**



Floor plan produced in accordance with RICS Property Measurement 2nd Edition, Incorporating International Property Measurement Standards (IPMS2 Residential). © n°checon 2025. Produced for Daniel Cobb. REF: 1360047



## Daniel Cobb

Daniel Cobb Estate Agents, 82-84 Bermondsey Street - SE1 3UD

020 7357 0026 • [londonbridge@danielcobb.co.uk](mailto:londonbridge@danielcobb.co.uk) • [www.danielcobb.co.uk/](http://www.danielcobb.co.uk/)