



FOR STARTERS



OFFERS IN EXCESS OF
£133,000

MAIN COURSE

Introducing a well presented one-bedroom first-floor maisonette, available for sale with no chain, conveniently located within easy walking distance to Stratford town centre. Positioned in a quiet cul-de-sac, this property presents an excellent opportunity for first-time buyers, investors, or those seeking a low-maintenance lock-up-and-leave residence.

Upon entering, you are welcomed into a well-appointed kitchen breakfast room, offering ample space for a dining table. The property features a generously sized lounge, providing a comfortable and inviting space. The well-proportioned double bedroom has two built in cupboards, and easily accommodates a king size bed. The bathroom is fitted with a white suite with a bath and shower over.

The age and style of this maisonette contribute to its bright and airy feel, thanks to large windows that allow lots of natural light to fill the space, creating a spacious and welcoming atmosphere.

Externally, the property has on-street parking, ensuring convenience for residents and visitors. Additionally, a brick-built storage shed provides practical solutions for storing belongings, and a dedicated drying area adds to the overall functionality of the residence.

For added peace of mind, the property is offered with a manageable yearly service charge of approximately £1045, and a ground rent of £10 per year. The lease offers a substantial 99 years remaining.



This first-floor maisonette presents an excellent opportunity to acquire a well-maintained property in a sought-after location. Whether you are a first-time buyer, an investor, or someone in search of a convenient lock-up-and-leave, this property is sure to meet your needs. Arrange a viewing today to experience the comfortable and practical living spaces this maisonette has to offer.

KEY INGREDIENTS



Tenure
Leasehold



Council Tax
Band - B



EPC
Band - C



East Facing



Mains Services
Gas, Electric,
Water



Heating System
Gas Central Heating



Stratford Primary
School

WHY NOT TAKE
A LOOK INSIDE?
GIVE US A CALL
01789 414222



First Floor Apartment

Approx. 45.6 sq. metres (490.8 sq. feet)

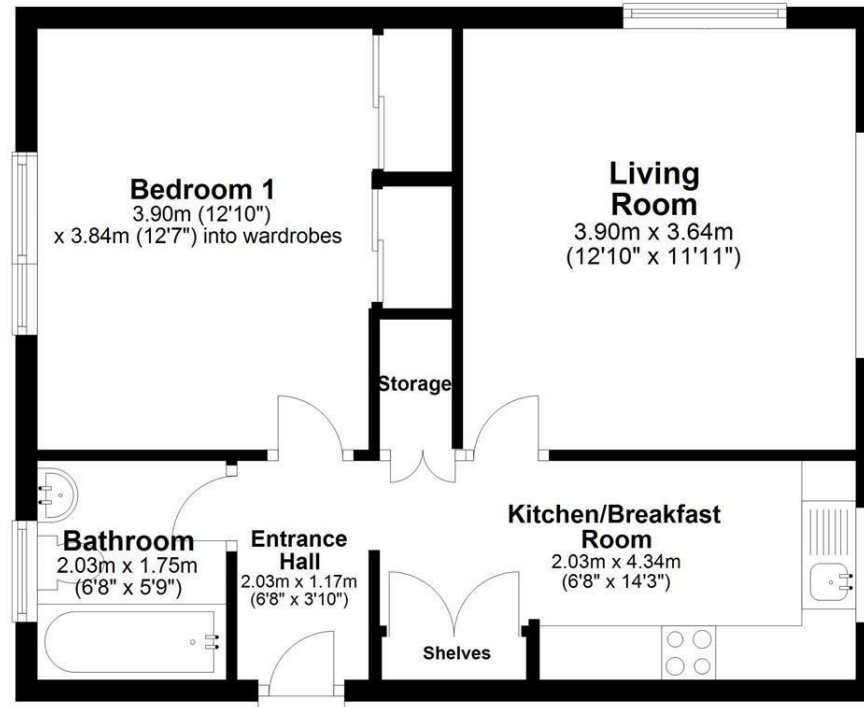

Total area: approx. 45.6 sq. metres (490.8 sq. feet)

Floor plans are intended to give a general indication of the proposed layout. Details and measurements within are not intended to form part any contract.

Plan produced using PlanUp.

**FOR MORE INFO AND
TO SEE OUR OTHER
LOVELY PROPERTIES
CHECK OUT OUR WEBSITE**

MOVEWITHEDWARDS.CO.UK

**HAVE YOU GOT
A PROPERTY
TO SELL?
WE'D LOVE TO
HAVE A CHAT
01789 414222**

**DID YOU KNOW WE ALSO
DO MORTGAGES.
FOR FREE ADVICE
SPEAK TO
ONE OF OUR
CONSULTANTS**

