

**TO LET**



**Elton Fold Chase, Bury, BL8 1PW**  
**£895 pcm**

  
**MARTIN&CO**

## Elton Fold Chase, Bury, BL8 1PW

Date available: 5th March 2021

Deposit: £1,032.69

Unfurnished

Council Tax band: C

### • MODERN THREE BEDROOM DETACHED FAMILY HOME

- Holding Deposit- £206.53
- Security Deposit- £1,032.69
- Driveway & Integral Garage
- En-Suite to Master Bedroom
- Good Sized Rear Garden
- Modern Fitted Kitchen / Diner

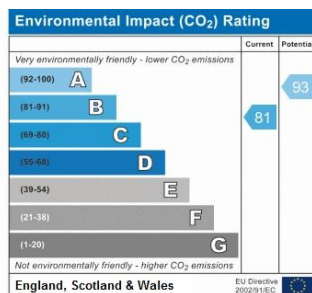
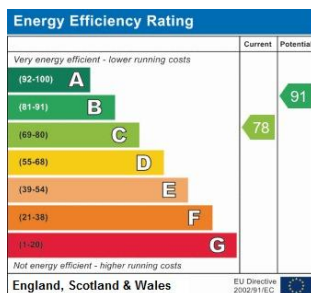

MODERN DETACHED FAMILY HOME - DRIVEWAY - INTEGRAL GARAGE - ENSUITE TO MASTER  
- DOWNSTAIRS WC - GOOD SIZE REAR GARDEN - POPULAR RESIDENTIAL DEVELOPMENT

#### Ground Floor

Lounge  
4929 x 3134mm  
(16'2" x 10'3")

Kitchen/  
Dining Room  
5751 x 2340mm  
(18'10" x 7'8")

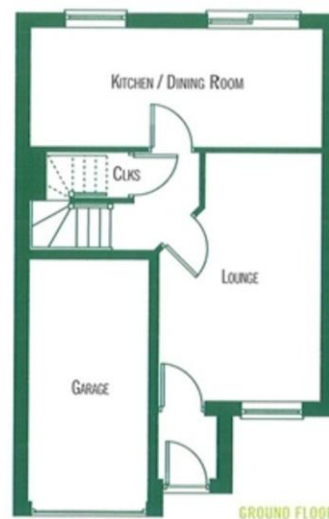

#### First Floor

Master Bedroom  
4239 x 2899mm  
(13'11" x 9'6")

Bedroom 2  
3432 x 2659mm  
(11'3" x 8'9")

Bathroom  
2659 x 1726mm  
(8'9" x 5'8")

En-suite  
2098 x 1425mm  
(6'11" x 4'8")

Bedroom 3  
3005 x 2407mm  
(9'10" x 7'11")

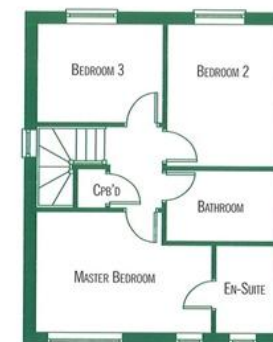

FIRST FLOOR

## Martin & Co Rochdale

15b Cheetham Street • Rochdale • OL16 1DG  
T: 01706 648277 • E: rochdale@martinco.com

01706 648277

rochdale.martinco.com



**Accuracy:** References to the Tenure of a Property are based on information supplied by the Seller. The Agent has not had sight of the title documents. A Buyer is advised to obtain verification from their Solicitor. Items shown in photographs including but not limited to carpets, fixtures and fittings are not included unless specifically mentioned within the sales particulars. They may however be available by separate negotiation. Buyers must check the availability of any property and make an appointment to view before embarking on any journey to see a property. No person in the employment of the agent has any authority to make any representation about the property, and accordingly any information given is entirely without responsibility on the part of the agents, sellers(s) or lessors(s). Any property particulars are not an offer or contract, nor form part of one. **Sonic / Laser Tape:** Measurements taken using a sonic / laser tape measure may be subject to a small margin of error. **All Measurements:** All Measurements are Approximate. **Services Not tested:** The Agent has not tested any apparatus, equipment, fixtures and fittings or services and so cannot verify that they are in working order or fit for the purpose. A Buyer is advised to obtain verification from their Solicitor or Surveyor.