

Juniper Drive, Battersea Reach



£1,850pcm

- Viewings Seven Days A Week Including Bank Holidays!
- Located In The Prestigious Battersea Reach Development
- Just Moments From The River Thames
- Incredible Local Amenities Within Walking Distance
- Available To Move Into Middle Of August 2022
- Lift, 24hr Concierge, Gym & More



With Over 100 Apartments With A Lift Access

Floorplan

Jasmine House, SW18

Approximate gross internal area
45.15 sq m / 486 sq ft

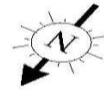

Key :
CH - Ceiling Height

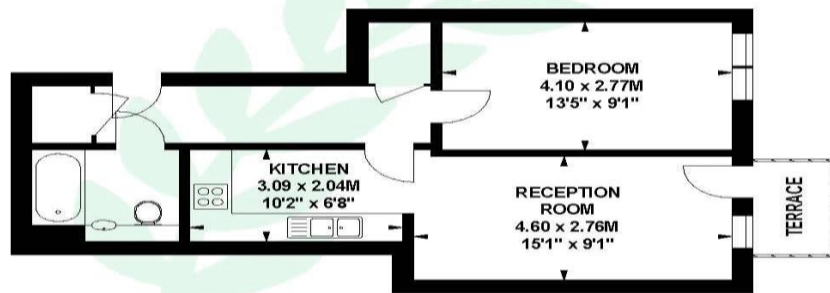

Third Floor



Whilst every attempt has been made to ensure the accuracy of the floor plan contained here, this plan is for representation purposes only and should be used as such. Any figure is for guidance only and should not be relied on as a basis for valuation. Floor plan produced by Licaria Services Ltd for Laurels Estate Agents Ltd. ©



Contact Us

If you would like a free **sales** or **lettings** valuation, please let our team know. We are available 7 days a week from 8am to 8pm.

South London Hub
Sales and Lettings
020 8191 8410
southlondon@laurels.co.uk

South West London Hub
Sales and Lettings
020 8191 7400
southwestlondon@laurels.co.uk

Disclaimer (Ep2)

These particulars are believed to be correct and have been verified by or on behalf of the Vendor. However, any interested party will satisfy themselves as to their accuracy and as to any other matter regarding the Property or its location or proximity to other features or facilities which is of specific importance to them. Distances and areas are only approximate and unless otherwise stated fixtures contents and fittings are not included in the sale. Prospective purchasers are always advised to commission a full inspection and structural survey of the Property before deciding to proceed with a purchase.