

Bluebell

ESTATES



15, Sandlewood Court, Maidstone, ME16 0ZG

£160,000

About this property.....

A competitively priced two bedroom apartment with the benefit of no onward chain.

This first floor property is in need of some cosmetic improvement but is ideally located for Maidstone Hospital and would be an ideal investment property for anyone looking to add to their portfolio. The property has an open plan living room - kitchen and there are two good sized bedrooms.

The property also has its own allocated parking space and there is the remainder of a 125 year lease (approx 108 years).

For more information or to arrange a viewing please get in touch.

Situation.....

This development is ideally situated for Maidstone Hospital, the Oakwood Park Schools complex and West Borough Primary school which was rated as Good by Ofsted in the latest inspection.

Maidstone is the County town of Kent and as such boasts extensive retail, entertainment and leisure facilities. The nearby Barming station offers journey times to London Victoria in just over 1 hour and the property is within easy reach of J5 of the M20.







Remainder of a 125 year lease from 2007 (approximately 107 years remaining)
Service Charge = £298 per month
Ground Rent = TBC

1 Allocated Parking Space
Chain Free

15, Sandewood Court, Maidstone, ME16 0ZG

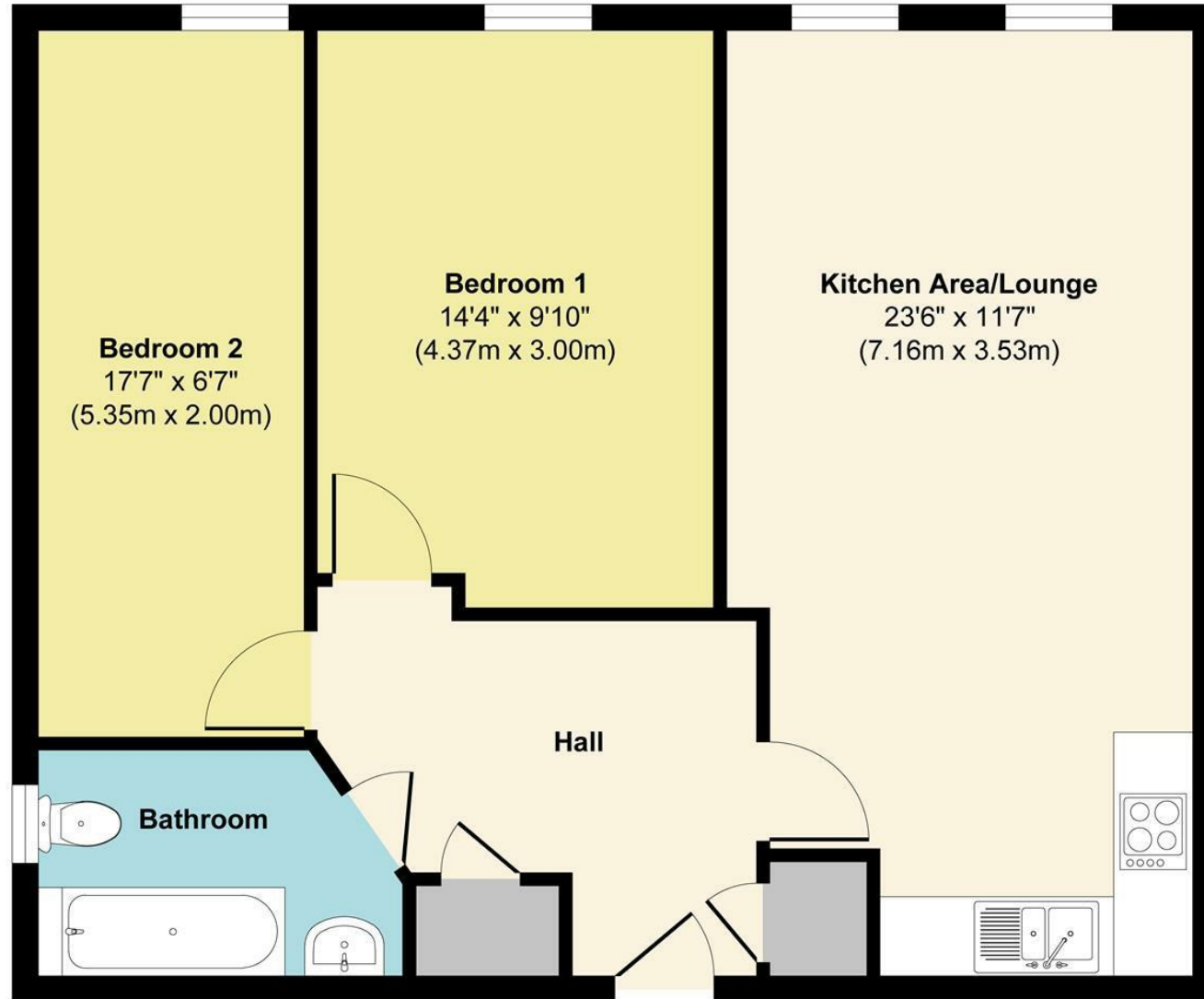

Floor Plan

Approx. Gross Internal Floor Area 673 sq. ft / 62.59 sq. m

Illustration for identification purposes only. measurements are approximate, not to scale.

Produced by Elements Property

Agents Notes

Floor plans produced for illustrative purposes only. The position and sizes of doors, windows, rooms and other items are approximate and no responsibility is taken for any error, omission or mis-statement. These particulars are produced for information only and do not form part of any contract. The agent has not had sight of any title documents. Fixtures, fittings and services not tested.



