



## NOTTINGHAMS YARD

BULWICK, NN17 3EU

£880,000  
FREEHOLD

A beautifully renovated, four-bedroomed equestrian home with stunning countryside views, sitting in approximately three acres of paddock land complete with stables, hay barn and tack room, nestled on the outskirts of the charming village of Bulwick. An additional approximate 1 acre of land is available to buy or rent by separate negotiation.

**Woodford & Co.**  
PROPERTY CONSULTANTS & AUCTIONEERS

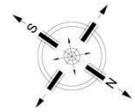

**Banbury Lodge, Bulwick**  
**Main House = 197 sq.m/2120 sq.ft**  
**Garage = 26 sq.m/282 sq.ft**  
**Outbuilding = 52 sq.m/560 sq.ft**  
**Total = 275 sq.m/2960 sq.ft**

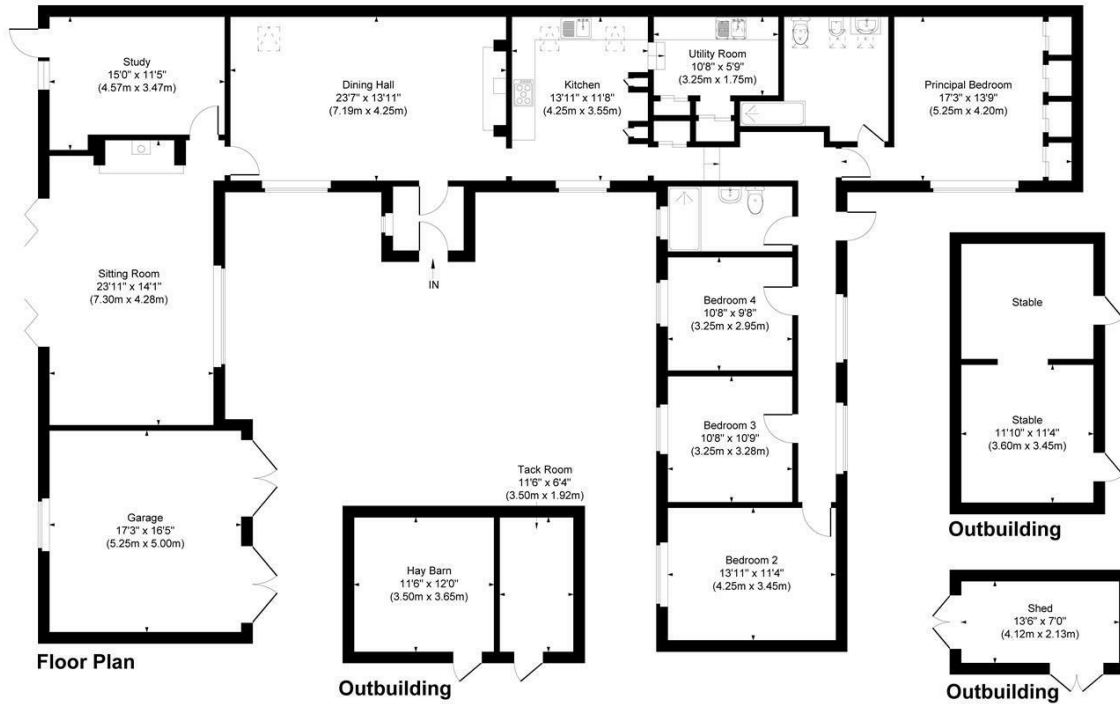
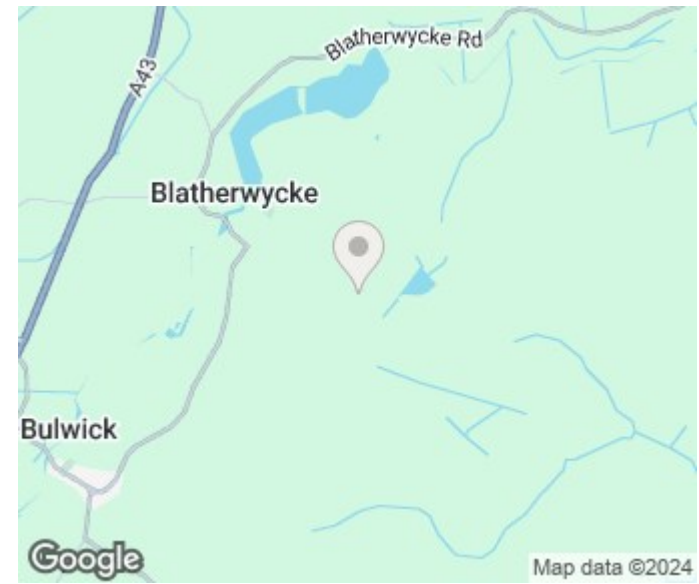

Illustration for identification purposes only, measurements are approximate, not to scale.  
 JonHolmesPhotography © 2024



Energy Efficiency Rating		Current	Potential
Very energy efficient - lower running costs			
(92 plus) <b>A</b>			
(81-91) <b>B</b>			
(69-80) <b>C</b>			
(55-68) <b>D</b>		54	67
(39-54) <b>E</b>			
(21-38) <b>F</b>			
(1-20) <b>G</b>			
Not energy efficient - higher running costs			
<b>England &amp; Wales</b>		EU Directive 2002/91/EC	

Agents Note: Whilst every care has been taken to prepare these particulars, they are for guidance purposes only. All measurements are approximate and are for general guidance purposes only and whilst every care has been taken to ensure their accuracy, they should not be relied upon and potential buyers/tenants are advised to recheck the measurements

Woodford and Company  
 12 Market Place  
 Oundle  
 Peterborough  
 PE8 4BQ

01832 274732  
 info@woodfordandco.com

**Woodford & Co.**  
 PROPERTY CONSULTANTS & AUCTIONEERS