



9 WESTMORELAND CLOSE  
NASSINGTON, PE8 6QR

£550,000  
FREEHOLD

A spacious family home with four double bedrooms and three receptions rooms, occupying a generous plot, in a popular village.

**Woodford & Co.**  
PROPERTY CONSULTANTS & AUCTIONEERS

Approximate Gross Internal Area  
202 Sq M/2173 Sq Ft

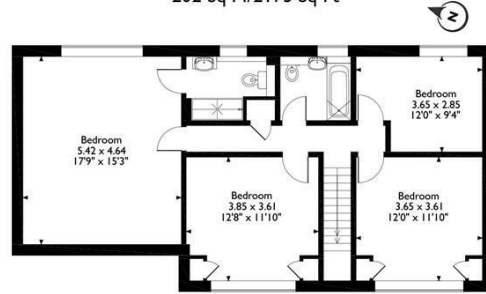

First Floor



Ground Floor

Please note that the location of doors, windows and other items are approximate and this floorplan is to be used for illustrative purposes only. Unauthorized reproduction is prohibited.



Energy Efficiency Rating		Current	Potential
Very energy efficient - lower running costs			
(92 plus) <b>A</b>			
(81-91) <b>B</b>			
(69-80) <b>C</b>			
(55-68) <b>D</b>			
(39-54) <b>E</b>		45	
(21-38) <b>F</b>			
(1-20) <b>G</b>			
Not energy efficient - higher running costs			
<b>England &amp; Wales</b>		EU Directive	
		2002/91/EC	

Agents Note: Whilst every care has been taken to prepare these particulars, they are for guidance purposes only. All measurements are approximate and are for general guidance purposes only and whilst every care has been taken to ensure their accuracy, they should not be relied upon and potential buyers/tenants are advised to recheck the measurements

Woodford and Company  
12 Market Place  
Oundle  
Peterborough  
PE8 4BQ

01832 274732  
info@woodfordandco.com

**Woodford & Co.**  
PROPERTY CONSULTANTS & AUCTIONEERS