



12 NORTH STREET OUNDLLE, PE8 4AL

£850,000
FREEHOLD

A striking Grade II* Listed property, dating from 1641, offering beautiful, three storey accommodation with up to five bedrooms, courtyard garden and outbuildings set within a few yards of the Market Place and enjoying views of St Peter's Church.

Woodford & Co.

PROPERTY CONSULTANTS & AUCTIONEERS

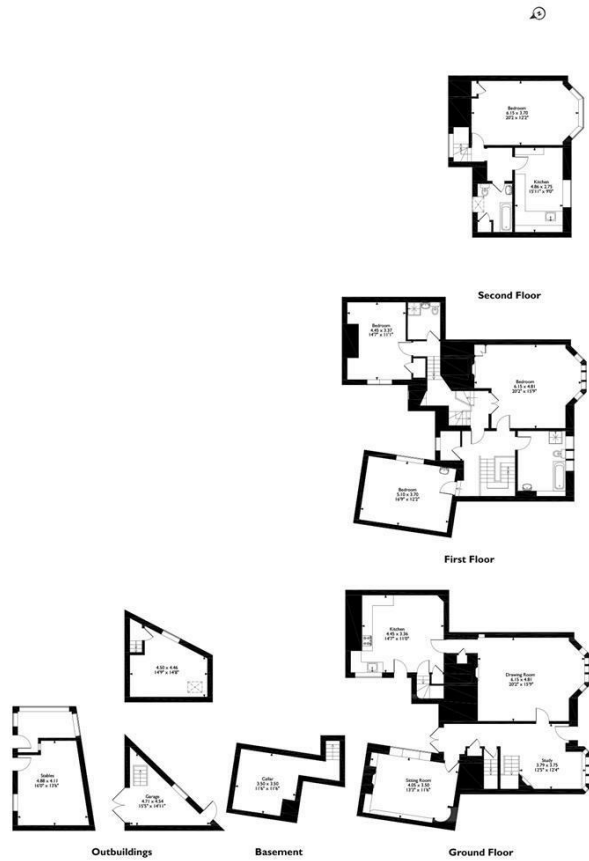

Total Approx Gross Internal Floor Area = 333 Sq/m - 3583 Sq/ft
 FOR IDENTIFICATION PURPOSES ONLY - NOT TO SCALE - REF = 8617469 - © www.homeplansepc.co.uk 2016



Agents Note: Whilst every care has been taken to prepare these particulars, they are for guidance purposes only. All measurements are approximate and are for general guidance purposes only and whilst every care has been taken to ensure their accuracy, they should not be relied upon and potential buyers/tenants are advised to recheck the measurements

Woodford and Company
 12 Market Place
 Oundle
 Peterborough
 PE8 4BQ

01832 274732
info@woodfordandco.com

Woodford & Co.
 PROPERTY CONSULTANTS & AUCTIONEERS