



**3 DRAPERS CLOSE**

WARMINGTON | PE8 6UQ

**£335,000**

**Woodford & Co.**  
PROPERTY CONSULTANTS & AUCTIONEERS

3 Drapers Close, Warmington, PE8 6UQ

An established bungalow with three bedrooms, garage and garden, set within a popular village with shop and popular pub. No onward chain.

Hall | Lounge / diner | Kitchen | Conservatory  
Three Bedrooms | Bathroom  
Front & Rear Gardens | Garage | Parking

### The Property

An established three-bedroom detached bungalow with well-presented accommodation that benefits from central heating and uPVC double glazed windows.

The front door opens to the porch which then leads through to the hall. The large, dual aspect lounge diner is to one side and has a view over the front and rear gardens.

The kitchen has been re-fitted with a range of wall and base units with worksurfaces over. There is an electric oven and hob, with an extractor hood above. The washing machine and fridge freezer are included in the sale. A door leads into the conservatory which is sufficiently large to offer space for formal dining and relaxation, if desired. Doors open to the garden.

The three bedrooms are set along the inner hall. There are two double bedrooms, one with a view to the front and the other with a view over the rear garden. The third bedroom is a single room and could serve as a useful study. The bathroom offers a bath with shower above. The WC is separate.

The bungalow sits back from the roadside behind an open front garden. A paved path leads from the front door to the drive, which offers parking in front of the garage., which is accessed via a roller door and has power and light connected.

The rear garden is low maintenance offering a large patio that captures the afternoon and evening sunshine.



**Services**

Mains water, drainage and electricity. Oil-fired central heating.

**EPC**

Band E

**Council Tax**

Band C

**Tenure**

Freehold with vacant possession.

**Local Authority**

North Northants Council

**Viewing**

Strictly by appointment with Woodford & Co  
01832 274732.



## Ground Floor

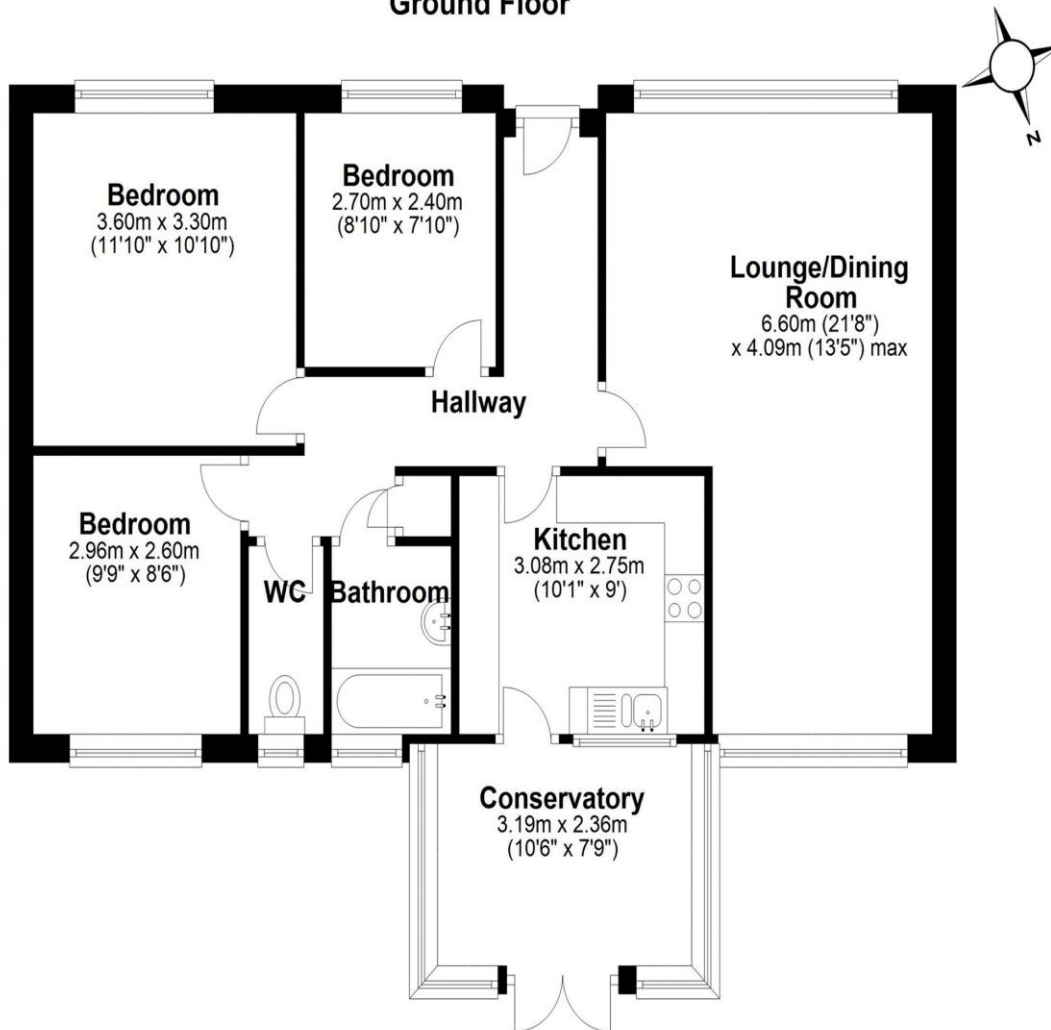

**Total Approx Gross Internal Floor Area = 82 sq/m (884 sq/ft)**

**FOR IDENTIFICATION PURPOSES ONLY - NOT TO SCALE**

**Note:** Woodford & Co for themselves and for the Vendors of this property, whose agents they are, give notice that:

The particulars are intended to give fair and substantially correct description for the guidance of intending purchasers and do not constitute, nor constitute part of an offer or contract. No responsibility is assumed for the accuracy of individual items.

All descriptions, dimensions, areas, references to condition and necessary permission for use and occupation and their details are given in good faith and are believed to be correct but any intending purchaser should not rely on them as statements or representations of fact, but must satisfy themselves by inspection or otherwise as to the correctness of each of them;

No person in the employment of Woodford & Co has any authority to make or give any representations or warranty whatever in relation to this property or these particulars nor enter into any contract relating to the property on behalf of the vendor;

No responsibility can be accepted for any expenses incurred by intending purchasers in inspecting properties which have been sold, let or withdrawn.

**Woodford & Co.**

PROPERTY CONSULTANTS & AUCTIONEERS

**12 Market Place, Oundle, PE8 4BQ.**

**T 01832 274732 E [info@woodfordandco.com](mailto:info@woodfordandco.com)**

**and in Mayfair at Cashel House, 15 Thayer Street, London, W1U 3JT.**