

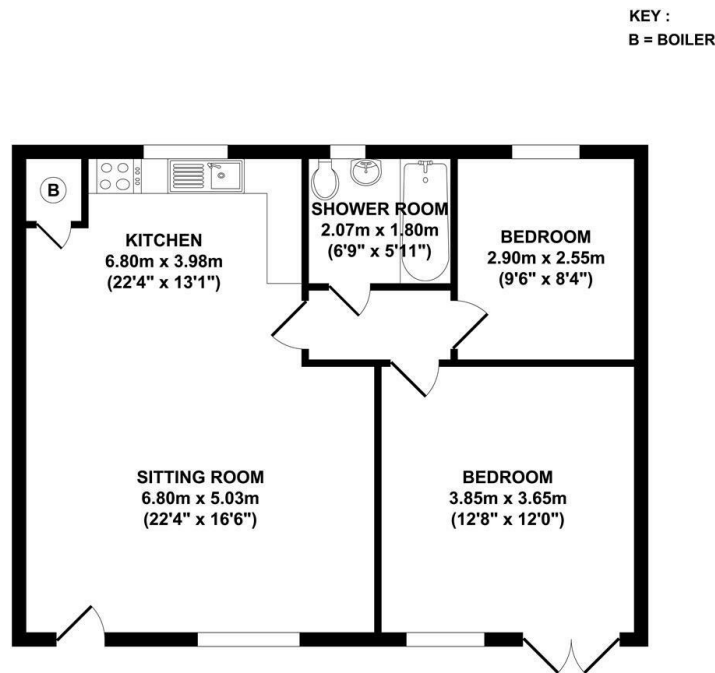

## 15 Wood Drive, Kegworth, DE74 2AA

£140,000

- Ground floor flat
- Allocated parking
- Located on a modern estate
- Ideal first time buy or buy to let
- 2 double bedrooms
- Private access with it's own front door
- No through traffic
- Open plan living/dining/kitchen
- Modern bathroom with white suite
- Close to local walks and amenities



Whilst every attempt has been made to ensure the accuracy of the floor plan contained here, measurements of doors, windows, rooms and any other items are approximate and no responsibility is taken for any error, omission, or mis-statement. This plan is for illustrative purposes only and should be used as such by any prospective purchaser. The services systems and appliance shown have not been tested and no guarantee as to their operability or efficiency can be given.

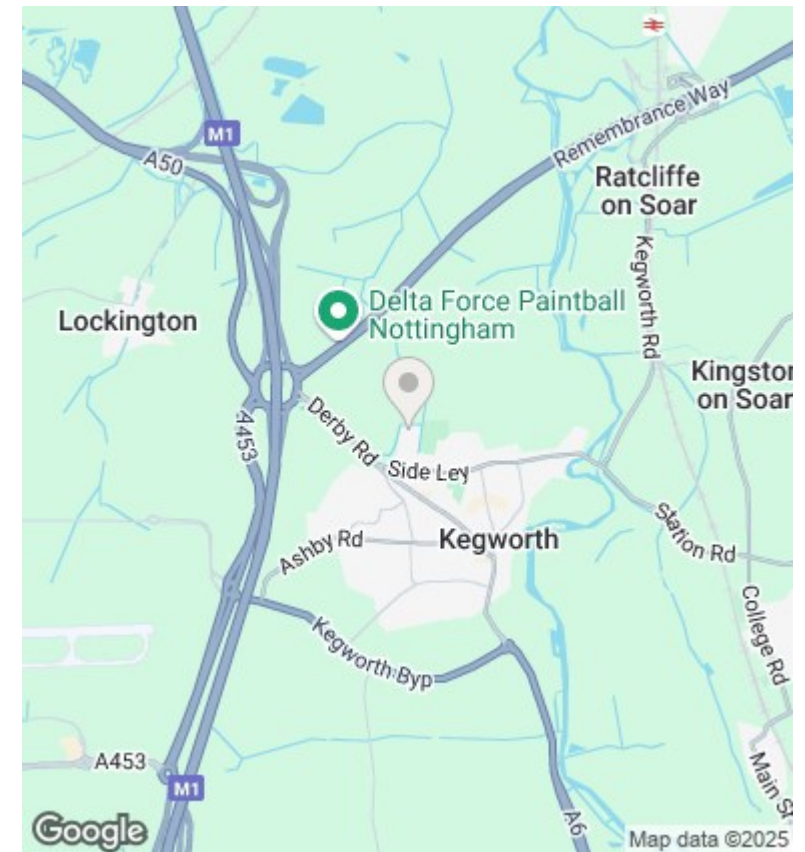

## Directions

## Viewings

Viewings by arrangement only. Call 01509 674140 to make an appointment.

## Council Tax Band

A

## EPC Rating:

Energy Efficiency Rating		
	Current	Potential
Very energy efficient - lower running costs		
(92 plus) <b>A</b>		
(81-91) <b>B</b>		
(69-80) <b>C</b>		
(55-68) <b>D</b>		
(39-54) <b>E</b>		
(21-38) <b>F</b>		
(1-20) <b>G</b>		
Not energy efficient - higher running costs		
<b>England &amp; Wales</b>	EU Directive 2002/91/EC	