

24 Pleasant Place, Kegworth, Derby, DE74 2DD

£1,185 PCM

- April Cohort
- 3 bedrooms
- Garden with lockable shed
- Adjacent parking
- Furnished
- Breakfast kitchen with pantry
- Lounge
- White goods included
- Local landlady
- Close to village centre

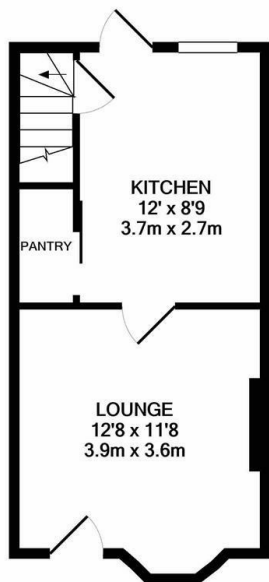

GROUND FLOOR
APPROX. FLOOR
AREA 275 SQ.FT.
(25.5 SQ.M.)

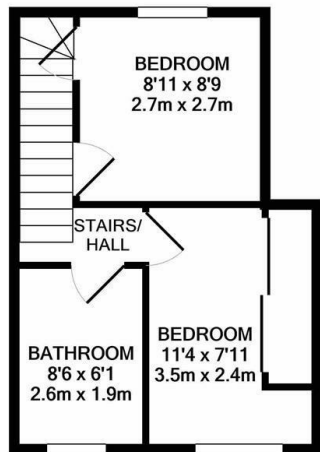

1ST FLOOR
APPROX. FLOOR
AREA 263 SQ.FT.
(24.5 SQ.M.)

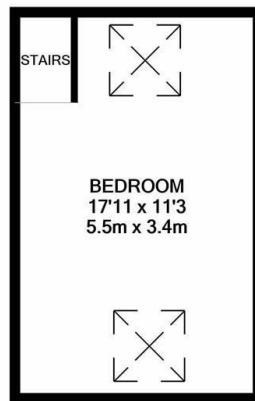

2ND FLOOR
APPROX. FLOOR
AREA 202 SQ.FT.
(18.8 SQ.M.)

TOTAL APPROX. FLOOR AREA 740 SQ.FT. (68.8 SQ.M.)

Whilst every attempt has been made to ensure the accuracy of the floor plan contained here, measurements of doors, windows, rooms and any other items are approximate and no responsibility is taken for any error, omission, or mis-statement. This plan is for illustrative purposes only and should be used as such by any prospective purchaser. The services, systems and appliances shown have not been tested and no guarantee as to their operability or efficiency can be given
Made with Metropix ©2020

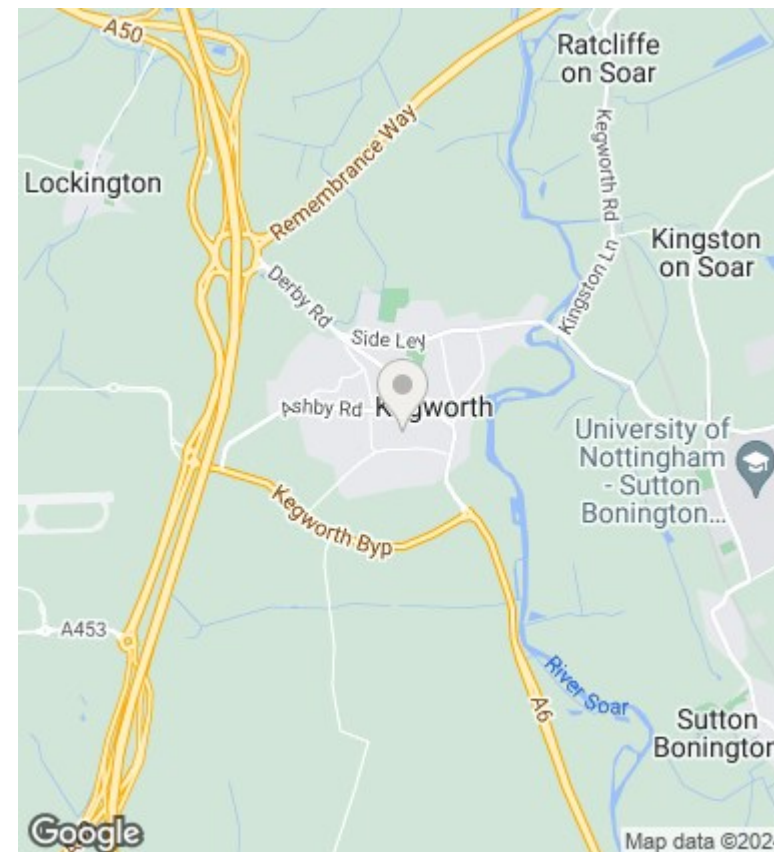

Directions

Viewings

Viewings by arrangement only. Call 01509 674140 to make an appointment.

Council Tax Band

A

EPC Rating:

Energy Efficiency Rating		Current	Potential
<i>Very energy efficient - lower running costs</i>			
(92 plus)	A		
(81-91)	B		
(69-80)	C		
(55-68)	D		
(39-54)	E		
(21-38)	F		
(1-20)	G		
<i>Not energy efficient - higher running costs</i>			
England & Wales		EU Directive 2002/91/EC	