



Melrose Gardens, KT3

£2,395 PCM

A charming mid-terrace three bedroom family home featuring a private rear garden and a fully fitted kitchen/diner within a great location in New Malden.



A charming mid-terrace three bedroom family home featuring a private rear garden and a fully fitted kitchen/diner within a great location in New Malden.

The property is situated 0.4 miles from New Malden Station and 0.8 miles from Berrylands station

- Three Bedrooms • Great Location • Private Rear Garden •
- Gas Central Heating • Double Glazing • Wood Floors •



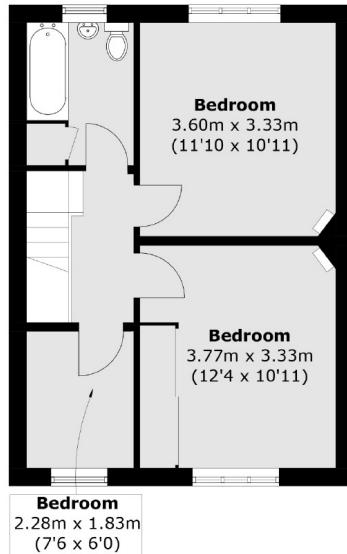

First Floor

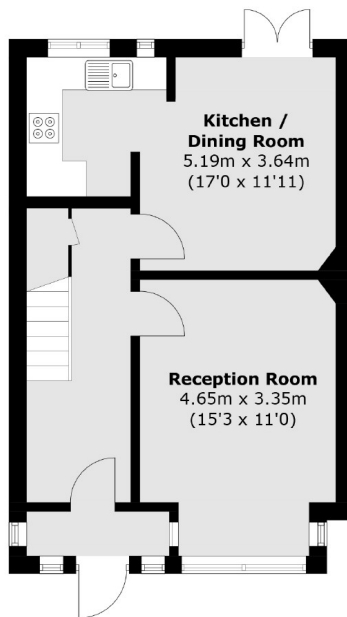

Ground Floor

Total area (approx.): 82.6 sq. m (889.1 sq. ft)

Snellers Kingston Lettings
17-21 Richmond Road
Kingston
KT2 5BW
020 8546 0505
kingstonlettings@snellers.co.uk

Energy Rating: C We aim to make our particulars both accurate and reliable. However they are not guaranteed; nor do they form part of an offer or contract. If you require clarification on any points then please contact us, especially if you're traveling some distance to view. Please note that appliances and heating systems have not been tested and therefore no warranties can be given as to their good working order