



Kingston Hill, KT2

£1,850 PCM

A remarkable two bedroom apartment, boasting ample living space perfect for couples, sharers, or a small family. Flooded with natural light, this property features a private parking space, private patio area and access to communal gardens.

Kingston Hill is only 0.2 miles from Norbiton Main Line Train Station and less than a mile to Kingston Town Centre and all the shops, bars and restaurants it has to offer

- Two Bedrooms • One Bathroom • Private Patio Area •
- Open Plan Kitchen • Allocated Parking • Central Location •

SNELLERS

ESTATE AGENTS

Ground Floor

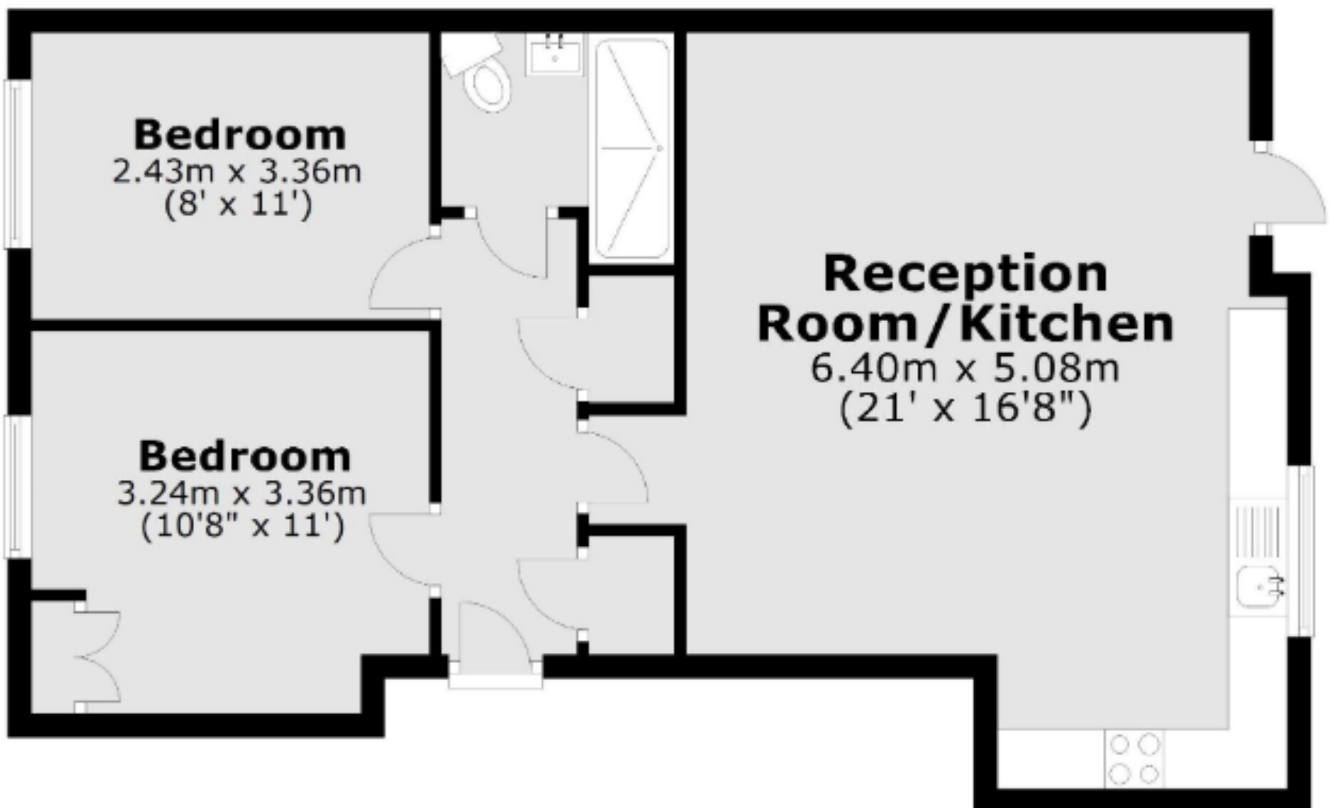

Total area: approx. 59.4 sq. metres (639.6 sq. feet)

Snellers Kingston Lettings
17-21 Richmond Road
Kingston
KT2 5BW
020 8546 0505
kingstonlettings@snellers.co.uk

Energy Rating: C We aim to make our particulars both accurate and reliable. However they are not guaranteed; nor do they form part of an offer or contract. If you require clarification on any points then please contact us, especially if you're traveling some distance to view. Please note that appliances and heating systems have not been tested and therefore no warranties can be given as to their good working order