

Glandwr Place

CARDIFF, CF14 1DP

£850 PER CALENDAR MONTH

**Hern &
Crabtree**



Glandwr Place

A well presented ground floor apartment situated within a small, well-maintained, and private development in the heart of Whitchurch Village. Just a short stroll from all the local shops via an access route making you a few meters stroll from Whitchurch village high street with lots of bars, cafes, and amenities.

The location is fantastic – with great access to the M4, Velindre Hospital, and everything Whitchurch has to offer.

The apartment offers a good size open-plan kitchen and living area, Bathroom, One double bedroom and a second room which would make an ideal study or dressing room. Externally there's off-road parking and lovely communal gardens to enjoy.

£850PCM. Available from January 2026. Council Band C. EPC rating C. Unfurnished.

A holding fee of £150 will be payable to secure the property. This will be deducted from the final balance of the first month rent payable upon moving into the property subject to a successful application. Hern & Crabtree Ltd reserves the right to retain this payment should the applicant have provided false or misleading information at the time of application.

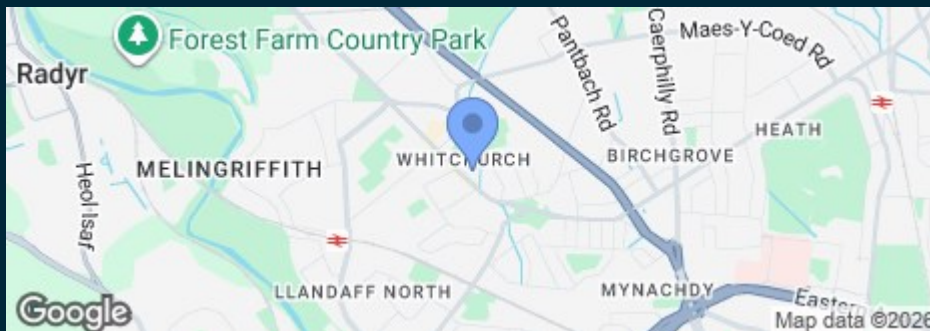



Good old-fashioned service with a modern way of thinking.

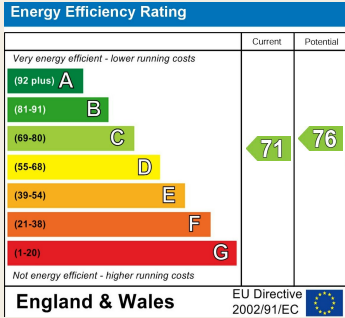

Approx Gross Internal Area
42 sq m / 449 sq ft

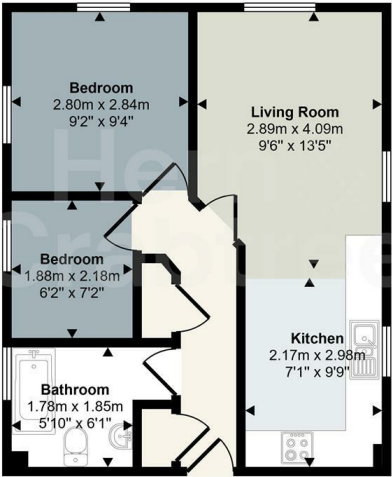

Floorplan

This floorplan is only for illustrative purposes and is not to scale. Measurements of rooms, doors, windows, and any items are approximate and no responsibility is taken for any error, omission or mis-statement. Icons of items such as bathroom suites are representations only and may not look like the real items. Made with Made Snappy 360.