



Taylors

Covers Lane, Prestwood, Stourbridge, South Staffordshire, DY7 5PB

Guide Price £265,000

🛏 2 🚿 1 🚿 1



Delightfully situated to form part of this now established and secluded development, this THOUGHTFULLY IMPROVED AND WELL ARRANGED, TWO-BEDROOM, SEMI-DETACHED BUNGALOW has a lovely outlook across an open green, ensuring privacy and added appeal.

For those aged 55 years and over, The Oval is a prime location in Prestwood, with the district of South Staffordshire in the county of Staffordshire, albeit readily accessible to the nearby road networks which serve access to the towns of Kidderminster, Kingswinford, Stourbridge and beyond.

The accommodation, which is planned over one level, includes a reception hall, a good-sized sitting room, a breakfast kitchen, a conservatory, two bedrooms, and a shower room. Double glazed and gas centrally heated.

The gardens are planned for low maintenance with a block paved driveway and patio rear aspect – ideally for garden pots and tubs, and for external dining when the weather allows. Overall, a pleasant environment to unwind.

Tenure: Freehold. Construction: Standard. Services: All mains. Broadband/ Mobile coverage: Visit: checker.ofcom.org.uk/en-gb/broadband-coverage. Council Tax Band B. EPC C

Reception Hall - 1.68m x 1.22m (5'6" x 4'0")

Sitting Room - 4.83m x 3.68m (15'10" x 12'1") At widest points

Breakfast Kitchen - 3.89m x 2.84m (12'9" x 9'4") At widest points

Conservatory - 3.18m x 3.05m (10'5" x 10'0") At widest points

Bedroom One - 4.22m x 3.28m (13'10" x 10'9")

Bedroom Two - 5.21m x 2.54m (17'1" x 8'4") At widest points

Shower Room - 1.96m x 1.7m (6'5" x 5'7")

Store Cupboard (from patio) - 2.79m x 1.47m (9'2" x 4'10")



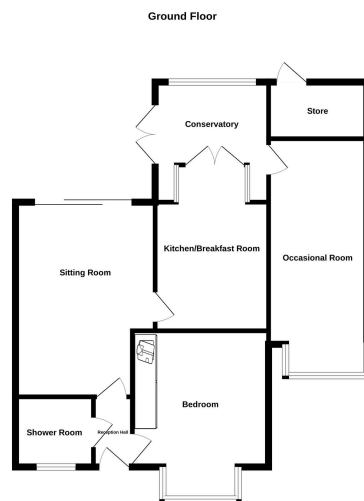

Measurements are approximate. Not for sale. Illustrative purposes only.
 Plans are for information only.

- NO UPWARD CHAIN
- LOVELY LOCATION
- THOUGHTFULLY IMPROVED
- CONSERVATORY
- BLOCK PAVED DRIVEWAY
- VERSATILE LAYOUT

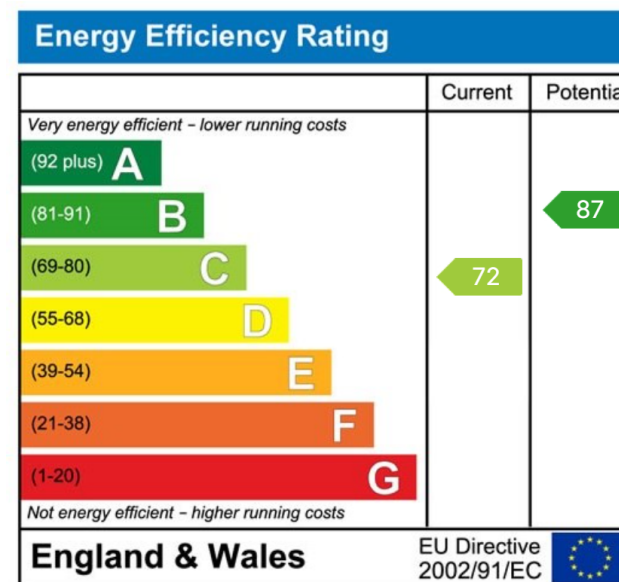

MISREPRESENTATION ACT 1967: These particulars do not constitute any part of an offer or a contract. Whilst every care is taken to ensure accuracy, no responsibility for errors or misdescription is accepted. Any intending purchaser must satisfy themselves by inspection or otherwise as to the correctness of each of the statements in these particulars. The vendor does not make nor give, and neither Taylors nor any person in their employment has any authority to make or give any representation or warranty whatsoever about this property. As the seller's estate agents, we are not surveyors or conveyancing experts, and we cannot comment on the property's condition or issues relating to the title or other legal issues that may affect this property unless we have been made aware of such matters. Interested parties should employ professionals to make such enquiries before making transactional decisions. **EPC:** can be supplied free of charge. **CONSUMER PROTECTION REGULATIONS (2008):** These particulars have been prepared with care and approved by the vendors (where possible) but are intended as a guide only, with measurements being approximate and usually the maximum size, which may include alcoves, recesses or otherwise as described, and you must NOT rely on them for any other purpose. The appearance of an item in any photograph does not mean that it forms part of the property or sale price. **FIXTURES AND FITTINGS:** Only those items specifically mentioned in these sales particulars are included in the sale price. Taylors have NOT tested any apparatus, equipment, fixture or fitting and cannot verify they are in working order or fit for their purpose. **PLANNING PERMISSION / BUILDING REGULATIONS:** Any reference to the property being extended, altered or converted in any way does not infer that planning permission or building regulations have been granted or applied for, nor do Taylors accept any responsibility for such not having been obtained. **FLOOR PLAN:** This plan is for illustrative purposes only. The services, systems and appliances shown have not been tested and no guarantee as to their operability or efficiency can be given.