



Taylors

Camellia Gardens, Glasshouse Apartments, Wordsley, Stourbridge, DY8 5TE

Guide Price £189,950

🛏 2 🚿 2 🚲 1



Enjoying an enviable ground-floor setting in this attractive development known as Glasshouse Apartments, this beautifully presented and thoughtfully arranged two-bedroom luxury home affords a layout with several features, but above all, favours an incredible rear view of the famous 'glass cone'.

With a security intercom providing initial access, the accommodation has a bright and airy vibe, with the central reception hallways having doors off to the Open Plan Sitting Room with patio doors and garden view, a Well Fitted Kitchen, a Principal Bedroom with EN SUITE, a Further Bedroom and an Impressive Bathroom.

Externally, there is an allocated drive parking space, designated visitor parking, and communal gardens which are landscaped and add to the overall appeal of the development. This particular flat also has its own defined patio area, which leads from the Sitting Room, and has what may be considered the best aspect.

Glasshouse Apartments is well placed for the nearby towns of Kingswinford, Stourbridge and Brierley Hill/Merry Hill and nearby canal walks.

Tenure: Leasehold. Approximately 100 years remaining. Service charge £1,908 per annum. Ground Rent £100 per annum. Construction: Purpose built.

Services: All mains. Broadband/Mobile coverage: Visit: checker.ofcom.org.uk/en-gb/broadband-coverage. Council Tax Band C. EPC C.

Reception Hall

Sitting Room Area - 4.75m x 3.38m (15'7" x 11'1")

Kitchen - 3.38m x 2.13m (11'1" x 7'0")

Bedroom One - 3.91m x 2.87m (12'10" x 9'5")

Ensuite - 2.18m x 1.4m (7'2" x 4'7")

Bedroom Two - 3.25m x 2.29m (10'8" x 7'6")

Bathroom - 2.34m x 1.7m (7'8" x 5'7")





- ALLOCATED DRIVE PARKING SPACE
- BEDROOM ONE WITH ENSUITE
- SITTING ROOM WITH FRENCH DOORS TO EXTERNAL PATIO
- LOVELY VIEWS TO THE FAMOUS GLASS CONE
- BEAUTIFULLY PRESENTED THROUGHOUT
- A STUNNING DEVELOPMENT IN A CONVENIENT LOCATION

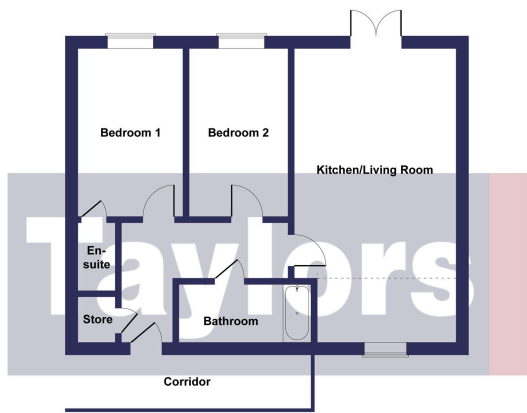

FOR GUIDE PURPOSES ONLY:
Whilst every attempt has been made to ensure the accuracy of the floor plan contained here, measurements of doors, windows, rooms and any other items are approximate and no responsibility is taken for any error, omission, or mis-statement. This plan is for illustrative purposes only and should be used as such by any prospective purchaser. The services, systems and appliances shown have not been tested and no guarantee as to their operability or efficiency can be given. This floor plan is provided strictly for the purpose of providing a guide and is not intended to be sufficiently accurate for any purpose. Taylors Estate Agents do not accept any responsibility for errors or misuse. Prospective buyers must always seek their own verification of a layout, or seek the advice of their own professional advisors (surveyor or solicitor).

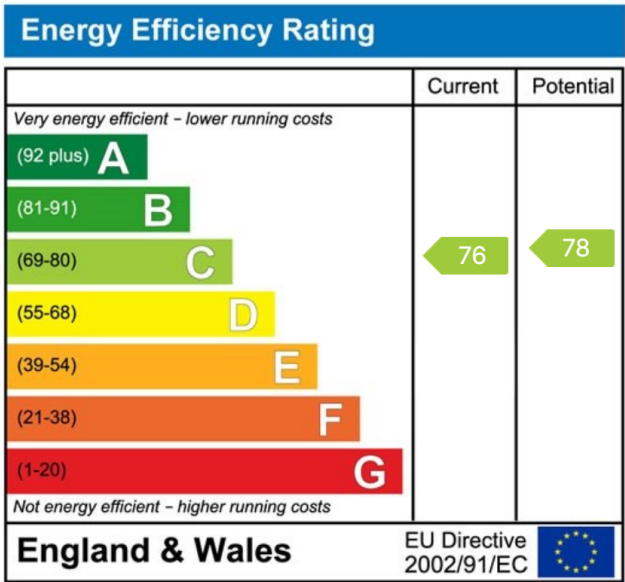

MISREPRESENTATION ACT 1967: These particulars do not constitute any part of an offer or a contract. Whilst every care is taken to ensure accuracy, no responsibility for errors or misdescription is accepted. Any intending purchaser must satisfy themselves by inspection or otherwise as to the correctness of each of the statements in these particulars. The vendor does not make nor give, and neither Taylors nor any person in their employment has any authority to make or give any representation or warranty whatsoever about this property. As the seller's estate agents, we are not surveyors or conveyancing experts, and we cannot comment on the property's condition or issues relating to the title or other legal issues that may affect this property unless we have been made aware of such matters. Interested parties should employ professionals to make such enquiries before making transactional decisions. **EPC:** can be supplied free of charge. **CONSUMER PROTECTION REGULATIONS (2008):** These particulars have been prepared with care and approved by the vendors (where possible) but are intended as a guide only, with measurements being approximate and usually the maximum size, which may include alcoves, recesses or otherwise as described, and you must NOT rely on them for any other purpose. The appearance of an item in any photograph does not mean that it forms part of the property or sale price. **FIXTURES AND FITTINGS:** Only those items specifically mentioned in these sales particulars are included in the sale price. Taylors have NOT tested any apparatus, equipment, fixture or fitting and cannot verify they are in working order or fit for their purpose. **PLANNING PERMISSION / BUILDING REGULATIONS:** Any reference to the property being extended, altered or converted in any way does not infer that planning permission or building regulations have been granted or applied for, nor do Taylors accept any responsibility for such not having been obtained. **FLOOR PLAN:** This plan is for illustrative purposes only. The services, systems and appliances shown have not been tested and no guarantee as to their operability or efficiency can be given.