

Floorplan

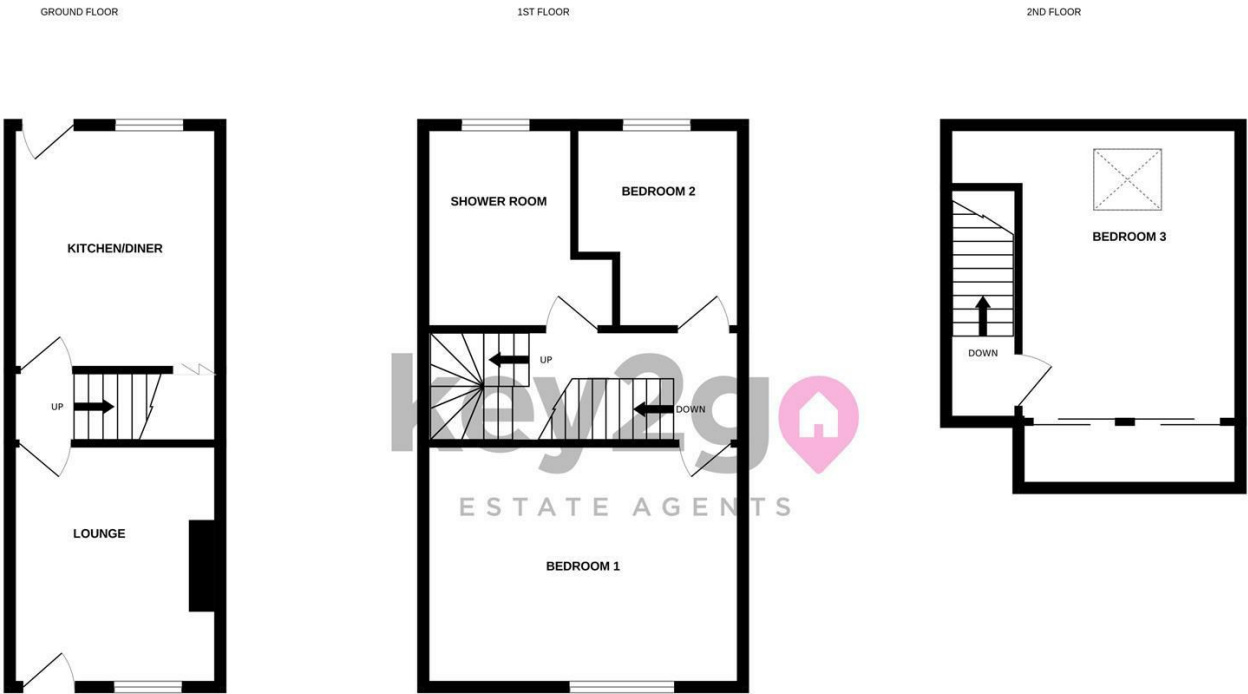

Whilst every attempt has been made to ensure the accuracy of the floorplan contained here, measurements of doors, windows, rooms and any other items are approximate and no responsibility is taken for any error, omission or mis-statement. This plan is for illustrative purposes only and should be used as such by any prospective purchaser. The services, systems and appliances shown have not been tested and no guarantee as to their operability or efficiency can be given.
Made with Metropix ©2024

Area Map



Energy Efficiency Graph

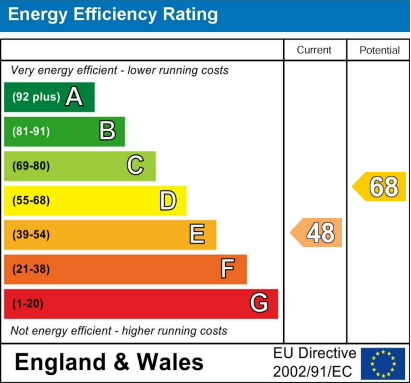

Viewing

Please contact our Lettings Team Office on 0114 2478819 if you wish to arrange a viewing appointment for this property or require further information.



147 Queens Road
Beighton, Sheffield, S20 1DU

£950 PCM

3 1 0 E



147 Queens Road

Beighton, Sheffield, S20 1DU

£950 PCM



Available to rent is this stylish, three bedroomed terrace house located in the ever popular village of Beighton. Having off road parking and a good sized enclosed garden. Benefiting from a stylish kitchen and bathroom. Close to a choice of local amenities including Crystal Peak Shopping Centre and Drakehouse Retail Park. Ideal for a small family or couple!

