

Floorplan

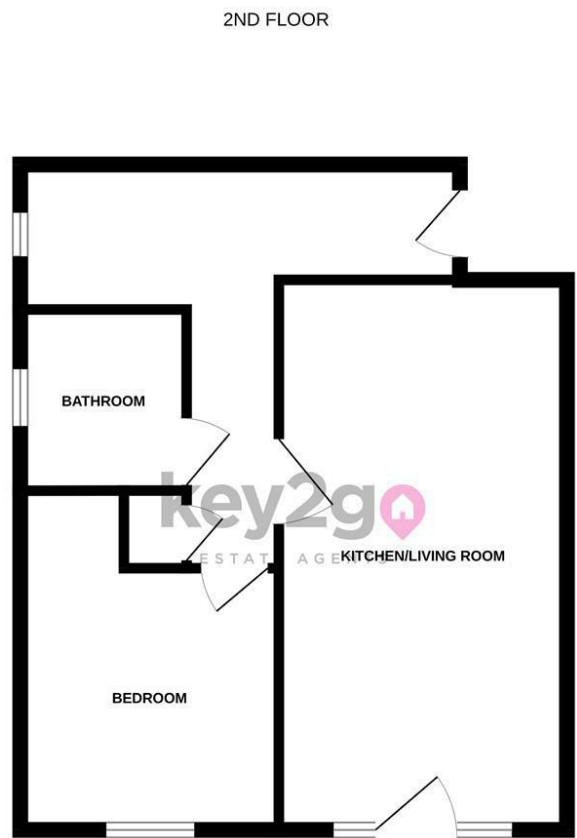

While every attempt has been made to ensure the accuracy of the floorplan contained here, measurements of doors, windows, rooms and any other items are approximate and no responsibility is taken for any error, omission or misstatement. This plan is for illustrative purposes only and should be used as such by any prospective purchaser. The services, systems and appliances shown have not been tested and no guarantee as to their operability or efficiency can be given.
Made with Metropix 12025

Area Map

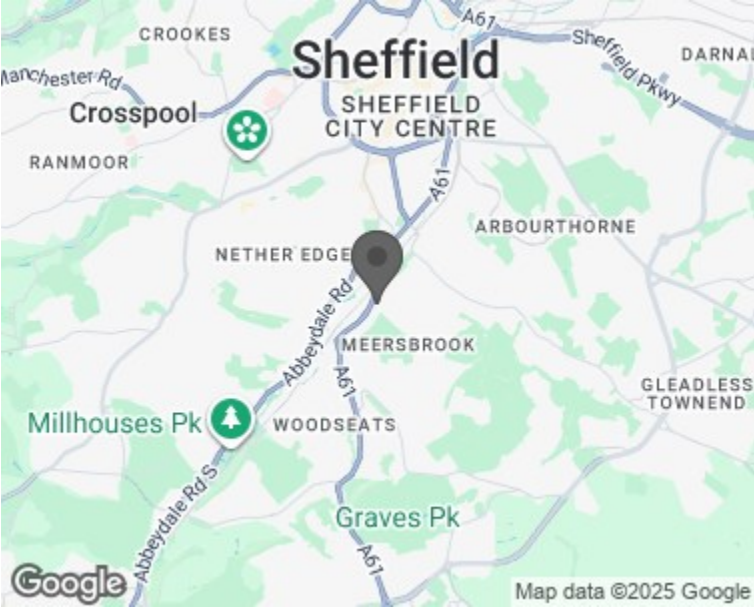

Energy Efficiency Graph

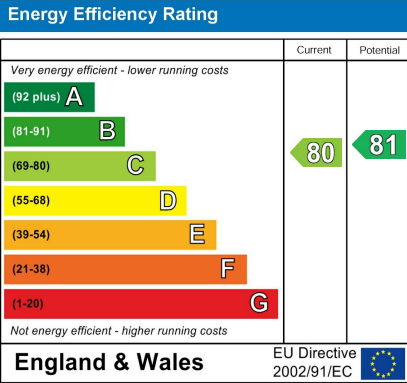

Viewing

Please contact our Lettings Team Office on 0114 2478819 if you wish to arrange a viewing appointment for this property or require further information.



27 Victoria Park 4 Valley Road
Sheffield, S8 9FY

£800 PCM



27 Victoria Park 4 Valley Road

Sheffield, S8 9FY

£800 PCM



A fantastic opportunity to rent this modern and spacious one double bedroomed top floor flat. This property has gas central heating, secure allocated parking for one car and has gated access to Meersbrook Park. Situated in a highly sought after area with great bus routes including a bus link to Hallamshire Hospital. Ideal for a single person!

SUMMARY

A fantastic opportunity to rent this modern and spacious one double bedroomed top floor flat. This property has gas central heating, secure allocated parking for one car and has gated access to Meersbrook Park. Situated in a highly sought after area with great bus routes including a bus link to Hallamshire Hospital. Ideal for a single person!

