

Floorplan

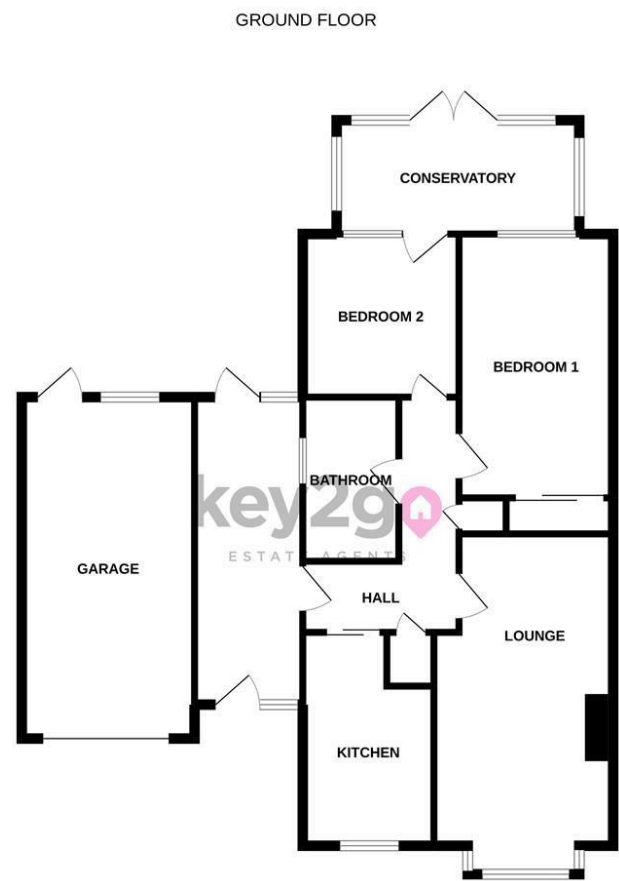

Whilst every attempt has been made to ensure the accuracy of the floorplans contained here, measurements of doors, windows, rooms and any other items are approximate and no responsibility is taken for any error, omission or mis-statement. This plan is for illustrative purposes only and should be used as such by any prospective purchaser. The services, systems and appliances shown have not been tested and no guarantee is made as to their operability or efficiency can be given.  
Made with Metropix ©2022

Area Map



Energy Efficiency Graph

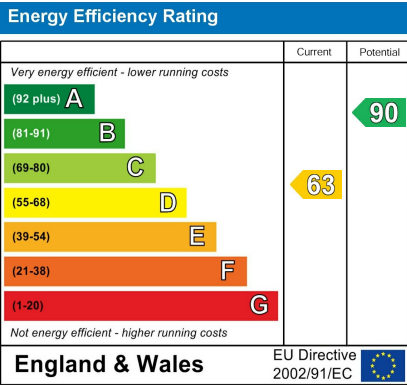

Viewing

Please contact our Lettings Team Office on 0114 2478819 if you wish to arrange a viewing appointment for this property or require further information.

These particulars, whilst believed to be accurate are set out as a general outline only for guidance and do not constitute any part of an offer or contract. Intending purchasers should not rely on them as statements of representation of fact, but must satisfy themselves by inspection or otherwise as to their accuracy. No person in this firms employment has the authority to make or give any representation or warranty in respect of the property.



12 Redbrook Croft  
Owlthorpe, Sheffield, S20 6RQ

£1,050 PCM





## 12 Redbrook Croft

Owlthorpe, Sheffield, S20 6RQ

£1,050 PCM



A fantastic and unique opportunity to rent this two bedroomed detached bungalow which is tucked away in a quiet cul-de-sac and boasts fantastic views from the rear garden. On the doorstep to fantastic local amenities and public transport links. Having off road parking, a garage and a stylish newly fitted kitchen! Call our rental team today to arrange your viewing!

