

## Floorplan

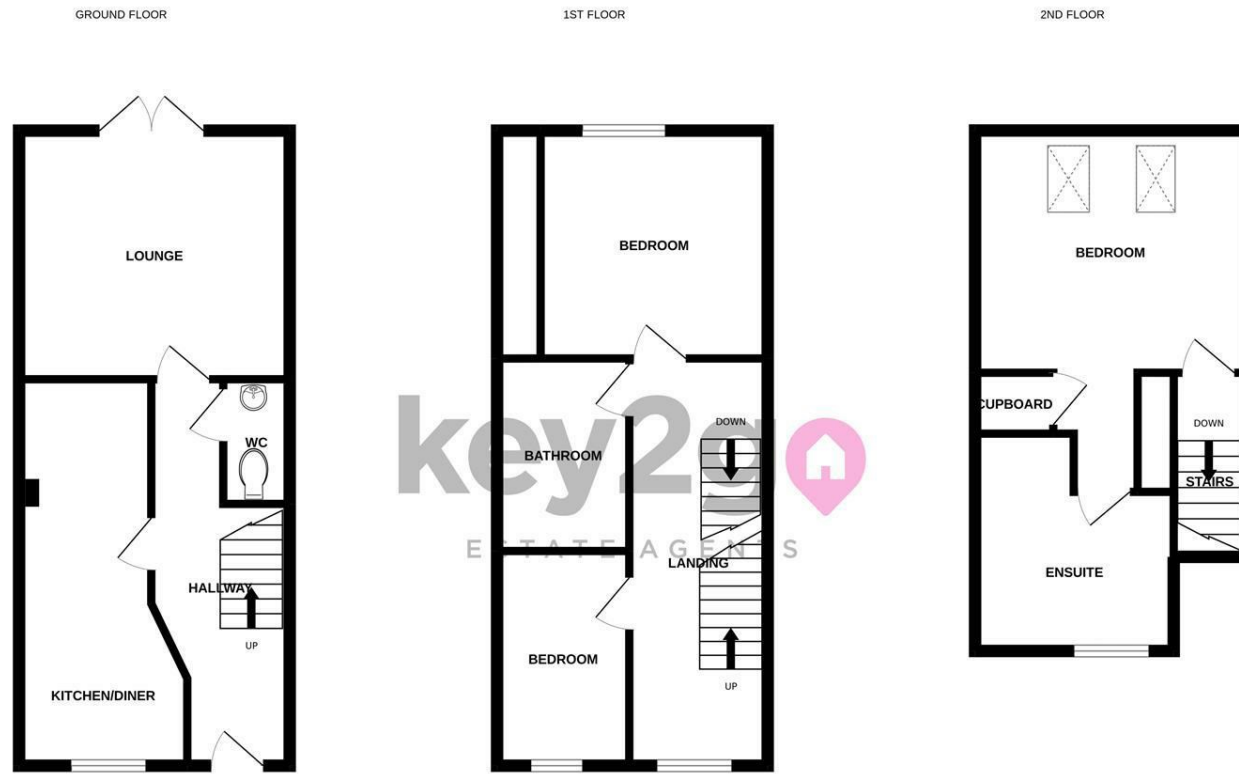

Whilst every attempt has been made to ensure the accuracy of the floorplan contained here, measurements of doors, windows, rooms and any other items are approximate and no responsibility is taken for any error, omission or mis-statement. This plan is for illustrative purposes only and should be used as such by any prospective purchaser. The services, systems and appliances shown have not been tested and no guarantee as to their operability or efficiency can be given.  
Made with Metropix ©2022.



## Area Map

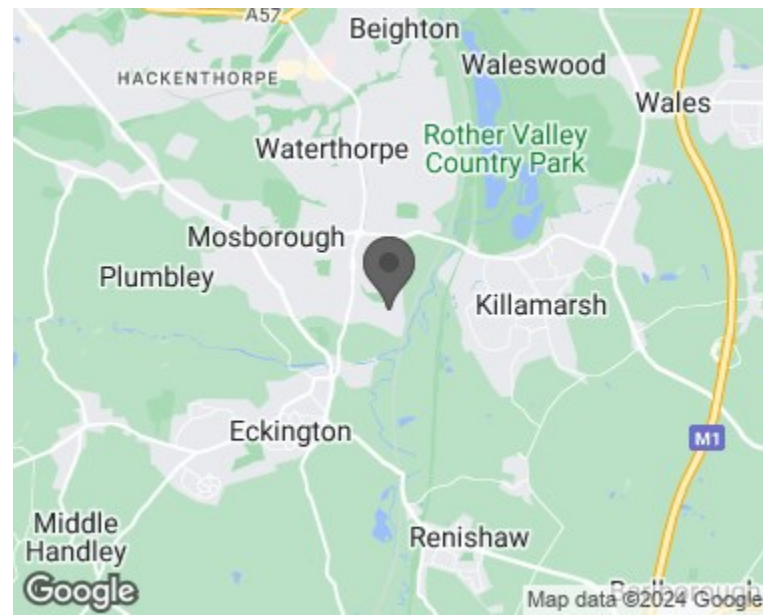

## Energy Efficiency Graph

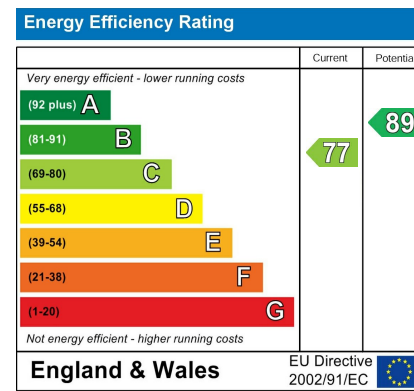

## Viewing

Please contact our Lettings Team Office on 0114 2478819 if you wish to arrange a viewing appointment for this property or require further information.

6 Deepwell Mews  
Halfway, Sheffield, S20 4SJ

£1,200 PCM



These particulars, whilst believed to be accurate are set out as a general outline only for guidance and do not constitute any part of an offer or contract. Intending purchasers should not rely on them as statements of representation of fact, but must satisfy themselves by inspection or otherwise as to their accuracy. No person in this firm's employment has the authority to make or give any representation or warranty in respect of the property.



# 6 Deepwell Mews

Halfway, Sheffield, S20 4SJ

£1,200 PCM



THE PERFECT FAMILY HOME! A unique opportunity to rent this three bedroomed, three storey town house! Having three WCs including a master bedroom with en-suite. Modern decor, ample off road parking and an enclosed garden. Overlooks quiet park land and tucked away in a private cul-de-sac. Call our rental team today to arrange your viewing!

## SUMMARY

THE PERFECT FAMILY HOME! A unique opportunity to rent this three bedroomed, three storey town house! Having three WCs including a master bedroom with en-suite. Modern decor, ample off road parking and an enclosed garden. Overlooks quiet park land and tucked away in a private cul-de-sac. Call our rental team today to arrange your viewing!

