

Floorplan

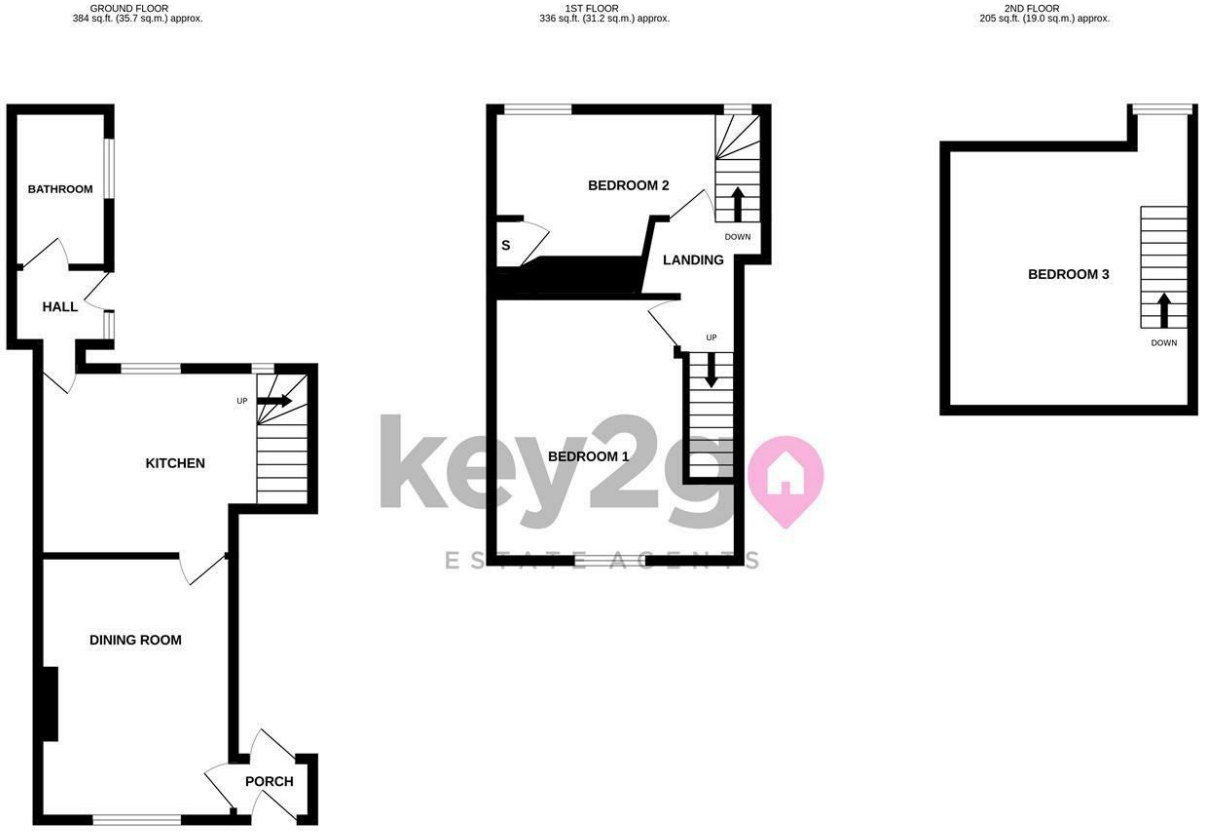

TOTAL FLOOR AREA : 925 sq.ft. (85.9 sq.m.) approx.
 Whilst every attempt has been made to ensure the accuracy of the floorplan contained here, measurements of doors, windows, rooms and any other items are approximate and no responsibility is taken for any error, omission or mis-statement. This plan is for illustrative purposes only and should be used as such by any prospective purchaser. The services, systems and appliances shown have not been tested and no guarantee as to their operability or efficiency can be given.
 Made with Metropix ©2024



Area Map

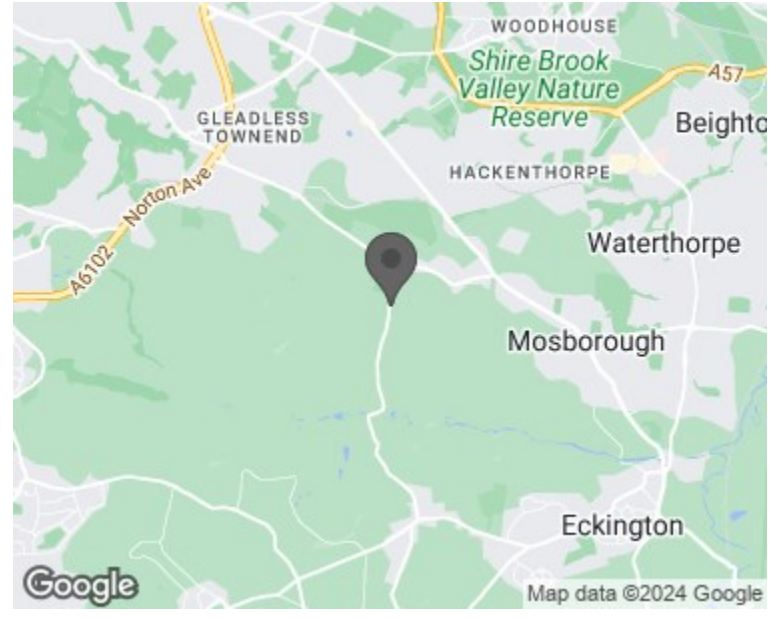

Energy Efficiency Graph

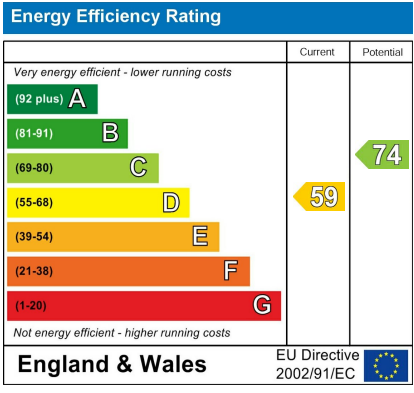

Viewing

Please contact our Lettings Team Office on 0114 2478819 if you wish to arrange a viewing appointment for this property or require further information.

46A Main Road
Ridgeway, Sheffield, S12 3XR

£1,000 PCM



These particulars, whilst believed to be accurate are set out as a general outline only for guidance and do not constitute any part of an offer or contract. Intending purchasers should not rely on them as statements of representation of fact, but must satisfy themselves by inspection or otherwise as to their accuracy. No person in this firm's employment has the authority to make or give any representation or warranty in respect of the property.



46A Main Road

Ridgeway, Sheffield, S12 3XR

£1,000 PCM



A fantastic and unique opportunity to rent this deceptively spacious, three double bed roomed cottage with accommodation over three floors. Located in the sought after village of Ridgeway which is surrounded by quiet countryside! With fantastic road links to Sheffield and Chesterfield! Having a shared driveway and extensive garden with one other property!

