



TRACY PHILLIPS

Estates



TRACY PHILLIPS

Estates

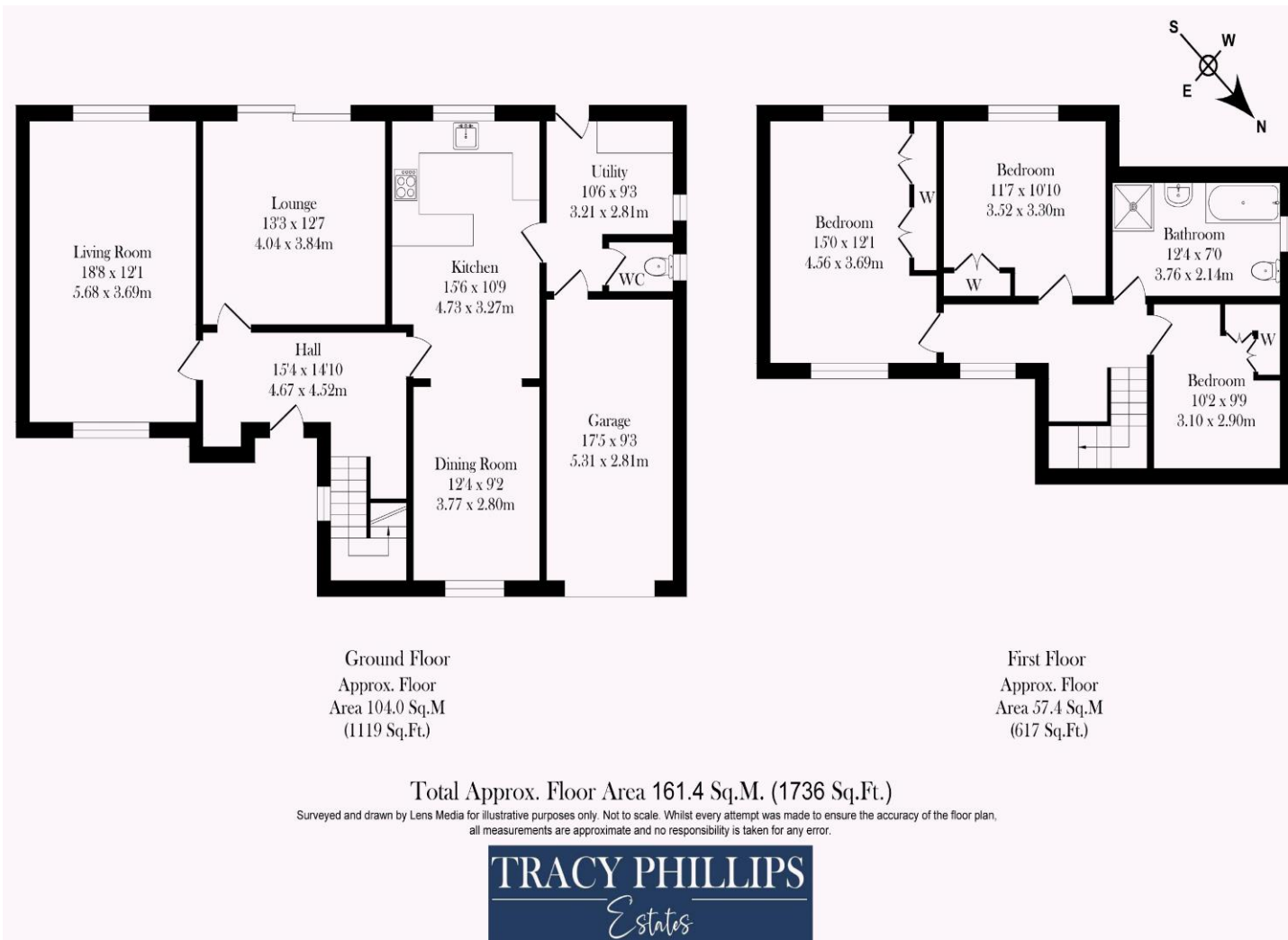

Score	Energy rating	Current	Potential
92+	A		
81-91	B		
69-80	C		
55-68	D	61 D	78 C
39-54	E		
21-38	F		
1-20	G		



01257 422228

enquiries@tracyphillipsestates.com

tracyphillipsestates.com

Asking Price: £570,000

Mossy Lea Road, Wrightington

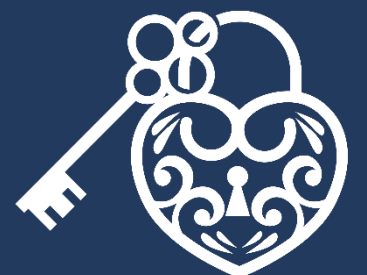

Every care has been taken with the preparation of this Sales Brochure but it is for general guidance only and complete accuracy cannot be guaranteed. If there is any point, which is of particular importance professional verification should be sought. This Sales Brochure does not constitute a contract or part of a contract. We are not qualified to verify tenure of property. Prospective purchasers should seek clarification from their solicitor or verify the tenure of this property for themselves by visiting www.landregisteronline.gov.uk. The mention of any appliances, fixtures or fittings does not imply they are in working order. Photographs are reproduced for general information and it cannot be inferred that any item shown is included in the sale. All dimensions are approximate.

Offered with no onward chain, this spacious and charming home boasts generous living spaces, a large front garden and ample parking for several cars on the driveway.

The large entrance hallway welcomes you into the home, setting the tone for its spacious layout. The dual-aspect lounge features a gas fire and offers a light, airy living space for relaxation. To the rear, a cosy morning room provides lovely views of the garden and also includes a gas fire, perfect for unwinding. The kitchen is expansive, flowing into a dining room at the front, making it ideal for family meals and entertaining. A utility room to the side offers additional practicality with a Belfast sink, quarry-tiled flooring, and a door leading to the rear garden. There is also a separate toilet and convenient access to the garage. Upstairs, the master bedroom sits above the lounge and benefits from dual-aspect windows, filling the room with natural light. A second double bedroom with fitted wardrobes overlooks the rear garden and offers beautiful views of the surrounding fields. The third double bedroom is situated at the front of the property, providing ample space for storage and comfort. The bathroom is fitted with a bath, shower cubicle, WC, and pedestal wash hand basin.

The substantial rear garden is a standout feature, with a well-maintained lawn, beautiful flower borders, and serene views overlooking open fields, creating a peaceful outdoor retreat. The large front garden is also lawned, with well-established flower beds, adding to the property's curb appeal.

This property offers excellent potential for those seeking a spacious family home in a desirable location, with the added benefit of no onward chain.





