



TRACY PHILLIPS

Estates



TRACY PHILLIPS

Estates

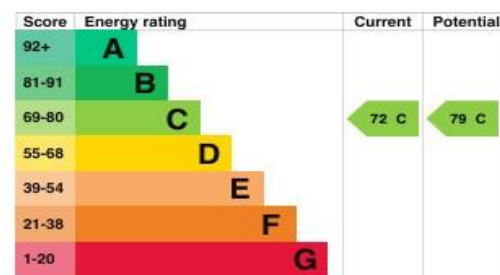
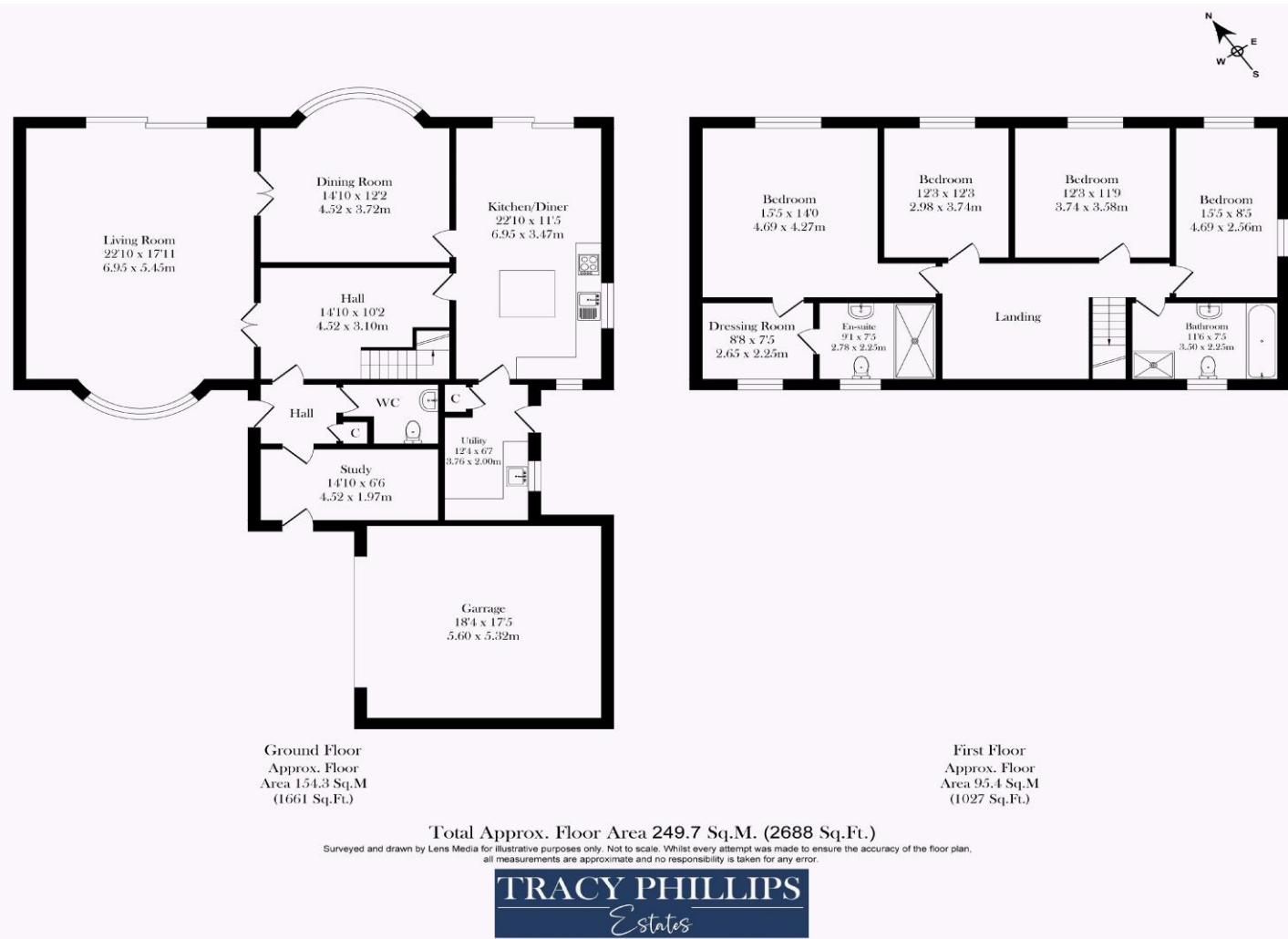

01257 422228

enquiries@tracyphillipsestates.com

tracyphillipsestates.com

Asking Price: £600,000

Hall Lane, Aspull

Every care has been taken with the preparation of this Sales Brochure but it is for general guidance only and complete accuracy cannot be guaranteed. If there is any point, which is of particular importance professional verification should be sought. This Sales Brochure does not constitute a contract or part of a contract. We are not qualified to verify tenure of property. Prospective purchasers should seek clarification from their solicitor or verify the tenure of this property for themselves by visiting www.landregisteronline.gov.uk. The mention of any appliances, fixtures or fittings does not imply they are in working order. Photographs are reproduced for general information and it cannot be inferred that any item shown is included in the sale. All dimensions are approximate.

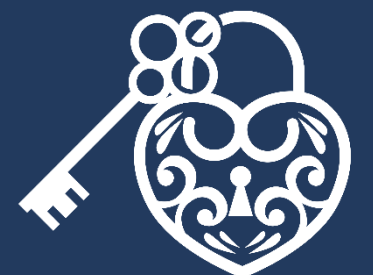

Bradfield is an individually built home of character offering an exceptionally generous 2688 sq ft of accommodation. Not only is the property positioned in one of Aspull's most sought-after locations, when built it was finished to an exceptional standard throughout and has the advantage of being surrounded by open fields and views and light filled spacious rooms. The owner of this property loved it so much when he built it that he decided to keep it as his own home and it has been a much loved family home ever since and it is with a heavy heart that they have made their decision to hand over this beautiful home to new owners. Beautifully cared for, over their ownership, this gem is a rare find.

The accommodation briefly comprises an impressive entrance hallway featuring an elegant staircase which leads to an open plan galleried landing. Double doors provide a welcoming entrance into the stunning lounge. Extending to an impressive 22'10 and featuring windows to both the front and sliding doors to the rear of the property this room is flooded with natural light. An impressive fireplace is the focal point and special touches including cornice and wall features adorn this room with character. Double doors then lead to the dining room which also leads to the kitchen making this space perfect for entertaining, and a beautiful barrelled bay window and herringbone parquet floor. The kitchen features large picture windows, space for informal dining, and sliding doors to the garden, The kitchen includes a Rangemaster freestanding cooker, central island with overhead canopy, integrated dishwasher, plate rack and fridge/ freezer. A further and good-sized utility room houses the laundry equipment. The ground floor is completed with a separate study and cloakroom.

Rising to the first floor of Bradfield, the galleried landing leads to four excellent bedrooms with the master being the showpiece, featuring it's own dressing room and en suite shower room including a large walk in double shower. The three further bedrooms are all filled with natural light and a spacious family bathroom services these rooms. The bathroom is completed with four-piece fully tiled suite.

Externally, this home keeps offering further delights. Aside from the panoramic views, there is an attached double garage, large tarmac driveway with turning space and double wrought iron gates lead down the side of the home. The rear and side gardens provide ideal outdoor spaces for tending beautiful gardens complete with lawns and dining spaces, perfect for family gatherings, yet also an equally delightful place in which to enjoy views over the fields and views over fields.

Equi distance between Aspull and Hindley, both offering a great range of shops and facilities, it is also worth noting that the Hindley Hall golf club is a stone's throw away and the property is perfectly placed for any commuter with its easy access to Hindley train station and the M61 motorway.

Bradfield is a beautiful home and we are ready to welcome viewers.





